



NAVADHA



PRODUCT CATALOGUE 2019 - 2020

B-4 Tardeo AC Mkt, Tardeo
Mumbai 400034. INDIA

PHONE: +91 22 2351 3365, 2351 3310
EMAIL: navadha9@gmail.com
EMAIL: contactus@navadha.com
WEBSITE: www.navadha.com

made in india

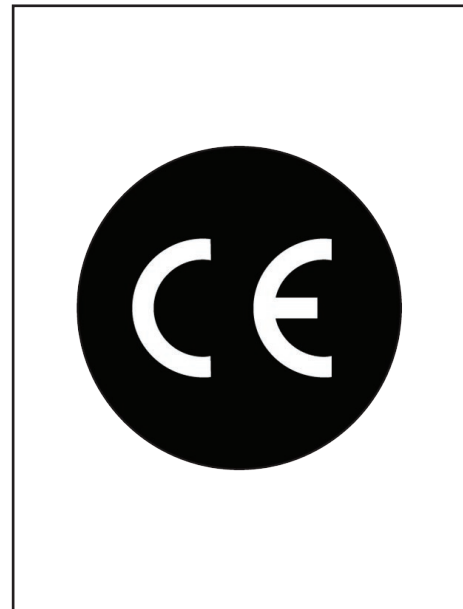
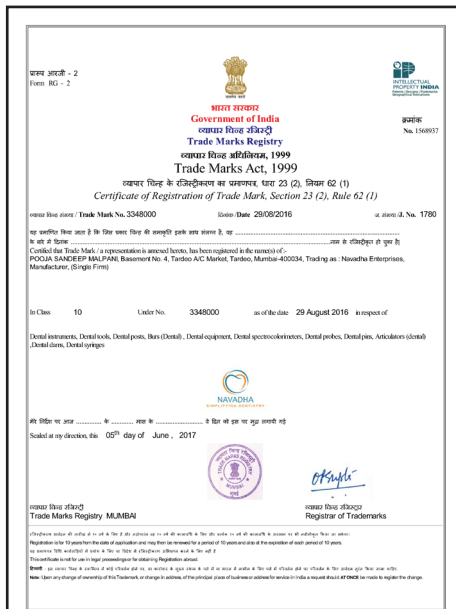

Catalogue Icons Details :



AUTOCLAVABLE



SCREW RETAINED



MAGNETIC OPTION



CHANGEABLE GUMS



INTEGRATED SIMULATOR

SKU : SIM10

Fully Integrated dental simulation unit, requires Zero floor Piping, and Instant installation. Includes Silent Oil Free Compressor, Fast Hand piece, Slow Hand Piece, Low Suction, Air-Water Syringe, air actuated foot pedal, LED Dental examination Light adjustable from 8,000 ~ 25,000 lux, Wheel fittings that make the unit Mobile or Stationary, Phantomhead with unbreakable high impact Polymer Torso, Stainless Steel & Aluminium non-rusting Phantom parts, Facility to recline / adjust height / angle of the Torso, Soft Gums Typodont Jaw Set, Universal Articulator that fits all type of Jaws, three storage drawer facility, Optional facility to install Monitor and Camera for Live relay and recording training sessions.

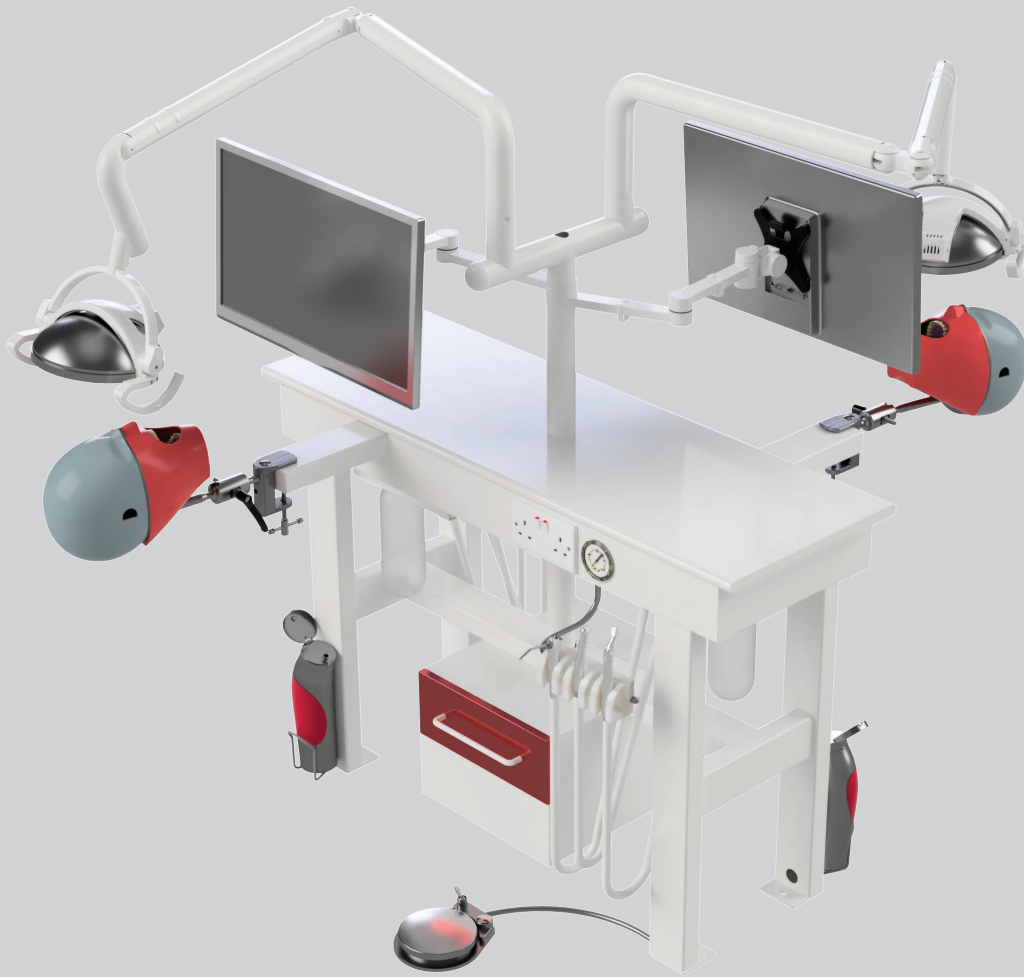

DUAL BENCH DENTAL SIMULATOR

SKU : SIM20

Space saving double sided phantom head table. Made from 2mm thick metal Frame, PU coated to prevent corrosion, flame resistant & low environmental impact. MDF Table Top covered with post formed durable laminate, easy to maintain, & is moisture, fungus, scratch & dent resistant. Includes for each user independent Phantomhead with non-rusting Stainless Steel & Aluminium parts, facility to recline / adjust height / angulation of the Head. Soft Gums Typodont Jaw Set, Fletcher mask with water draining facility, Universal Articulator that fits all types of Jaws, and storage drawer facility. Delivery unit with Fast & Slow Hand-piece coupling, Air-Water Syringe, actuating Foot Pedal, Bottles for Fresh & waste waters, LED Dental examination Light adjustable from 8,000 ~ 25,000 lux. Optional facility to mount Display Monitors & camera to record training / practice sessions. Instant & simple installation.

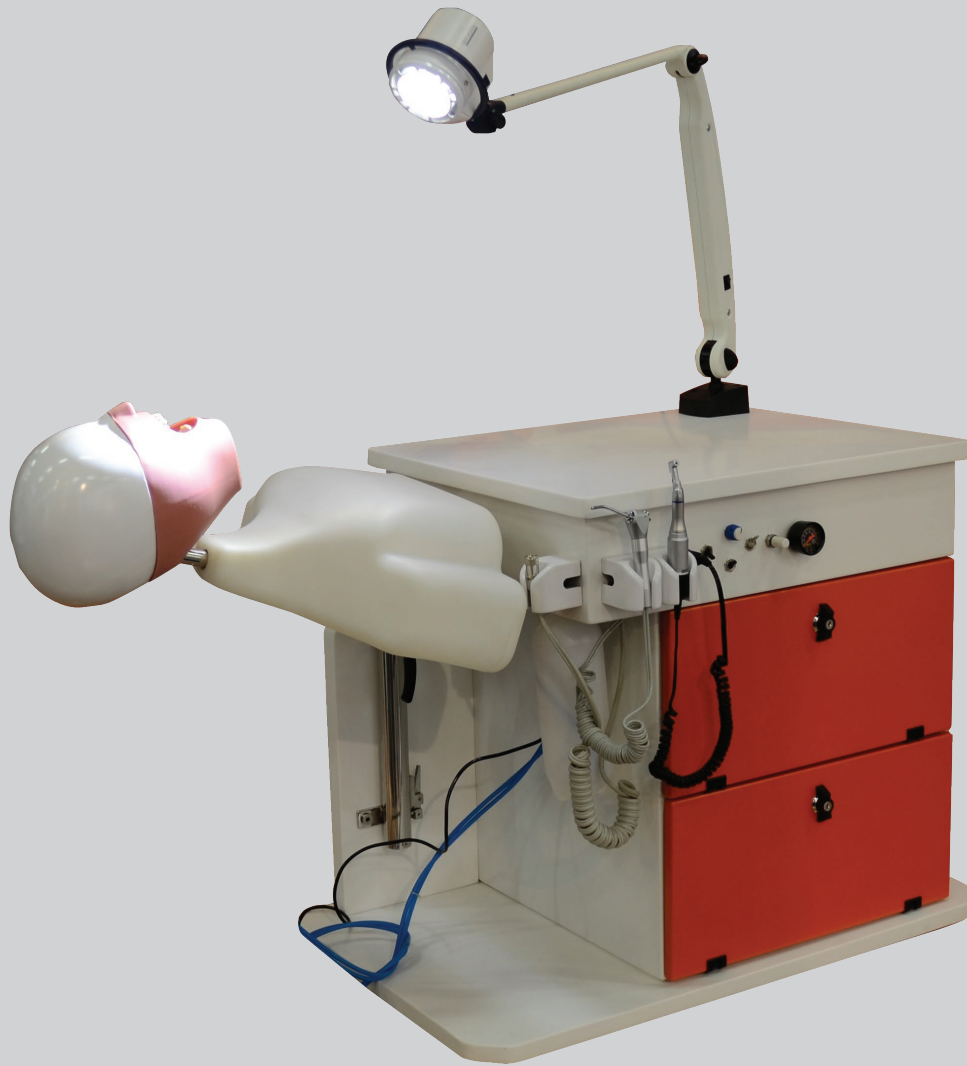

SIMDEC DENTAL SIMULATOR

SKU : SIM30

Stackable phantom head simulation unit. PU flame resistant & low environmental impact coating prevents corrosion. Highly durable non-porous easy to maintain Solid surface top and bottom; resistant to chemicals, moisture, fungus, scratch & dents. Consists of Phantomhead with unbreakable high impact Polymer Torso, Stainless Steel & Aluminium non-rusting parts, facility to recline / adjust height / angulation of the Torso & Head. Soft Gums Typodont Jaw Set, Fletcher mask with water draining facility, Universal Articulator that fits all types of Jaws, and two storage drawer with locks. Delivery unit with Fast & Slow Hand piece coupling, Air-Water Syringe, Foot Pedal, Bottles for Fresh & waste waters, LED Dental examination Light. Simple installation.



DUAL TORSO BENCH SIMULATOR

SKU : SIM40

Space saving double side phantom head table. Made from 2mm thick metal Frame, PU coated to prevent corrosion, flame resistant & low environmental impact. MDF Table Top covered with post formed durable laminate, easy to maintain, & is moisture, fungus, scratch & dent resistant. Includes for each user Phantomhead with unbreakable high impact Polymer Torso, Stainless Steel & Aluminum non-rusting parts, facility to recline / adjust height / angulation of the Torso & Head. Soft Gums Typodont Jaw Set, Fletcher mask with water draining facility, Universal Articulator that fits all types of Jaws, and storage drawer facility. Delivery unit with Fast & Slow Handpiece coupling, Air-Water Syringe, Foot Pedal, Bottles for Fresh & waste waters, LED Dental examination Light adjustable from 8,000 ~ 25,000 lux. Optional Display Monitors. Instant & simple installation.



DUAL SIMULATOR

SKU : SIM70

Dual simulator with stable wide strong base allows better space utilisation, in an integrated practice lab, that allows easier monitoring by dental instructors, in a professional clinical setting. Made from 3mm thick metal pillar Frame, flame resistant PU coating prevents corrosion. Includes for each user Phantomhead with unbreakable high impact Polymer Torso, Stainless Steel & Aluminum non-rusting parts, facility to recline / adjust height / angulation of the Torso & Head. Soft Gums Typodont Jaw Set, Fletcher mask with water draining facility, Universal Articulator that fits all types of Jaws, and storage drawer facility. Delivery unit with Fast & Slow Hand piece coupling, Air-Water Syringe, actuating Foot Pedal, Bottles for Fresh & waste waters, LED Dental examination Light adjustable from 8,000 ~ 25,000 lux.



LABORATORY WORK BENCH SIMULATOR

SKU : SIM80

Provides an economically efficient solution for dental schools and training centers. Dental Laboratory Technician workstation-cum-Dentist training simulation workbench, for better space & resources utilisation. PU flame resistant & low environmental impact coating prevents corrosion. Highly durable non-porous resistant to chemicals, moisture, fungus, scratch & dents easy to maintain Solid surface top. Double filter vacuum system (carbon filter and dust bag), Retractable air gun, individual gas faucets, 1200 W, 17000 rpm vacuum motor, 6 level speed control switch. Phantom head can be stowed under the bench easily, with all ergonomic head movements. Delivery arm with Fast & Slow Handpiece coupling, Air-Water Syringe, Foot Pedal, Bottles for Fresh & waste waters, LED Dental examination Light adjustable from 8,000 ~ 25,000 lux.



BENCH SIMULATOR WITH DELIVERY UNIT

SKU : SIM90

Simulator with Table facility. Includes Complete Phantomhead with Torso. Delivery unit with Fast Handpiece coupling, Air-Water Syringe, Micro-motor connection (optional), Examination Light, Phantomhead with unbreakable Polymer full Torso, Stainless Steel & Aluminum non-rusting phantom simulator parts, Facility to recline / adjust height / angulation of the Torso, Soft Gums Typodont Jaw Set, Universal Articulator that fits all type of Jaws, storage drawer facility, instant simple installation, Optional facility to install Monitor and Camera for Live relay and recording training sessions.

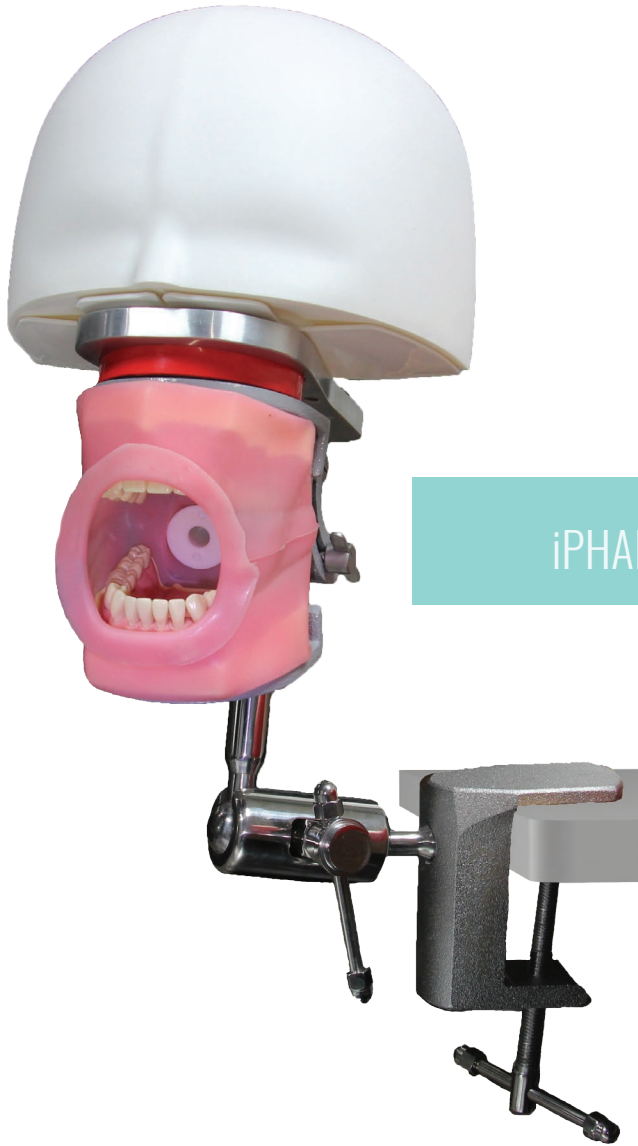

iPHANTOM HEAD BENCH MOUNT

SKU : NA001

iPhantom Bench Mount Assembly ideal solution for users looking for an inexpensive solution without comprising on the functionality and quality. Ideal for Training & Personal Practice time for students and practitioners alike. Precision engineered parts made from Stainless Steel and engineering grade Aluminum, ensure no corrosion, and swift movement.

Consists of Half Dome Skull, Half face Fletcher, Fixed mouth opening Articulator, Typodont Jaw with 32 Teeth & Soft Gums, and the Bench Mounting Assembly. It can be used into all necessary working positions and Jaws Table mounting allows working in 9 to 12 o'clock position. Can be mounted on up to 6 cm thick table top.

Typodont Teeth are retained with screws and can be changed easily. Jaws are held by the screws in knobs and can be easily accessed in order to change the teeth.

Optionals : New ! Quick Disconnect Magnetic Articulator for Typodont Jaws, reduces the down time to change teeth. Water drainage connector. Silicon Tubing for working with water. Universal Articulator which most other brand of Typodont jaws can be fit.



Fletcher

Cavity



iSIM BENCH MOUNT

SKU : NA004

The full 360 degree dome skull with full wrap around face mask for complete simulation of a real patient.



Full Skull, wrap around Fletcher, Universal Articulator, Typodont Jaw with 32 Teeth & Soft Gums, and the Bench Mounting Assembly.

The Fletcher encloses the jaws completely from all sides allowing working with water spray. Simulation exercises with limited space and realistic elasticity are made possible by using this oral cavity mask. Permits all ergonomic movements. Can be mounted on up to 6 cm thick table top. Typodont Teeth are retained with screws and can be changed easily. Jaws are held by the screws in knobs and can be easily accessed in order to change the teeth.

Optionals : New ! Quick Disconnect Magnetic Articulator for Typodont Jaws, reduces the down time to change teeth. Water drainage connector. Silicon Tubing for working with water. Universal Articulator which most other brand of Typodont jaws can fit

Mounting Options : Bench Mount, Dental Chair Head Rest Mount, Dental Chair Back Rest Mount, Table Top Display Mount, Under Table Slider Mount.



SKU : NA234

Chair Backrest



SKU : NA236

Chair Headrest



SKU : NA232

Under Table Slider



SKU : NA235

Table Top



NEO BENCH MOUNT

SKU : NEO

Aluminum Hard Metal Skull with Ears. Advanced Magnetic Articulator with condylar ridges, ramus simulating TMJ. Condylar ridge moves forward when the mandible is pushed down to open, and locks in fixed position to ideal mouth opening. Jaws are held Magnetically, allowing quick access & changing the teeth. Retention Spring push back the jaws in occlusion.

Full Metal Skull with ears, wrap around Fletcher, Universal Articulator, Typodont Jaw with 32 Teeth & Soft Gums, and the Bench Mounting Assembly.

The Fletcher encloses the jaws completely from all sides allowing working with water spray. Simulation exercises with limited space and realistic elasticity are made possible by using this oral cavity mask. Permits all ergonomic movements. Can be mounted on up to 6 cm thick table top. Typodont Teeth are retained with screws and can be changed easily. Jaws are held by the screws in knobs and can be easily accessed in order to change the teeth.

Mounting Options : Bench Mount, Dental Chair Head Rest Mount, Dental Chair Back Rest Mount, Table Top Display Mount, Under Table Slider Mount.

SKU : NA003



iTORSO PHANTOMHEAD ASSEMBLY

An ideal solution for working with simulators on Dental Chair, to use all it's facilities viz. Delivery unit, examination lights, suction, height & angle adjustments. The phantom lays on the dental chair simulating the patient, and replicating the lifelike experience.

SKU : NA247

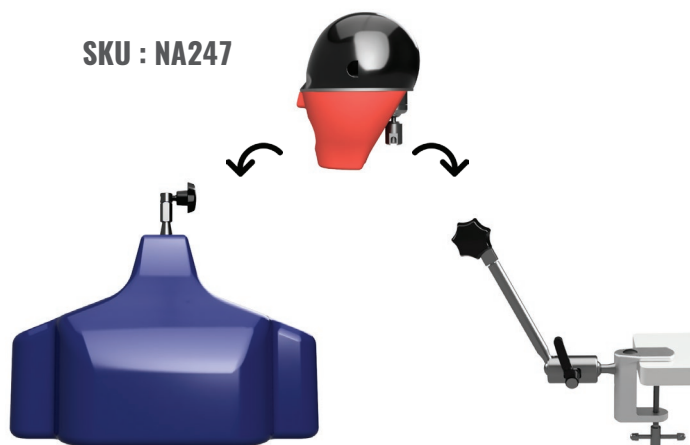

cSIM DENTAL CHAIR UNIT

Smaller in footprint. It's simple modular design is easy to customise and change as per customer requirements. Ideal for Simulator system integrators and assemblers. Economical and ready to use solution saves time for system integrators.

SKU : NA240



SKU : NA225

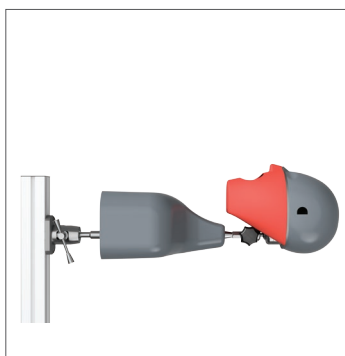

SKU : NA244





SKU : NA214

NAVADHA ZX TYPODONT JAW

Adult dentition Model, Anatomical shaped crowns with detailed morphology. Teeth made of hard thermosetting resin cuts & feels like natural tooth. Strong polymer Jaw base, and Soft anatomical shaped Gingiva. Teeth are retained with screws, and can be replaced.



SKU : NA216

NAVADHA ZX JAW REPLACEMENT TEETH FOAM SET

Replacement teeth for Navadha ZX Adult dentition Jaw Model. Anatomical shaped crowns with detailed morphology as natural teeth. Teeth made of hard thermosetting resin cuts and feels like natural tooth. Set of 32 Teeth available in Foam.

Or loose 32 teeth in a bag (SKU : NA216-A)



SKU : NA217

NAVADHA ZX JAW REPLACEMENT INDIVIDUAL TEETH

Replacement teeth for Navadha ZX Adult dentition Jaw Model. Teeth made of hard thermosetting resin cuts and feels like natural tooth. Individual teeth loose in bag. Retention screws available separately.



SKU : NA220

NAVADHA ZX REPLACEMENT GINGIVA PAIR

Replacement Gingiva Gums for Navadha ZX Adult dentition Jaw Model. Made with soft silicone material. Cervical Contours replicate the anatomy of natural gingiva. Available in pair of 1 Upper + 1 Lower part.



SKU : SP001

HARD GUMS JAWS WITH 32 TEETH

Hard gingiva with 32 changeable teeth. Thermosetting resin teeth, retained with screw from the back, with changeable Teeth.



SKU : SP002

RADIOLOGY TRAINING JAWS

X-Ray Radiology Training Jaws are necessary to prepare students for clinical dentistry. Includes Radio-Opaque Jaw with Tongue. Can be mounted in Torso, Bench, Table, Dental Chair Mount Models, with help of articulated Quick Disconnect Magnetic Trays.



SKU : SP004

SURGERY PRACTICE JAWS

Model for practicing surgery. Twelve different simulations. Impacted Tooth wisdom tooth in lower jaw, tooth in hard upper palate, cysts, granuloma, and more. Made from Artificial Bone simulating Material.



SKU : SP004-A

SURGERY PRACTICE MODEL GUIDE

Transparent guide model for the Surgery Practise jaws Model SP004. Required to identify the location of the various disease for surgical procedures.



SKU : SP005

PERIODONTOLOGY JAW WITH FIXED TEETH

Periodontology Jaws with Fixed Teeth. The caries are spread diffusely. Hyperplastic gingiva ideal for surgical practise. Made from Artificial Bone simulating Material.



SKU : SP006

PERIODONTOLOGY JAW WITH SCREW-IN TEETH

Periodontology Jaws with changeable Teeth and gums. The caries are spread diffusely. Hyperplastic gingiva ideal for surgical practise. Made from Artificial Bone simulating Material.



SKU : SP007

PERIODONTAL JAW WITH CARIOUS & TARTER

Periodontal Jaw with carious teeth, affected by Tarter. Teeth are anatomical in shape. Made from Artificial Bone simulating Material.

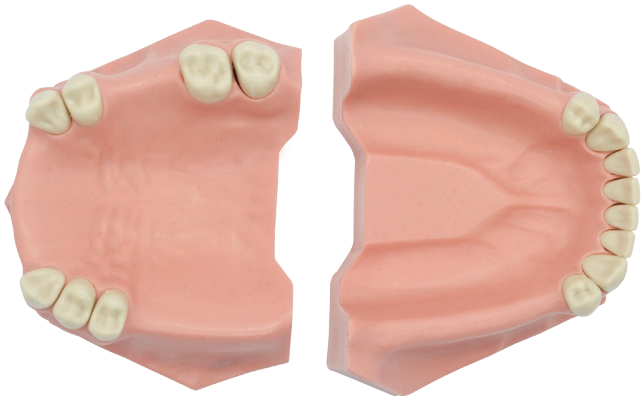

SKU : SP001-P

PRACTISE JAW PARTIAL EDENTULOUS

Partially edentulous practise Jaw with hard ginigva. Thermosetting resin teeth, retained with screw from the back, with changeable Teeth.





ENDODONTIC JAW WITH CHANGEABLE TEETH

Jaws for practicing endodontics. The Teeth are changeable after practice. Anatomically shaped Teeth have transparent root canals, and tooth coloured crowns. Transparent root canals allow visualization of the obturation and filling. The crown can be prepared for prosthetic training.



ENDODONTIC JAWS REPLACEMENT TEETH

Endodontic simulated Teeth with anatomically shaped root canals. Teeth used for Access opening, Root Canal cleaning, lengthening, widening, and shaping. Canal Obturation, sealing, crown cutting and prosthesis planning practice. Teeth can be fitted in Model SP008



PARALLELEPIPED TEETH WITH SOFT WAX

Parallelepiped Teeth with soft wax for endodontic training. Transparent base allows Root Canal cleaning, lengthening, widening, and shaping. Canal obturation, sealing, visualization.



ENDO PRACTISE BLOCK WITH DOUBLE APEX CURVATURE

Endodontic Practise Blocks with double apex curvature. Transparent base allows visualisation of root Canal cleaning, lengthening, widening, and shaping. Canal obturation, sealing.



SKU : SP012

ENDO PRACTISE BLOCK WITH APEX CURVATURE

Endodontic practise block with apex curvature. Natural anatomical curvature allows realistic practise in clinically simulated situation where root canals are curved. Transparent base allows Root Canal cleaning, lengthening, widening, and shaping. Canal obturation, sealing, visualization.

SKU : SP013



ORAL HYGIENE PRACTISE MODEL

Model for oral hygiene practice with light pink coloured gums, and removable teeth.



SKU : SP014

PERIODONTIC PRACTISE JAW WITH BONE SHRINKAGE

Periodontic and oral hygiene practice model with strong bone shrinkage light pink coloured gums, and removable teeth. Inflamed gums represent the periodontal disease. Bone shrinkage can be seen through the light pink gingiva.



SKU : SP014-A



ORAL HYGIENE MODEL WITH IMPLANT PROSTHESIS

Model for oral hygiene practice with light pink coloured gums, and removable teeth. Contains one bridge on the implant, one crown on Implant and one screw retained crown on implant. Ideal for practicing gingival curettage.





SKU : SP015

ANESTHESIA PRACTISE JAW MODEL

Simulator to Train Dentist on Anesthetic delivery. Models consists of Maxilla and Mandible with Ramus. If the needle incorrectly red light glows with alarm. If injected correctly the Green Light glows. Battery operated. Injector syringe included.



SKU : SP017

SINUS ELEVATION & IMPLANT PLACEMENT MODEL

Model to practise Sinus Lifting and Implant Placement. Made from Artificial Bone simulating Material.



SKU : SP017-A

RADIOPAQUE SINUS ELEVATION & IMPLANT PLACEMENT MODEL

Radiopaque Model to practise Sinus Lifting and Implant Placement. Made from Artificial Bone simulating Material.



SKU : NA24-A

MANDIBLE FOR IMPLANT PLACEMENT PRACTISE

Mandible to practise implant placement. Made from Artificial Bone simulating Material.



SKU : NA24-B

MANDIBLE FOR IMPLANT PLACEMENT WITH SOFT GUMS

Mandible for Implant placement with soft gums simulating gingiva. Made from Artificial Bone simulating Material.



SKU : SP066

ANATOMICAL SHAPE SIMPLE MANDIBLE

Anatomical shaped simple mandible with the ramus and condyle ridges for implant placement training practise. Made from Artificial Bone simulating Material.



SKU : SP062

TRANSPARENT RESIN SINUS LIFT MODEL

Sinus lift and implant placement practise model in transparent resin.



SKU : SP043

MANDIBLE MODEL FOR IMPLANT TRAINING

Mandible model for implant placement training with anatomical shaped ramus and condyle ridges. Made from Artificial Bone simulating Material.





SKU : SP042

TRANSPARENT RESIN SINUS LIFT MODEL

Sinus Lift practise model in white resin. Anatomical shape.



SKU : SP044

SINUS LIFT WITH SOFT GINGIVA MODEL

Sinus Lift and implant placement practice Model with Soft gingiva. Made from Artificial Bone simulating Material.



SKU : SP064

PROSTHESIS PRACTISE EDENTULOUS MODEL

Prosthesis practise edentulous model in hard resin material.



SKU : SP065

EXTRACTION PRACTISE JAWS

Models to practise extraction. Model can be prepared to place Implants after extraction.





SKU : SP069

ORTHODONTIC JAW

This Manikin comes with an Orthodontic Jaw to simulate orthodontic treatment. A student can practice to place the bracket and then soak the jaws into 60 C warm water. Observe the final result.



SKU : SP071

PERIODONTAL MODEL FOR GINGIVAL SUTURING

Maxilla Periodontal model for gingiva suturing. Made from Artificial Bone simulating Material.

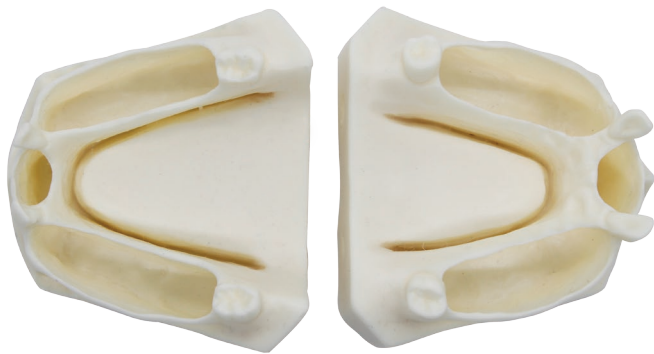

SKU : SP072

JAWS WITH FACILITY TO INSERT EXTRACTED NATURAL TOOTH

Pair of Upper and Lower Jaw with slots to fix natural extracted teeth with wax. Crevice in the lingual side of the Jaw for placement of Radiography Xray Film to shoot xray.

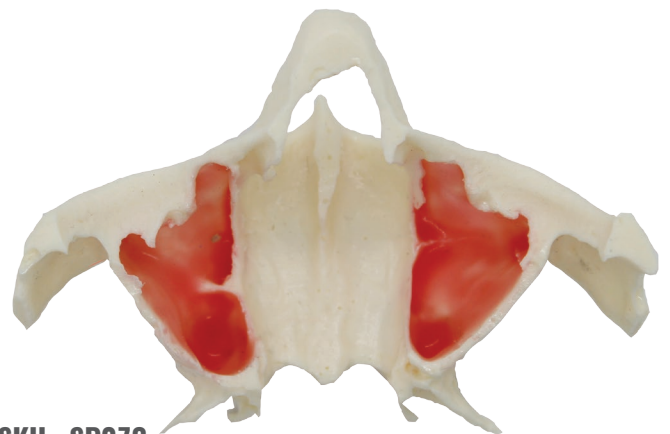

SKU : SP073

LIFE SIZE ANATOMICAL JAW WITH SINUS

Life size anatomical jaw with sinus for zygomatic implants.



CONSULTATION MODEL

Display and consultation model with Upper and Lower Jaw held together with hinged plastic articulator in the back.



SKU : SP068

PRIMARY DENTITION MODEL

Model for Primary Dentition with removable teeth and soft gingiva. Teeth crowns are anatomically shaped. Teeth are retained with the screws and changeable. Soft gingiva is also changeable.



SKU : SP68-A

TEETH FOR PRIMARY DENTITION MODEL FOAM SET

Complete Teeth for Primary Dentition Jaw Model SP052.



SKU : SP068-B

PULPECTOMY TEETH FOR PRIMARY DENTITION MODEL

Set of 6 acrylic teeth for pulpectomy practice for primary dentition model SP068.



SKU : SP075

PARTIALLY EDENTOLOUS MODELS FOR IMPLANT PRACTICE

Partially Edentulous Maxilla & Mandible for implant placement practise. Comes ready with pocked for placing implants, covered with soft gingiva.



SKU : ZXNCT

NATURAL COLOUR TOOTH MODEL WITH GINGIVA

Display model with Teeth exhibiting natural hue and chroma, with soft natural feel gingiva. Teeth are retained with help of screws, and can be removed if needed. It can be used to place different orthodontic brackets, devices or create various orthodontic display combinations. Set of 32 Teeth.



SKU : ODM

ORTHODONTIC DISPLAY MODEL

Orthodontic display model with soft natural feel gingiva. Teeth are retained with help of screws, and can be removed if needed to place different orthodontic devices or create various orthodontic display combinations. Set of 32 Teeth.



SKU : NA202

PHANTOM ECONOMY

Most Economically priced phantom available, with all basic functionalities required for student to practise privately, ideal for home setup. Soft Oral cavity ensures easy access to all the Teeth, and water from Hand piece drains out easily. Jaw mounted on the pole moves forward, reclines, and sideways.



SKU : NA012



FIXED METAL ARTICULATOR

Fixed Mouth opening articulator. Fits most brand & make of jaws & models. Fixed gap between Maxilla & Mandible, and strong retention of models fixed on the same.

SKU : NA011



UNIVERSAL METAL ARTICULATOR

Fully Adjustable. Fits most brand & make of jaws & models. Adjustable Height, & angle. Facility to Lock the gap between Maxilla & Mandible. Simulates limited TMJ movements. Custom training models can also be adapted to this articulator easily viz. Xray Training, Implant Training, Prosthetic etc.

SKU : NA262



ADVANCED MAGNETIC ARTICULATOR

Magnetic Articulator with condylar ridges, ramus simulating TMJ. Condylar ridge moves forward when the mandible is pushed down to open, and locks in fixed position to ideal mouth opening. Jaws are held Magnetically, allowing quick access & changing the teeth. Retention Spring push back the jaws in occlusion.



SKU : NA013-A



ADJUSTABLE MAGNETIC ARTICULATOR

Adjustable Magnetic articulator. Holds the Navadha ZX jaws Magnetically. With Hinge articulator at the back. Also works with Model AG-3.





SKU : NA01-C

ORAL CAVITY

Dental Models for practise are placed inside the oral cavity to simulate human cheeks and lips. Semi Flexible to emulate human oral cavity. Highly useful to collect water sprayed from hand piece while working on the model. Facility to fix a water discharge pipe to drain out the water from the back.



SKU : NA01-F

ORAL CAVITY CLEAR

Transparent Oral Cavity allows users to visualise, demonstrate and record the procedures. Dental Models for practise are placed inside the oral cavity to simulate human cheeks and lips. Collect water sprayed from hand piece and drains via a discharge pipe from the back.

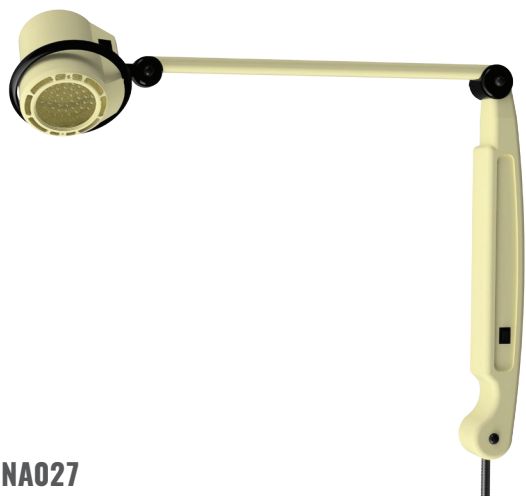

SKU : NA027

LED EXAMINATION LIGHT

White LED examination Light with articulated spring loaded arms. 15000 Lux intensity, Colour temperature of 4300k. Optional fitting available to mount on Walls, Ceiling and Floor Mount as well.

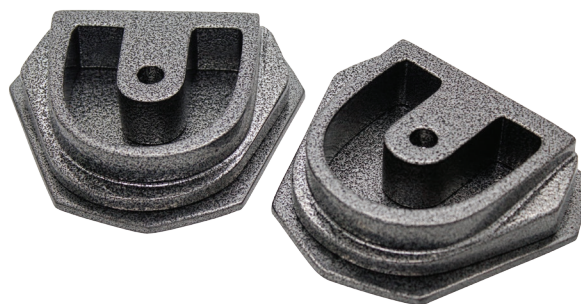

SKU : VICE

VICES

Naturally extracted teeth can be mounted inside the vices with help of Wax, Dental plaster or stone. Made from Strong engineering grade aluminum and coated. It can be reused several times.



SKU : NA068

iCONTRASTER

Creates perfect blackout background for Dental oral Photos. Cameras focus better & click sharper "True-colour" images with non-reflective specially coated contrasters. Eliminates the blur effect. Reduces the Intraoral distractions. Allows shade matching for restorations. Available 3 sizes. Autoclavable



SKU : NA067

iCOMPOSCULPT KIT

Enables composites modeling & placement in layers. Eliminates fractures, pin holes, bubbles in composite layers. Non-Sticking Tips ensures easy application. Different shapes for different contouring needs. Homogeneous application gives composites the natural look. 1 Handle & 50 tips kit. Handle Autoclavable



SKU : NA056

iMATRICE KIT

Cervical Matrices for Class V Filling. Clear flexible matrices adapt to Tooth Anatomy. Thin edges allow sub-gingival cavities filling. Non-stick to Composite & Cement. Compressing filling compacts & prevents moisture. Minimal or no finishing required. 6 different shaped matrices. 210 Matrices & 1 handle Kit.



SKU : NA56-A

iMATRICE REFILL PACK

Refills Matrices for the Cervical Matrices for Class V Restorations Kit. Transparent & semi flexible, thus adapt perfectly to Tooth Anatomy. No manipulation needed. Filling protected from Moisture & air. 6 different shapes for Anterior, Pre-Molars & Molars. Refill packs of 100 matrices .



CONTACT STRIP SAW

Interdental cutting or sanding blade move in rocking motion within inter-proximal space with gentle pressure against the excess to be removed. Removes excess resins, Adhesive Cement & amalgam. Sanding blade provided for further finishing. Blades replaceable ensure predictable results.



SKU : NA59-A

REFILL BLADES FOR CONTACT STRIP SAW

To achieve ideal proximal contact of indirect restorations - Seating of crowns & Accurate occlusion. Refill blades available in two variants for Cutting and other for Sanding. Comes in pack of 5 piece each variant.



SKU : NA053

ENDO ASSIST

All Endo Assist ring sits on the finger with all Endo procedure needs, saving treatment time. Built in measuring scale & positions rubber stopper. Measure straight & curved instruments. Replaceable Foam inserts clean & holds files during use. Autoclavable

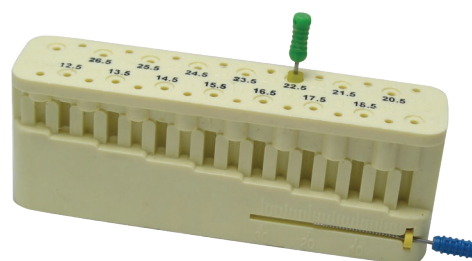

SKU : NA054

ENDO INSTRUMENT MEASURING BLOCK

Measures Endo Instruments, for working length. Graduated holes of different lengths with facility for engaging silicon stopper when measuring files . Autoclavable.





SKU : NA055

ENDO INSTRUMENT ORGANISER SET

Stores all type of Endo Instruments, Protapers®, Files, Reamers, Spreaders, Engine Files etc.. Holds 42 Endo Instruments in clear, visible & separated system. Organiser ensures you have a sterile set for each patient. Organise & Store instruments by Procedure or Type. All Components are Autoclavable.



SKU : NA055-A

REFILLS FOR ENDO INSTRUMENT SET ORGANISER

Autoclave, Seal, and Store numerous sets of Endo Instruments. Use a fresh autoclaved set for each patient, removing the sterilization seal in front of them. Transparent case allows one to identify easily different types of Endo Instruments. Accommodates all types of Endo Instruments Files, Reamers, Spreaders, etc.

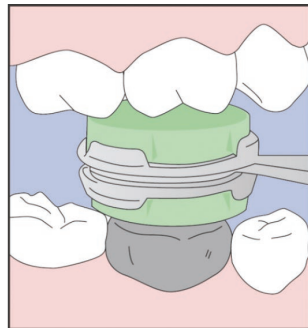
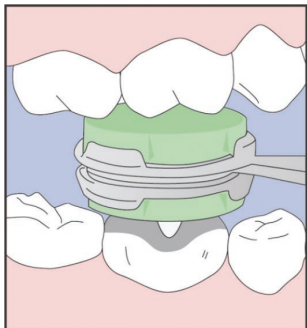

SKU : NA057

CROWN & INLAY SETTER

Prevents lifting up of prosthesis by allowing the patient to bite on the setter during the cementing process. Eliminates the need to hold down or exert pressure while fixing the prosthesis. Allows time to remove the additional cement, fully Autoclavable and reusable. Made of super soft food grade material.



SKU : ORART

ORTHODONTIC TYPDONT ARTICULATOR

Orthodontic typodont articulator for orthodontic training, comes with one set of Metal teeth set, and Class 1, Class 2 Div - 1, Class 2 - Div 2, and Class 3 wax rims. Made for strong aluminum and coated.



SKU : NA504

HAND PUPPETS

Dental Hand Puppets with hand-made denture with natural looking 2 layered Acrylic Teeth & pink denture material. Puppets make learning oral hygiene fun. Used to demonstrate proper brushing techniques & oral care to children at schools & community centres. Easy to carry Puppets. Size range 6 ~ 10 inches. Pack of 5 Pcs.



SKU : NA505

HAND PUPPETS WITH METAL ORTHO BRACES

With Real Metal Orthodontic Brackets, Wires, & Elastics, hand-made denture with natural looking Acrylic Teeth. Secures cooperation when placing braces fun for pedo patients. Demonstrate oral hygiene & ortho bracket maintenance with help of the Puppets. Size range 6 ~ 10 inches. Pack of 1 Piece



SKU : NA506

MEDIUM SIZE HAND PUPPETS

Useful to demonstrate proper brushing techniques & oral care to children at schools & community centres. Dental Hand Puppets with Real hand-made Acrylic Teeth & Dentures for natural look & feel. Puppets with soft fluffy filling. Size range 12 ~ 14 inches. Pack of 1 Piece.



SKU : NA508

LARGE PUPPETS

Useful to demonstrate proper brushing techniques & oral care to children at schools & community centres. Dental Hand Puppets with Real hand-made Acrylic Teeth & Dentures for natural look & feel. Puppets with soft fluffy filling. Size range 18 ~ 24 inches. Pack of 1 Piece.



SKU : NA501

HD quality animated visual presentation helps educate, and demonstrate the treatment line and options. Eliminates repetitive task of explaining each new patient. Simple layout & easy to use, even dental assistants & secretary can explain patients, & answer frequently asked questions. Saves dentists time, dental chair time & improves efficiency. Over 120 topics covered under Implants, Surgery, Endodontics, Periodontics, Prosthodontics, Orthodontics, Hygiene, Restorations etc. Available in English, Spanish, Portuguese, German, Italian, Turkish, Japanese, Arabic.



WWW.NAVADHA.COM