





## INTERDENT® d.o.o.

### HEADQUARTERS

SI - 3000 CELJE  
 Opekarniška cesta 26  
 SLOVENIA  
 T: +386 (0)3 425-62-00  
 F: +386 (0)3 425-62-10  
 E: info@interdent.cc

### PRODUCTION & WAREHOUSE

SI - 3342 GORNJI GRAD  
 Dol 1a  
 SLOVENIA

[www.interdent.cc](http://www.interdent.cc)

# CATALOGUE

2017



Dear business partners,

Dentistry is a demanding profession – dental technicians, dental assistants and dentists are expected to work with precision and responsibility. Only so will the patients' needs be satisfied in terms of function and aesthetics.

This rapidly progressing profession demands you to have a reliable partner by your side that not only offers products of high and constant quality but also ensures flexibility and responsiveness in this modern era of large corporations.

The existing digital technologies demand the users to constantly improve their knowledge and skills. Only a partner who offers production and sales together with technical support can ensure constant growth and development at your work.

Inderdent d.o.o. is a family company founded in 1978. It is a reliable and flexible partner that offers its users CAD/CAM and classic products of high quality. The responsive technical support is available at all times.

Together we can achieve more.

Interdent team



The headquarters of Interdent Celje, Slovenia



Production facilities Interdent, Gornji Grad, Slovenia

Constant education in the field of dentistry is gaining in importance. It contributes to better understanding of materials and technological processes. In these times of digital technology, keeping up with contemporary trends should be one of the main concerns.



CAD/CAM centre Interdent, Celje, Slovenia

Educational Centre Interdent offers you educational courses about classic and contemporary technologies in a CAD/CAM centre with five milling units and three scanners. The modern laboratory has twelve workplaces, the lecture room has 45 workplaces, and the centre is also equipped with two clinics for general dentistry and surgery.



Training centre Interdent, Celje, Slovenia

Authorized training centre



For more information about course summaries please visit our website [www.interdent.cc](http://www.interdent.cc)



CAD/CAM SYSTEM

With 40 years of experience in the field of dentistry we offer you products and a comprehensive solution regarding CAD/CAM technology, which is described in the catalogue CAD/CAM System.

The complete range presents an open system designed for anyone who wants to introduce advanced technology into their laboratory, which will provide flexibility, accuracy, and independence.

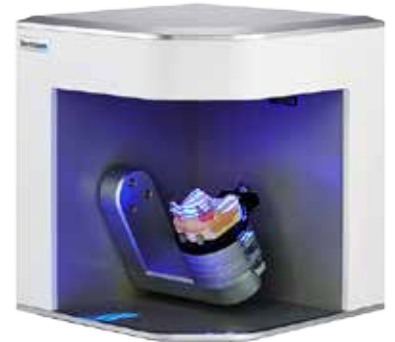

IDENTICA SCANNER - MEDIT



SOFTWARE EXOCAD

DISCS FOR CAD/CAM



MILLING CENTRE

## CAD/CAM SYSTEM



CC POWER



CC COSMO+



CC COSMO/COSMO STAR



CC TRENDY



CC CHIC

With INTERDENT, easy-to-use advanced technology and excellent material are backed by an expert support that is available to you throughout the entire process, from your wish and ideas for the purchase to education and quick resolution of any problems occurring in their use.

More information regarding CAD/CAM system can be found in CAD/CAM catalogue or on the website [www.interdent.cc](http://www.interdent.cc).





7

PREPARATION OF WORKING MODELS



17

MODELLING



27

DUPLICATING, INVESTING AND CASTING



37

PRECIOUS METAL ALLOYS

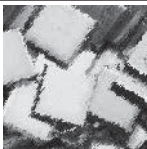

41

ACRYLICS



47

SANDBLASTING AND FINISHING

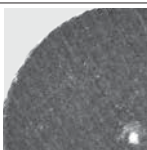

53

CERAMICS ACCESSORIES



57

EQUIPMENT



63

DENTAL SURGERY ACCESSORIES





## PREPARATION OF WORKING MODELS



## INTERROCK NEW TYPE IV

EN ISO 6873

Colour:	ivory/gold-brown
Mixing ratio:	20 ml water / 100 g powder
Mixing time (manual):	15 seconds
Mixing time (vacuum):	60 seconds
Working time:	ca. 5 minutes
Setting time:	ca. 12 minutes
Setting expansion:	0.07 % after 2 h
Compressive strength:	60 MPa after 1 h
Hardness:	250 MPa after 24 h

Synthetic extra hard stone with high resistance. It is suitable for making precise working model for partial denture and fixed prosthetics work. It is a thixotropic stone that gives very sharp, clear edges and has a very smooth surface. Colour gold-brown is suitable for CAD/CAM technique for powder-free scanning.



REF 0982	alu-sack	4 kg	ivory	REF 0981	alu-sack	4 kg	gold-brown
REF 0968	pail	5 kg	ivory	REF 0951	pail	5 kg	gold-brown
REF 0969	pail	20 kg	ivory	REF 0952	pail	20 kg	gold-brown
REF 0962	sack	25 kg	ivory	REF 0953	sack	25 kg	gold-brown

## INTERSTONE NEW TYPE IV

EN ISO 6873

Colour:	sahara
Mixing ratio:	23 ml water / 100 g powder
Mixing time (manual):	15 seconds
Mixing time (vacuum):	60 seconds
Working time:	ca. 5 minutes
Setting time:	ca. 10 minutes
Setting expansion:	0.10 % after 2 h
Compressive strength:	49 MPa after 1 h
Hardness:	150 MPa after 24 h

Extra hard, thixotropic, synthetic stone with good flow properties. It is suitable for making master models, individual models in fixed prosthetics and models for partial denture.



REF 0983	alu-sack	4 kg
REF 0971	pail	5 kg
REF 0972	pail	20 kg
REF 0955	sack	25 kg

## INTERDUR TYPE III

EN ISO 6873

Colour:	blue
Mixing ratio:	26 ml water / 100 g powder
Mixing time (manual):	15 seconds
Mixing time (vacuum):	60 seconds
Working time:	ca. 4 minutes
Setting time:	ca. 9 minutes
Setting expansion:	0.15 % after 2 h
Compressive strength:	40 MPa after 1 h
Hardness:	120 MPa after 24 h

High quality thixotropic hard stone for production of first class working models. Its extra surface density is ideal for use in removable prosthetics. It is also recommended for antagonistic models, when making precise prosthetic works.



REF 0956	pail	5 kg
REF 0958	pail	20 kg
REF 0957	sack	25 kg



## BLUE STONE TYPE III / YELLOW STONE TYPE III

EN ISO 6873



Colour:	light blue, yellow
Mixing ratio:	30 ml water / 100 g powder
Mixing time (manual):	15 seconds
Mixing time (vacuum):	60 seconds
Working time:	ca. 6 minutes
Setting time:	ca. 9 minutes
Setting expansion:	0.20 % after 2 h
Compressive strength:	30 MPa after 1 h
Hardness:	80 MPa after 24 h

Synthetic, thixotropic, hard quality multipurpose stone. It is suitable for making master models in total prosthetics work, situations models and secondary part of a working model - socket. The high flow characteristics ensure accurate reproduction of all details from the impression.

REF 0973	Blue stone	pail	5 kg	REF 0975	Yellow stone	pail	5 kg
REF 0974	Blue stone	pail	20 kg	REF 0976	Yellow stone	pail	20 kg
REF 0965	Blue stone	sack	25 kg	REF 0966	Yellow stone	sack	25 kg

## ORTHOPLASTER

EN ISO 6873



Colour:	white
Mixing ratio:	27 ml water / 100 g powder
Mixing time (manual):	15 seconds
Mixing time (vacuum):	60 seconds
Working time:	ca. 6 minutes
Setting time:	ca. 9 minutes
Setting expansion:	max. 0.15%
Compressive strength:	40 MPa after 1 h
Hardness:	120 MPa after 24 h

Super white thixotropic stone for making models in orthodontics. It has good flowing properties that allow reproducing of all details in the impression. The model has smooth surface and good hardness. Particularly recommended for making study models in orthodontics.

REF 0978	pail	5 kg
REF 0984	pail	20 kg
REF 0985	sack	25 kg

## ARTIPLASTER

EN ISO 6873



Colour:	white
Mixing ratio:	30 ml water / 100 g powder
Mixing time (manual):	15 seconds
Mixing time (vacuum):	60 seconds
Working time:	ca. 2 minutes
Setting time:	ca. 3,5 minutes
Setting expansion:	0.03 % after 2 h
Compressive strength:	21 MPa after 1 h
Hardness:	60 MPa after 24 h

Gnathology requires special stones for articulating, whereby expansion ratio is of extreme importance. After eight days the expansion is only 0.03%.

REF 0959	pail	5 kg
REF 0961	pail	20 kg



## ALABASTER

EN ISO 6873

Colour:	grey-white
Mixing ratio:	55 ml water / 100 g powder
Working time:	ca. 3-4 minutes
Setting time:	ca. 8 minutes
Setting expansion:	0.20 %
Compressive strength:	12 MPa after 1 h
Hardness:	12 MPa after 24 h

A general purpose dental plaster for investing prosthesis into the flask before polymerization.



REF 6624 sack 25 kg

## ARTICULATOR ARTI-LITE II

- adjustable
- inclination of Condil way 35°C
- Benet angle 0°-20°
- weight 540 g



REF 81030.2

### ADDITION

REF 81035	mounting plate
REF 81065	plastic loadstar - Calotte
REF 81070	magnet Splitcast system, á 2 pcs
REF 81062	matrix Splitcast system
REF 81060	adapter
REF 81059	socle for biting spoon

## FACEBOW

- facebow complete
- registration
- facebow bag

REF 81057



## OCCLUDATORS

REF 3401	occludator small
REF 3402	occludator large



## THE HARDNESS OF INTERDENT STONES AND PLASTERS AFTER 24 HOURS IN MPA

IN CHART YOU CAN SEE THE HARDNESS OF INTERDENT STONES AND PLASTERS.

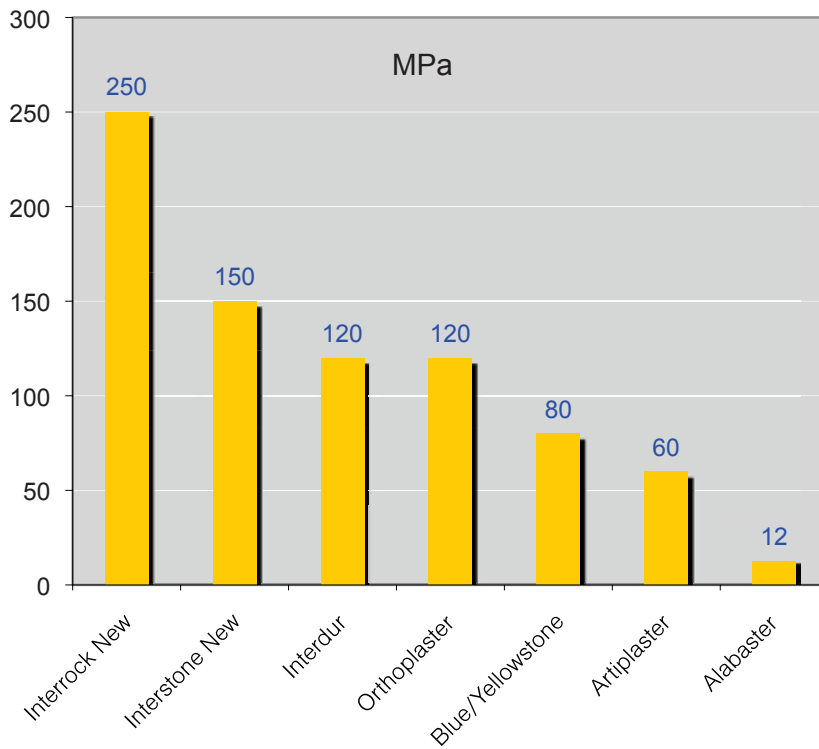

EXACT COPY OF ALL DETAILS AND VERY SMOOTH SURFACE.

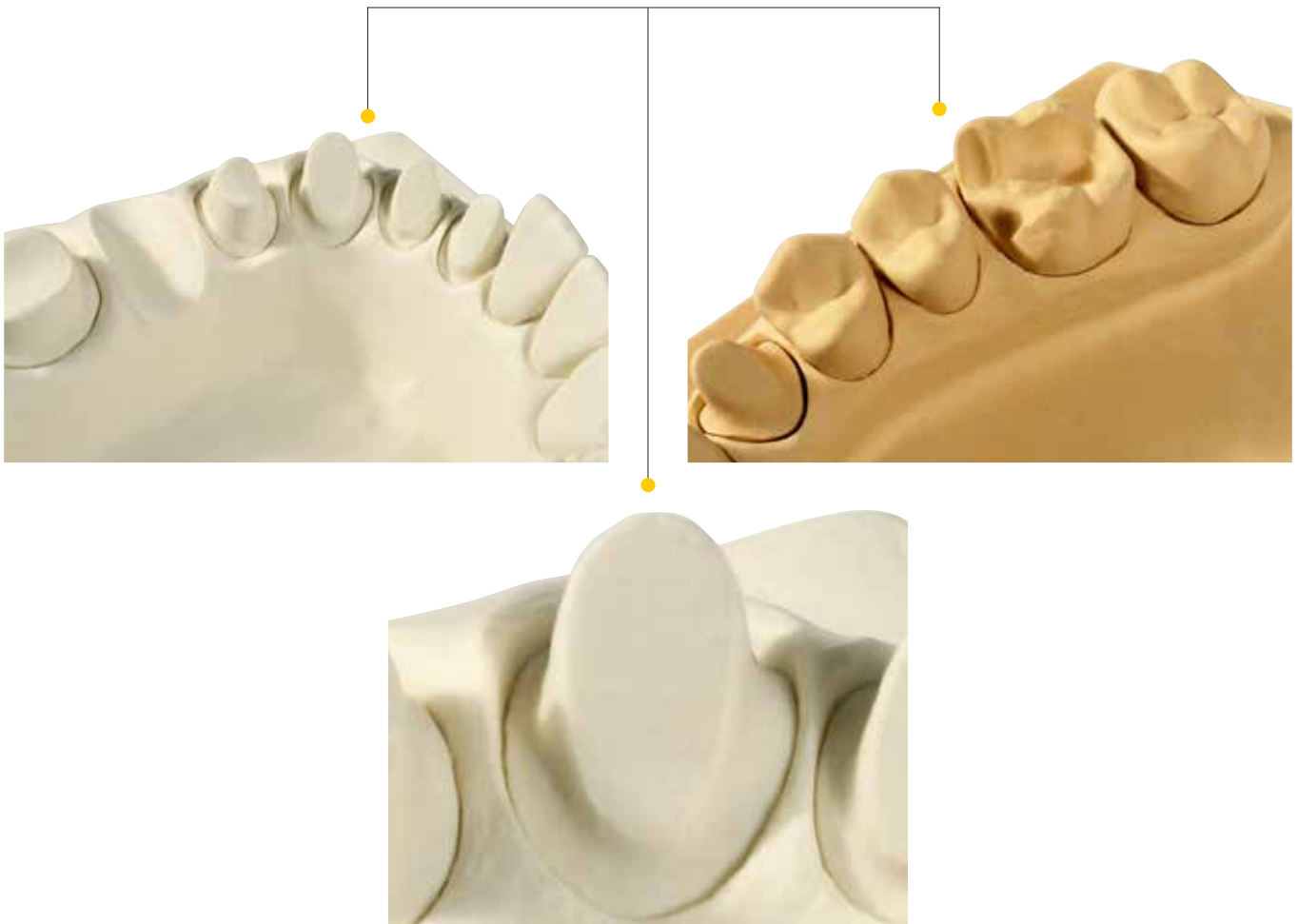

## SMALL PATTERN SAW WITH SPARE BLADES

Saw frame is made of spring-hardened stainless material. Blade replacement is quick and simple. Two sizes of saw blade with blade thickness of 0.25 mm.

REF 0335	pattern saw with spare blade
REF 0356	pattern saw bended with spare blade

SPARE BLADES (thickness 0.25 mm):

REF 0336	3 x 0,25 mm	3 pcs
REF 0336-10	3 x 0,25 mm	10 pcs
REF 03361	5 x 0,25 mm	3 pcs
REF 03361-10	5 x 0,25 mm	10 pcs



## RETAINING RINGS

Used to provide retention between primary and secondary plaster model.

REF 0305	retaining rings	100 pcs
REF 0305T	retaining rings	1000 pcs



## DOWEL PINS, DOWEL PINS FIXATOR, POINTED DOWEL PINS

POINTED DOWEL PINS are made out of brass and are available in three different sizes. The tip of the pin allows easy installation and removal without damaging the model.

REF 0298	dowel pins L pointed (large)	100 pcs
REF 0298T	dowel pins L pointed (large)	1000 pcs
REF 0299	dowel pins M (pointed medium)	100 pcs
REF 0299T	dowel pins M pointed (medium)	1000 pcs
REF 0300	dowel pins S pointed (small)	100 pcs
REF 0300T	dowel pins S pointed (small)	1000 pcs

DOWEL PINS WITHOUT PIN are made out of brass and available in three different sizes. For easier installation DOWEL PINS FIXATOR can be used.

REF 0301	dowel pins L (large)	100 pcs
REF 0301T	dowel pins L (large)	1000 pcs
REF 0302	dowel pins M (medium)	100 pcs
REF 0302T	dowel pins M (medium)	1000 pcs
REF 0303	dowel pins S (small)	100 pcs
REF 0303T	dowel pins S (small)	1000 pcs
REF 0304	dowel pins fixator	20 pcs



## TWIN PINS

Twin pins assure good fixation of dies in working models, especially in the tight space conditions. Sleeve assures stability of the pin also after frequent removing of the pin. Especially suitable for using in milling technique. Rubber protects sleeves from stone during the production of secondary part of the model



REF 0317	Twin pins L sleeves rubbers	100 pcs 100 pcs 100 pcs
REF 0319	Twin pins S sleeves rubbers	100 pcs 100 pcs 100 pcs
REF 0318	pin drill 2,0 mm for Twin pins	

## RAPID ADHESIVE

Accurate and tight sealing of dry and clean broken stone fragments. It can also be used for ceramics and alloy.



REF 0414	thin	30 - 100 mPa·s	10 g
REF 0416	thick	1200 - 2200 mPa·s	20 g

## PACKAGE FOR PLASTER MODELS

Package for plaster prosthetic models is used for protecting plaster models from damage during sending or carrying.



REF 0730	Package for plaster prosthetic models	1pc for 3 models, height 4,2 cm
REF 0731	Package for plaster prosthetic models	1pc for 1 model, height 5,8 cm





## EASY FORM SYSTEM



### SIMPLE, FAST, ECONOMICAL, PRECISE

#### EASY-FORM STARTER KIT

REF 1600 4 pcs moulds (1)  
2 pcs wedges (2)  
2 pcs screws with magnet (3)  
2 pcs plates for articulator (4)  
2 pcs fixing screws (5)  
1 pcs ejecting screw (6)  
1 pcs Interfilm (REF 0412) (7)

REF 1601 EASY-Form mould kit  
Contents: 24 pcs moulds

REF 1602 EASY-Form wedge  
Contents: 4 pcs wedges

REF 1603 EASY-Form screw with magnet  
Contents: 12 pcs screws for magnet

REF 1604 EASY-Form plates for articulator  
Contents: 4 pcs plates for articulator

REF 1605 EASY-Form fixing screws  
Contents: 4 pcs fixing screws

REF 1606 EASY-Form ejecting screw  
Contents: 1 pcs ejecting screw

REF 0412 Interfilm 200 ml (see page 18 for details)

- simple use, saving material and time, precise results of work;
- time saving because of single phase work system;
- enough space for faceting and modeling of vestibular sections of a tooth;
- when plastering into the articulator, the magnets provide fast and precise assembly;
- solid fixation of particular segments enables simple milling phases (dismantled individual plaster segments);
- model may easily be sliced to particular segments;
- conical notches enable precise placement of objects back into the model and retain them tightly;
- the object is free from rotating, contacts between teeth and the object position are always precise;
- only one type of stone is used;
- reduced consumption of stone;
- no need for dowel pins, retention rings, ring placement accessories and insulation material;
- moulds are so cheap that a dentist may discard it after use.



## EASY-FORM SYSTEM - INSTRUCTIONS FOR USE:

**Insulation:** First insulate all plastic parts with Interfilm. Remove excessive insulation agent by means of air. Thin coat of Interfilm should suffice.

### System assembly (Fig. 1)

Join the articulation plate with the magnet no. 3, mould no. 2 and the wedge no. 1 consecutively as illustrated on the picture, and tighten all parts with a screw.

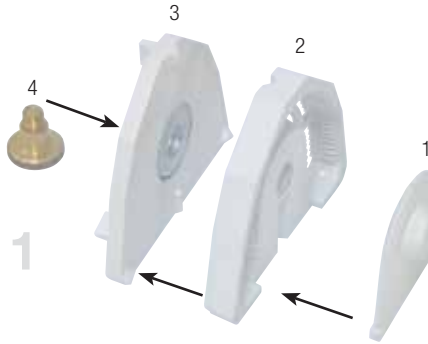

### Preparation of impression (Fig. 2)

Cut off the excess material in the vestibular, lingual or palatal sides.



### Relining (Fig. 3)

When making the upper jaw model, the wedge should be embedded in plasteline, silicone or wax. This may also serve for fixing the impression tray.



### Stone (Fig. 4)

Approximately 70-100 g of stone must be mixed for the fabrication of one model. Setting expansion of stone must not exceed 0.1%. We recommend thixotropic, super hard stone, like Interlock New and Interstone New.

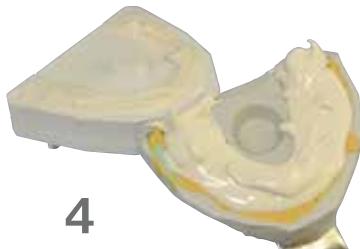

### Founding (Casting)

The impression and the Easy-Form are placed upon the vibrator and filled with stone.

**Important:** the fixing wedge must not be covered with stone for more than 5 mm towards the oral part, so that it may later be extracted.



### CAST REMOVAL (Fig. 5, 6)

Once the stone is hardened, the impression and the tightening screw are removed. Articulation plate with magnet should also be removed.



### Extraction of Model (Fig. 7,8,9)

Tightening screw should be replaced by the extraction screw. Tightening the extraction screw results in uplifting the stone model. In case the stone model is difficult to extract, the extraction screw should be loosened and distal parts of the stone model pressed with thumbs from below. The wedge is removed by pulling it in distal direction.

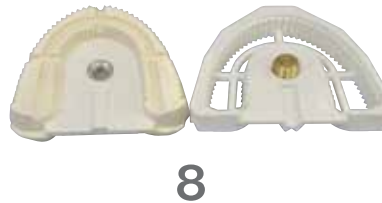

### Treatment of the Stone Model (Fig. 10,11)

The excess stone is removed from the model by help of the stone cutter, and notches are marked with saw.

Useful tip: first cut is done with the saw manually, then the diamond separating disc is used.

Important: stone model should be cut to several segments, depending on the setting expansion of the stone. This reduces the tension within the model. Each stone segment may not exceed the size of 4 cm.



### Reassembly of Particular Segments:

Place the magnetic screw into the plate and arrange particular stone segments according to their symbols. Individual segments are fixed by the wedge. The accuracy of distributed segments may be controlled by means of the control outline upon the wedge.



### Placement into the Articulator

To place the model into the articulator simply bring the articulation plate and the mould with the stone model together (Split-Cast-System).

Important: Easy - Form components may not be heated over 60°C, nor splashed with boiling water.







## MODELLING

## THERMOTOP

Simple temperature regulation. Consistency of dipping wax and lining thickness is determined by temperature setting, melting period is 15 minutes, with wax temperature tolerance of  $\pm 4^{\circ}\text{C}$ .

Properties:

Height: 95 mm  
 Diameter ( $\varnothing$ ): 60 mm  
 Pot volume: 40 ml  
 Voltage: 230 V, 50/60 Hz  
 Power supply: heating phase 85 W  
 working heat 12 W  
 Temperature range: 60 - 105°C  
 Weight: 500 g



REF 0601 Thermotop

## THERMOTOP SET

REF 0600 Thermotop Set consists of:

REF 0601 Thermotop  
 REF 0412 Interfilm  
 REF 0411 spacing varnish  
 REF 0241 dipping wax 50 g



## INTERFILM

Thin coat renders excellent insulation of individual dies in dipping technique. Also separates wax from stone and wax from metal.

REF 0412 Interfilm 200 ml  
 REF 0431 Interfilm 1000 ml



## DIPPING WAX

Very plastic wax with high elastic memory and minimal possible contraction during transition from liquid to solid state.

Recommended working temperature: 75 - 85°C.

REF 0241 50 g  
 REF 0241-200 200 g



## SPACING VARNISH, THINNER

### SPACING VARNISH

Special varnish for individual stone dies, resistant to any insulating agent. It is hard, mechanically resistant and dries rapidly. Single layer thickness (depending on the type): 8-16  $\mu$

REF 0380 spacing varnish, silver 16 ml ca. 13-16  $\mu$  \*  
 REF 0381 spacing varnish gold 16 ml ca. 13-16  $\mu$  \*  
 REF 0382 spacing varnish red 16 ml ca. 10-13  $\mu$  \*  
 REF 0411 spacing varnish silver 20 ml ca. 8-10  $\mu$  \*

### SPACING VARNISH THINNER

Used to determine perfect density of spacing varnish, and for cleaning of individual stone dies and brushes.

REF 0383 spacing varnish thinner 30 ml  
 REF 0410 spacing varnish thinner 20 ml (use with REF 0411)



## INTERFOIL SYSTEM

Quick, simple and precise copying fabrication. Advisable in milling techniques and bigger constructions - bridges.

REF 0400 Interfoil kit

Contents of the kit:

REF 0401 Interfoil 0.60 mm  $\varnothing$  42 mm 100 pcs  
 REF 0402 Interfoil 0.10 mm  $\varnothing$  42 mm 200 pcs  
 REF 0403 plasticine pot 1 pcs  
 REF 0334 foil pincer 1 pcs

REF 0401M Interfoil 0.60 mm, soft,  $\varnothing$  42 mm 100 pcs



## THERMO KNIFE



Mechanically regulated temperature in range 30°C - 250°C. The temperature is constant all the time during work. It is possible to use 10 different tips. There are 4 tips delivered with Thermo knife (REF 0606, REF 0607, REF 0608, REF 0609). It is suitable for use in dental laboratory and in goldsmith's production

REF 0605 Thermo knife with 4 tips  
REF 0617 Handpiece with cork handle

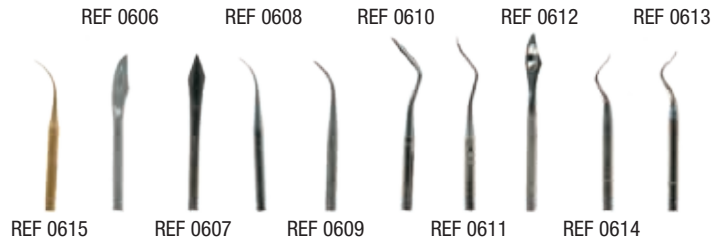

## WAX CENTER



Dipping pot and Thermo knife in one. Mechanical setting of the working temperature enables the modeling of the wax without tension and accurate result. The temperature of the heating instrument comprises a range of 30-230°C while a range of the pot from 60 to 105°C. Each reservoir has a 5-7°C lower temperature as the previous one. Regulation of the temperature of each reservoir separately is not possible. It is possible to use the same tips as at Thermo knife. Suitable for laboratory with two working places.

REF 0604 Wax center with 2 holders

## CORRECTIVE WAX



Corrective wax has high dropping point. It is used for corrections of stone models and for blocking out undercuts. It is harder quality and very opaq white colour. It does not burn out without residues and it is not suitable for waxing up. Before making a cap with dipping method, the space varnish must be used over the corrective wax to prevent reaction between it and dipping wax.

REF 0194-30 white colour 30 g

## CERVICAL WAX

Cervical wax is particularly flexible, tension free, for modeling inlays and cervical parts of crowns.



REF 0233-30 red colour 30 g  
REF 0233-70 red colour 70 g

Dropping point: 59°C

Harder purple cervical wax is particularly flexible, tension free for use in milling technique and in higher temperature places for modeling inlays and cervical parts of crowns.

REF 0291-30 purple colour 30 g  
REF 0291-70 purple colour 70 g

Dropping point: 64°C





## MODELLING WAX

High-quality wax for modelling crowns and bridges. It is easy to apply and modelate, hardens rapidly and burns out without residue.

REF 0286-30	ivory colour	30 g
REF 0286-70	ivory colour	70 g
REF 0288-30	ocher colour	30 g
REF 0288-70	ocher colour	70 g
REF 0283-30	opaque honey colour	30 g
REF 0283-70	opaque honey colour	70 g



## MODELLING AND PRESS WAX

High-quality wax for modelling crowns, bridges and inlays. Suitable for press technique. It is easy to apply and modelate, hardens rapidly and burns out without residue.

REF 0232-30	EUK blue colour	30 g
REF 0232-70	EUK blue colour	70 g
REF 0285-30	dark green colour	30 g
REF 0285-70	dark green colour	70 g
REF 0287-30	honey colour	30 g
REF 0287-70	honey colour	70 g



## OCCLUSAL WAX

Harder modelling wax, ideal for modelling of occlusal surfaces in C+B technique. The opaque wax is extremely easy to apply and is not sticky. It can be used for milling and it burns without residue.

REF 0282-30	turkis colour	30 g
REF 0282-70	turkis colour	70 g
REF 0284-30	grey-blue colour	30 g
REF 0284-70	grey-blue colour	70 g



## GNATHOLOGICAL SET OF WAXES

Set of four different coloured waxes for gnathological modelling.

REF 0200



## MILLING WAX

Milling wax is used for modelling crowns in milling technique. It is easy to mill, does not smear and is perfect for all milling work.

REF 0240-30	green colour	30 g
REF 0240-70	green colour	70 g



## UNIVERSAL WAX

Universal wax is a high quality wax, made of microwaxes and vegetal waxes, opaq light grey colour. Its thick consistence enables use of wax carver. When scratching technique is used, the surface is shiny and smooth. It is very suitable for milling, while it does not stick to the bur and the milled shoulder is perfectly smooth. Wax's hard quality and small inner tensions assure precise work.

REF 0195-30	grey colour	30 g
REF 0195-70	grey colour	70 g



## WAX SEMI-PRODUCTS



REF 0249 wax girlrands for ceramics  
REF 0251 wax constructions for ceramics

SIZES: A, B, C, in frontal sector  
A, B, C, in distal sector

The assortment contains 6 shapes in 3 sizes of 5 pieces each, 90 pieces in total. A refill package contains 10 pieces.

Use order form for ordering refill packages.

	17 - 14	12 - 22	24 - 27	
C				C
B				B
A				A
A				A
B				B
C				C
	47 - 44	42 - 32	34 - 37	

## WAX SEMI-PRODUCTS

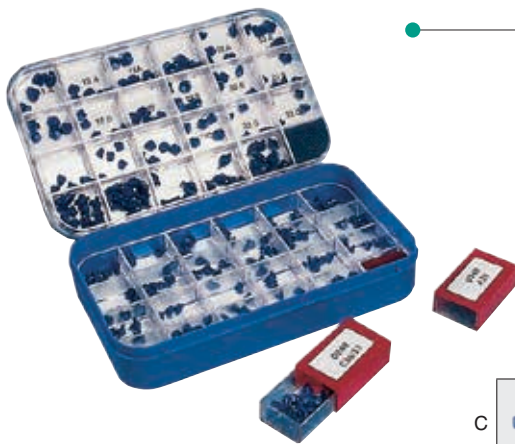

REF 0248 wax pontics for ceramics  
REF 0248-shape refill pack

The assortment contains 54 shapes of 5 wax pontics made of blue wax.

Refill package contains 20 pieces

Use order form for ordering refill packages.

	17/16	13	12	11	21	22	23	26/27	prem	
C										C
B										B
A										A
A										A
B										B
C										C
	47/46	45	44	43	33	34	35	36/37	front	



## WAX SEMI-PRODUCTS

Used for fabrication of cast frameworks with little corrections and adjustments to antagonistic occlusion surfaces. They also provide ergonomic work to the dental technicians in manufacturing of constructions for composite/resin layering.

- REF 0244 faceted pontics
- REF 0245 faceted crowns
- Contents: 120 pieces



## WAX WIRE IN ROLL

Flexible, tension free wax wire in roll is used for making sprue canals. The blue is middle hard and the green is hard quality.

- | blue/middle hard |                 | green/hard |
|------------------|-----------------|------------|
| REF 0252         | wax wire 2,5 mm | REF 0292   |
| REF 0253         | wax wire 3,0 mm | REF 0293   |
| REF 0254         | wax wire 3,5 mm | REF 0294   |
| REF 0255         | wax wire 4,0 mm | REF 0295   |
| REF 0256         | wax wire 4,5 mm | REF 0296   |
| REF 0257         | wax wire 5,0 mm | REF 0297   |
| Contents: 250 g  |                 |            |



## »BLOCK OUT« WAX

Wax for blocking out undercuts of stone models and for model analysing when producing partial denture. High dropping point of 86°C makes wax usable also when duplicating with thermo-reversible duplicating material.

- REF 0186-30 pink-red colour 30 g



## RETENTION PEARLS

Diameters 0.4 and 0.6 mm.

Used for faceting with resin material. During the application care has to be taken to spread the adhesive in fine layer in order to glue the pearls to the wax structure without dipping them into the adhesive. Pearls are applied individually, with wax carver.

- |          |                          |       |
|----------|--------------------------|-------|
| REF 0370 | retention pearls 0.40 mm | 15 g  |
| REF 0371 | retention pearls 0.60 mm | 15 g  |
| REF 0372 | pearl adhesive           | 10 ml |
| REF 0373 | adhesive thinner         | 10 ml |



## UTILITY WAX

Utility wax is used for protecting and preserving the periphery edge in removable prosthetics. The application of utility wax on the impression tray allows a perfect transfer of the periphery edge from the impression onto the model. The wax can be adapted at room temperature and can be used without pre-heating.

- REF 0185 
- Contents: 15 pieces



## PREPARATION WAX



Pink, transparent and flexible wax. It can be well adapted to the master model. Suitable for casted partial dentures, before duplication of models.

Colour: pink - transparent  
Dimension: 120x80 mm

REF 0239	preparation wax soft	0,6 mm
REF 0290	preparation wax soft	0,7 mm
REF 0242	preparation wax hard	0,6 mm

Contents: 15 sheets

## CASTING WAX - STIPPLED AND SMOOTH



Good adaptation on a model and does not tear because of good plastic properties.  
Wax sheets 125x75 mm. Colour: green - transparent

REF 0234	wax foil - stippled	0,35 mm
REF 0235	wax foil - stippled	0,40 mm
REF 0236	wax foil - stippled	0,45 mm
REF 0237	wax foil - stippled	0,50 mm
REF 0238	wax foil - stippled	0,60 mm

REF 0225	wax foil, smooth, soft	0,25 mm
REF 0226	wax foil, smooth, soft	0,30 mm
REF 0227	wax foil, smooth, soft	0,40 mm
REF 0228	wax foil, smooth, soft	0,50 mm
REF 0229	wax foil, smooth, soft	0,60 mm

Contents: 15 sheets

## CASTING WAX STICKS AND PROFILES

Wide choice of diameters offers adequate selection. Optimal mixture of natural waxes provides solid texture of the sticks, necessary for easy laboratory work. Available in two different qualities: middle hard - blue and hard - green. While ordering hard quality add to the REF number letter 'H' (example: REF 0201H).



REF 0201	•	0,7 mm	25 g				
REF 0202	•	0,8 mm	25 g				
REF 0203	•	0,9 mm	25 g				
REF 0204	•	1,0 mm	35 g				
REF 0205	•	1,1 mm	35 g				
REF 0206	•	1,2 mm	35 g				
REF 0207	•	1,3 mm	35 g	REF 0216	⊂	1,8 mm	50 g
REF 0208	•	1,5 mm	50 g	REF 0217	⊂	2,2 mm	50 g
REF 0209	•	2,0 mm	50 g	REF 0218	⊂	3,0 mm	70 g
REF 0210	•	2,5 mm	70 g	REF 0219	⊂	3,5 mm	70 g
REF 0211	•	3,0 mm	75 g	REF 0220	⊂	4,0 mm	70 g
REF 0212	•	3,5 mm	80 g	REF 0221	⊂	1,8 x 1,3 mm	25 g
REF 0213	•	4,0 mm	95 g	REF 0222	⊂	4 x 1,75 mm	65 g
REF 0214	•	4,5 mm	95 g	REF 0223	⊂	4,1 x 2,1 mm	65 g
REF 0215	•	5,0 mm	95 g	REF 0224	⊂	6,5 x 2,5 mm	70 g





## WAX PATTERNS

Preformed clasp patterns used for CoCr partial dentures.

- REF 0740 premolars
- REF 0741 bonyhard clasps
- REF 0742 ring clasps
- REF 0743 molars

Contents: 10 x 20 = 200 clasps



740



741

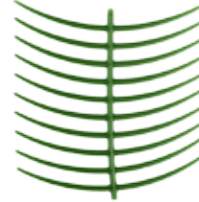

742



743

## WAX GRID RETENTIONS

Retention used for CoCr partial dentures.

- REF 0744 diagonal 10 pcs
- REF 0745 with holes 20 pcs



744

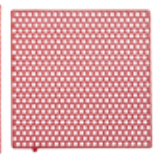

745

## WAX RETENTION

Ensures reliable retention in acrylics.

- REF 0746 oval holes 25 pcs
- REF 0747 round holes 25 pcs

747 746



## MODELLING WAX

For modelling of denture bases and formation of biting edges. Flexible and stable, almost temperature-shrink free.

- REF 0231 thickness 1.5 mm 300 g
- REF 02311 thickness 1.2 mm 300 g
- REF 02312 thickness 1.5 mm 500 g
- REF 02313 thickness 1.2 mm 500 g
- REF 0187 thickness 1.5 mm 500 g **extra hard**

REF 0250 Wax stick, round, pink, diameter 5 mm, for feeding and draining canals in the acrylic systems like IVO-CAP System.



CE



## BASE PLATES

Made of shellac, resistant to deformation and well adaptable to plaster models.



CE

REF 0708	base plates grey	(8 upper, 4 lower)
REF 07083	base plates grey	100 pcs upper
REF 07084	base plates grey	100 pcs lower
REF 0710	base plates pink	(8 upper, 4 lower)
REF 07085	base plates pink	100 pcs upper
REF 07086	base plates pink	100 pcs lower

## WAX BITING EDGES



CE

REF 0230	wax biting edges, hard, arched, red	50 pcs
REF 0262	wax biting edges, middle, arched, pink	50 pcs
REF 0278	wax biting edges, middle, arched, red	50 pcs
REF 0260	wax biting edges, arched, soft pink	50 pcs
REF 0274	wax biting edges, soft, arched, yellow	50 pcs
REF 0264	wax biting edges, ultrasoft, arched, yellow	50 pcs
REF 0258	wax biting edges, hard, straight, red	50 pcs
REF 0261	wax biting edges, middle, straight, pink	50 pcs
REF 0279	wax biting edges, middle, straight, red	50 pcs
REF 0259	wax biting edges, straight, soft pink	50 pcs
REF 0275	wax biting edges, soft, straight, yellow	50 pcs
REF 0263	wax biting edges, ultrasoft, straight, yellow	50 pcs
REF 0265	wax biting edges, hard, arched, red	100 pcs
REF 0266	wax biting edges, middle, arched, pink	100 pcs
REF 0280	wax biting edges, middle, arched, red	100 pcs
REF 0267	wax biting edges, arched, soft pink	100 pcs
REF 0276	wax biting edges, soft, arched, yellow	100 pcs
REF 0268	wax biting edges, ultrasoft, arched, yellow	100 pcs
REF 0269	wax biting edges, hard, straight, red	100 pcs
REF 0270	wax biting edges, middle, straight, pink	100 pcs
REF 0281	wax biting edges, middle, straight, red	100 pcs
REF 0271	wax biting edges, straight, soft pink	100 pcs
REF 0277	wax biting edges, soft, straight, yellow	100 pcs
REF 0272	wax biting edges, ultrasoft, straight, yellow	100 pcs

## STICKY WAX

Comes in shape of blocks or sticks. High adhesive capacity, smear-free. Used for temporary gluing of metal, acrylic or stone particles.



REF 0239-70	wax adhesive in blocks	70 g
REF 02391	wax adhesive in sticks	100 g









DUPLICATING, INVESTING AND CASTING

## GELODOUBLE

Reversible duplicating material used for partial denture, combination work and also suitable for acrylic casting technique. It can be reused for 15-20 times. With Gelodouble duplicating material is possible to achieve high degree of reproduction accuracy even for smallest details because it is elastic, resistant to tearing and has no shrinkage.

Colour: green - transparent  
Hardness (shore): ca. 20 Shore

REF 0920	Gelodouble	pail	6 kg
REF 0944	Gelodouble	pail	2,5 kg



## GELODOUBLE S

Reversible duplicating material used exclusively for duplicating stone. It gives precise casts and does not contract. It needs to be stored at room temperature.

Colour: beig - opaque  
Hardness (shore): ca. 20 Shore

REF 0920S	Gelodouble	pail	6 kg
REF 0944S	Gelodouble	pail	2,5 kg



## INTERDUPLICAST

Addition-curing two component silicon with low viscosity for duplicating models in dental laboratories.

REF 0917	A+B	1+1 kg
REF 0918	A+B	5+5 kg
REF 0919	A+B	10+10 kg

1. compatible with stone and phosphate materials
2. models are easily removed
3. extremely precise and dimension stable
4. high elasticity



## MODELHART SPRAY

Is used for spraying the model after duplicating in silicone. It hardens the model and makes the wax adapt better.

REF 0941	spray	200 ml
----------	-------	--------



## EKOHART

Environment friendly water based dipping hardener for hardening phosphate based investment material for partial dentures after duplicating in gel. 99% biologically degradable. Very good hardening properties for more precise further work.

REF 0947	bottle	1000 ml
----------	--------	---------



## MODELHART

Solvent based dipping hardener for hardening phosphate based investment material for partial dentures after duplicating in gel. Very good hardening properties for more precise further work. The tin should be closed very tightly.

REF 0940	tin	1000 ml
----------	-----	---------



## INTERFINE K+B SPEED

EN ISO 15912

Interfine K+B Speed is a super fine phosphate bonded investment material for crown and bridge technique made of precious or non-precious dental alloys and for pressed ceramics. The material is suitable for speed and conventional heating method. The casting is possible without the use of the casting ring. The expansion of the investment material can be accurately controlled by the use of the Exapol expansion liquid.

Advantages:

- Suitable for speed-heating method even after the investment has hardened and cooled down (up to 24h\* - see instruction for use),
- Exceptionally fine ground particles allow an unbelievably smooth surface of casts,
- Longer bonding time assures enough time for the investment of details (prosthetics over implants, attachments, fixtures like Intralock).

REF 0934 pack 41 sacks á 160 g (6.56 kg)



## INTERVEST K+B SPEED

EN ISO 15912

A fine - grained phosphate bonded graphite-free investment material, suitable for all types of alloys. For speed and conventional heating method. It has long working time and good flowing properties. Surface of metal construction is smooth after casting. Expansion is easily controlled with expansion liquid Exapol. It can be used also without casting ring.

REF 0935 pack 41 sacks á 160 g (6.56 kg)



## INTERPRESS K+B SPEED

EN ISO 15912

Interpress K+B is a super fine, temperature resistant, phosphate bonded investment material for pressed ceramic. The material is suitable for rapid and conventional heating method. The expansion of the investment material can be precisely controlled by using Exapol expansion liquid. It is suitable for all kinds of pressed ceramic.

REF 0931 pack 50 sacks á 100 g (5,00 kg)



## MODELCAST S

EN ISO 15912

Modelcast S is a phosphate bonded investment material for partial dentures, distinguished by its exceptional characteristics. The material is duplicated in silicone and is suitable for conventional and speed-heating method. The expansion of Modelcast S can be accurately controlled by the use of the Expasol expansion liquid.

Advantages:

- Liquid consistency and long bonding time allow enough time for the investment of details (attachments, fixtures like Intralock),
- Fine grained structure allows exceptionally smooth casts,
- Expansion stability guarantees accurate casts,
- The material is suitable for speed-heating method

REF 0933S    pack    30 sacks á 400 g (12.00 kg)



## MODELCAST

EN ISO 15912

Phosphate bonded, graphite-free investment used for partial dentures. It can be duplicated in silicone or gel. It has good flowing properties, relatively long working time and give precise cast. It becomes softer when cooling down and is easy to take the cast out. Expansion is easily controlled with expansion liquid Expasol.

REF 0933    pack    30 sacks á 400 g (12.00 kg)



## EXPASOL

Expasol is universal expansion liquid for investment material Interfine K+B Speed, Intervest K+B Speed, Modelcast S and Modelcast. Avoid replacement of the expansion liquids for fixed and removable prosthetic and lower the cost of the stock by using Expasol.

Frost sensitive.

REF 0937	Expasol	1 l
REF 0937W	Expasol – winter packing	1 l
REF 0938	Expasol	5 l



## INTERCAST LTS

EN ISO 15912

Gypsum based, graphite-free investment for casting precious and Ag-Pd alloys that are not a base for ceramic. It is mixed with distilled water. It is easy to deflask and casted object can be cleaned with brush under the water.

**Warning:** It must not come in contact with phosphate based investments. Use of separate mixing vessels and spoons is recommended.

REF 0930    alu-sack    5 kg



## INTERWAXIT

Cleans greasy wax surfaces and looses surface tension upon the waxing structure.

REF 0413	bottle	200 ml
REF 0432	bottle	1000 ml



## METAL CASTING RINGS, RUBBER CASTING RING SOCLE, FURNACE TONGS

Standard casting ring sizes with long life, made of stainless, fireproof material, tightly fitting into the rubber casting ring socle.



REF 0363	size 1 x
REF 0364	size 3 x
REF 0365	size 6 x
REF 0366	size 9 x
REF 0700	universal rubber casting ring socle
REF 3391D	Furnace tongs 50 cm
REF 3391	Furnace tongs 40 cm

## METAL CASTING RING LINERS

Maintains spacing, allows expansion of investment material and provides precise castings. Retains its dimensions even at high temperatures. Made of  $Al_2O_3$ . Health friendly.



REF 0108	casting ring liners in rolls	10 m
REF 0108-30	casting ring liners in rolls	30 m

## MARKER NOVÝ

Is used for marking casting ring before putting it in the furnace. The mark stay visible after preheating, because it contents incombustible material.



REF 0342	Marker Nový
----------	-------------





## I-BOND 02

I-Bond 02 is biocompatible non-precious nickel-based casting alloy for metal-ceramic dental restorations. I-BOND 02 contains no beryllium, cadmium and lead and fulfills the recommendations of the standards EN ISO 22674 and EN ISO 9693-1. The low Vicker's hardness of 180 (HV 10) leads to good and easy milling and grinding behaviour and gives perfect polished surfaces.

Composition	(Mass-%):	Properties:	
Ni	64,3	Type	3
Cr	24,2	Density	8,2 g/cm <sup>3</sup>
Mo	10	Solidus, liquidus temperature	1250°C, 1340°C
Si	1,0	Casting temperature	1440°C
Co, Fe, Nb	< 1%	Vickers hardness	HV 10 180
		Coefficient of thermal expansion	25 - 500°C 13,9 x 10 <sup>-6</sup> K <sup>-1</sup> 20 - 600°C 14,0 x 10 <sup>-6</sup> K <sup>-1</sup>
		Yield stress	Rp 0,2 330 MPa
		Modulus of elasticity	E aprox. 205.000 MPa
		Elongation	A5 15%



## I-BOND LO

I-BOND LO is biocompatible non-precious nickel-based casting alloy for metal-ceramic dental restorations. I-BOND LO contains no beryllium, cadmium and lead and fulfills the recommendations of the standards EN ISO 22674 and EN ISO 9693-1. The low Vicker's hardness of 250 (HV 10) leads to good and easy milling and grinding behaviour and gives perfect polished surfaces.

Composition	(Mass-%):	Properties:	
Ni	64,4	Type	4
Cr	22	Density	8,3 g/cm <sup>3</sup>
Mo	10	Solidus, liquidus temperature	1200°C, 1280°C
Si	2,1	Casting temperature	1340°C
Nb, B	< 1%	Vickers hardness	HV 10 250
Mn		Coefficient of thermal expansion	25 - 500°C 13,9 x 10 <sup>-6</sup> K <sup>-1</sup> 20 - 600°C 14,1 x 10 <sup>-6</sup> K <sup>-1</sup>
		Yield stress	Rp 0,2 427 MPa
		Modulus of elasticity	E aprox. 144.000 MPa
		Elongation	A5 8,5%



## I-BOND NF

I-BOND NF is biocompatible non-precious cobalt-based casting alloy for metal-ceramic dental restorations. I-BOND NF contains no nickel, beryllium, cadmium and lead and fulfills the recommendations of the standards EN ISO 22674 and EN ISO 9693-1. The relatively low Vicker's hardness of 285 (HV 10) leads to good and easy milling and grinding behaviour and gives perfect polished surfaces.

Composition	(Mass-%):	Properties:	
Co	63	Type	4
Cr	24	Density	8,3 g/cm <sup>3</sup>
W	8	Solidus, liquidus temperature	1304°C, 1369°C
Mo	3	Casting temperature	1470°C
Si	1,0	Vickers hardness	HV 10 285
Nb	< 1%	Coefficient of thermal expansion	25 - 500°C 13,9 x 10 <sup>-6</sup> K <sup>-1</sup> 20 - 600°C 14,0 x 10 <sup>-6</sup> K <sup>-1</sup>
		Yield stress	Rp 0,2 490 MPa
		Modulus of elasticity	E aprox. 210.000 MPa
		Elongation	A5 10%



## I-GW

Non precious nickel-based dental casting alloy for all-cast crowns and bridges veneered with composite. Contains no Beryllium, Cadmium and lead. Not for metal to ceramic restoration. It meets the correspondence to EN ISO 22674.

REF 1716 1000 g  
REF 1717 500 g  
REF 1718 250 g



CE 0197

Composition	(Mass-%):	Properties:		
Ni	63,5	Type	3	
Cr	26	Density	8,2 g/cm <sup>3</sup>	
Mo	8	Solidus, liquidus temperature	1200°C, 1250°C	
Si	1,5	Casting temperature	1370°C	
Fe	1,4	Vickers hardness	HV 10	190
		Yield stress	Rp 0,2	355 MPa
		Modulus of elasticity	E	aprox. 190.000 MPa
		Elongation	A5	10%

## I-MG

I-MG I-MG is biocompatible cobalt-based casting alloy for partial dentures without beryllium, nickel, cadmium and lead. I-MG can be polished and laser welded. It meets the correspondence to EN ISO 22674.

REF 1706 1000 g  
REF 1707 500 g  
REF 1708 250 g



CE 0197

Composition	(Mass-%):	Properties:		
Co	62,5	Type	5	
Cr	29,5	Density	8,2 g/cm <sup>3</sup>	
Mo	5,5	Solidus, liquidus temperature	1295°C, 1345°C	
Si	1,4	Casting temperature	1450°C	
Mn, N	< 1%	Vickers hardness	HV 10	365
C		Tensile Strength	960 MPa	
		Yield stress	Rp 0,2	640 MPa
		Modulus of elasticity	E	aprox. 220.000 MPa
		Elongation	A5	7,5%

## I-MG HE

I-MG HE is biocompatible cobalt-based casting alloy for partial dentures without beryllium, nickel, cadmium and lead, with a high degree of elasticity for repeated activation of the clasps. It has outstanding resistance to corrosion and high strength. I-MG HE can be well polished and laser welded. It meets the correspondence to EN ISO 22674.

REF 1725 1000 g  
REF 1726 500 g



CE 0197

Composition	(Mass-%):	Properties:		
Co	63,5	Type	5	
Cr	29,1	Density	8,2 g/cm <sup>3</sup>	
Mo	5	Solidus, liquidus temperature	1300°C, 1330°C	
Si	1,3	Casting temperature	1450°C	
Mn, N	< 1%	Vickers hardness	HV 10	aprox. 355
C		Tensile Strength	Rm	941 MPa
		Yield stress	Rp 0,2	687 MPa
		Modulus of elasticity	E	aprox. 200.000 MPa
		Elongation	A5	6,9%



## I-MG FH

I-MG FH is biocompatible cobalt-based casting alloy for partial dentures without beryllium, nickel, cadmium and lead. I-MG FH can be polished and laser welded. It meets the correspondence to EN ISO 22674.

REF 1709 1000 g  
REF 1710 500 g  
REF 1711 250 g

Composition	(Mass-%):	Properties:	
Co	62,5	Type	5
Cr	30,0	Density	8,2 g/cm <sup>3</sup>
Si	1,0	Solidus, liquidus temperature	1260°C, 1320°C
Mn	1,0	Casting temperature	1450°C
C	< 1%	Vickers hardness	HV 10 370
Mo	5,0	Tensile Strength	Rm 920 MPa
		Yield stress	Rp 0,2 620 MPa
		Modulus of elasticity	E aprox. 220.000 MPa
		Elongation	A5 6,5%



CE0197

## I-MG EKO

Non precious alloy for partial denture base.

I-MG EKO is Co-Cr-Mo partial denture alloy without Beryllium and Nickel. It has outstanding resistance to corrosion and high strength. I-MG EKO can be polished and laser welded. It fulfills the recommendation of EN ISO 22674.

REF 1719 1000 g  
REF 1720 500 g  
REF 1721 250 g

Composition	(Mass-%):	Properties:	
Co	34,0	Type	5
Cr	30,0	Density	8,1 g/cm <sup>3</sup>
Fe	28,0	Solidus, liquidus temperature	1290°C, 1340°C
Mo	5,0	Casting temperature	1440°C
Mn	1,2	Vickers hardness	HV 10 335
Si	1,3	Tensile Strength	Rm 950 MPa
C, N	< 1%	Yield stress	Rp 0,2 660 MPa
		Modulus of elasticity	E aprox. 220.000 MPa
		Elongation	A5 6,5%



CE0197

## INTERSOLDER

EN ISO 9333

Rods for soldering Co-Cr alloys used with soldering paste Interflux, Ø 2mm.

Soldering temperature: 1320°C  
Melting Interval: 1071 - 1260°C

Composition:  
Co 62%; Cr 29%; Mo 4%; Si 3%; C, Mn, Fe <1%

REF 0495 5 g



CE0197

## I-WELD

Co-Cr wire for laser soldering.

Composition:  
Co 65,5%; Cr 28,0%; Mo 5,5%; Si, Mn, C <1%

REF 0497 thickness 0,50 mm 2 m  
REF 0498 thickness 0,35 mm 2 m



CE0197



## INTERFLUX

Paste for soldering CoCr and NiCr alloys.



REF 0496 80 g

## ELEKTROLYT MG

Liquid for electrolytic polishing of Co-Cr alloys.



REF 0490 1000 ml

## GRAPHITE RETORTS AND INSERTS

For melting of precious dental alloys in reduced atmosphere.

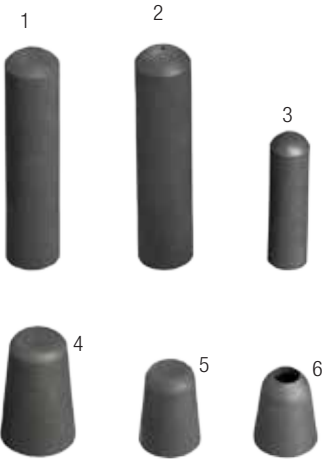

1	REF 0425	graphite retort for Hereaus CLG 2002	10 pcs
2	REF 0421	graphite retort for Degussa, ZC	10 pcs
3	REF 0422	graphite retort for Hereaus CLG	10 pcs
4	REF 0423	graphite insert for Bego Fornax and Intercast 60	6 pcs
5	REF 0427	graphite insert for Izodent	6 pcs
6	REF 0862	graphite insert for Vacuumcast 90	6 pcs

## MELTING CRUCIBLES

For melting of non-precious and precious dental alloys.



1	REF 0437	Krupp Globucast Table Castomat	6 pcs
2	REF 0436	Krupp Globucast 2000	6 pcs
3	REF 0435	Bego Fornax and Intercast 60	6 pcs
4	REF 0446	Manfredi	6 pcs
5	REF 0447	Bego, open flame	1 pcs
6	REF 0444	Degussa, open flame	1 pcs
7	REF 0443	Izodent	6 pcs
8	REF 0426	Manfredi with graphite	6 pcs

## SCOOP FOR DENTAL ALLOY

REF 0866 scoop for dental alloy 1 pcs





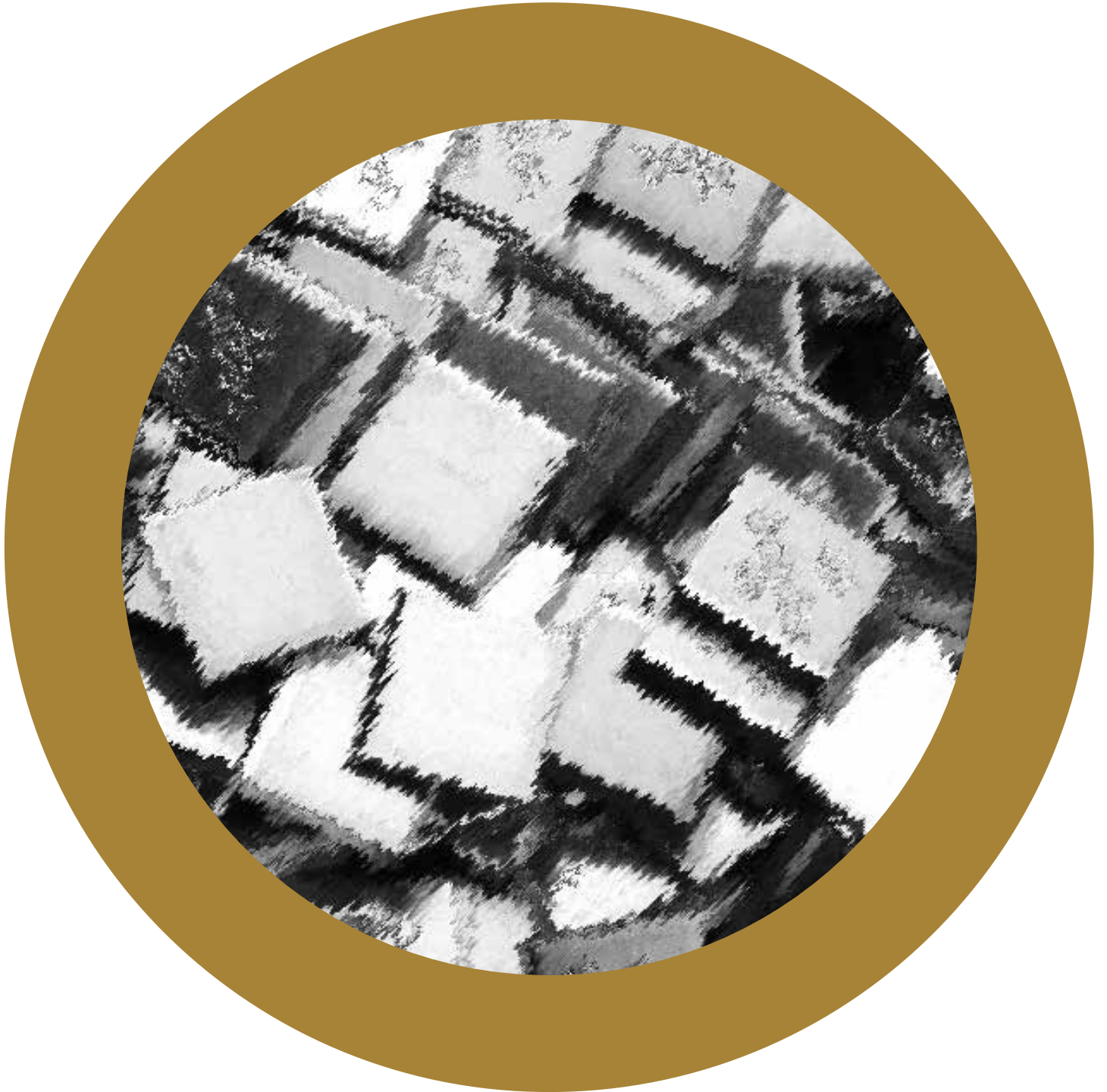

## PRECIOUS METAL ALLOYS



## INTERPAL

EN ISO 22674

Precious alloy, containing 5% of gold for casting teeth coatings and bridgework of all types. It contains 0.1% of Iridium which forms a thin microstructure, facilitates treating and polishing of the surface and improves alloy's corrosion resistance and resistance to overheating when casting.

REF 902 1 g

### Properties:

Colour	white
Melting range	940-1020°C
Softening	15 min. at 950°C / quench in water
Hardening	15 min. at 600°C / air
Pre-heating temperature	750°C (30-60°C at end temperature, depending on the size and number of rings)
Casting temperature	1200°C (Graphite crucible resp. at open flame with ceramic crucible)
Heating after melting	electric: 20-30s
	inductive: 5-10s
	flame: 5-10s
Density	10.8 g/cm <sup>3</sup>
Investment material	Intercast LTS or Intervest K+B Speed or Interfine K+B Speed
Solder	Universal solder 770

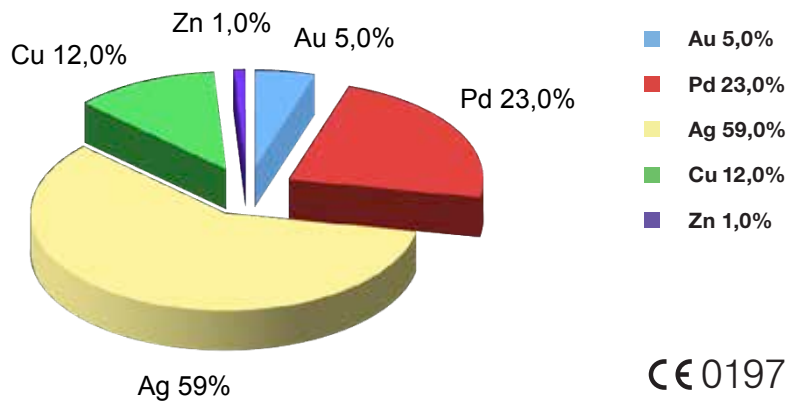

Precious alloy, containing 2% of gold for casting teeth coatings and bridgework of all types. It is resistant against corrosion, simple to handle and polish.

REF 902SE 1 g

Properties:	
Colour	white
Melting range	975-1050°C
Softening	15 min. at 750°C / quench in water
Hardening	15 min. at 400°C / air
Pre-heating temperature	750°C (30-60°C at end temperature, depending on the size and number of rings)
Casting temperature	1200°C (Graphite crucible resp. at open flame with ceramic crucible)
Heating after melting	electric: 20-30s
	inductive: 5-10s
	flame: 15-20s
Density	10.7 g/cm <sup>3</sup>
Investment material	Intercast LTS or Interinvest K+B Speed or Interfine K+B Speed
Solder	Universal solder 770

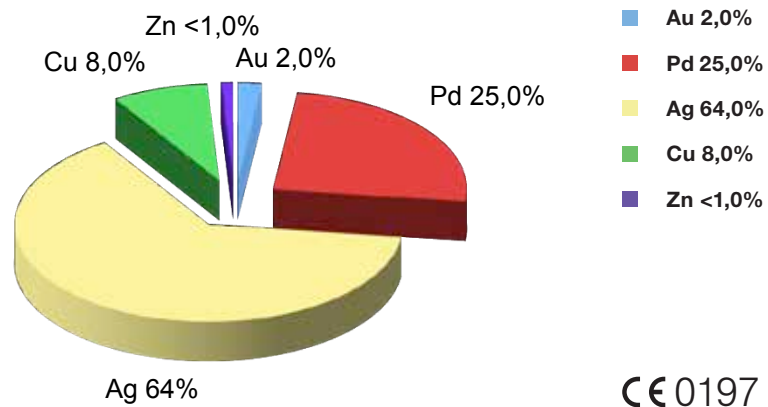

## INTERPAL S

EN ISO 22674

Precious alloy, containing 10,5% of gold for casting teeth coatings and bridgework of all types. It is resistant against corrosion, simple to handle and polish.

REF 902S 1 g

### Properties:

Colour	white
Melting range	920-1057°C
Softening	20 min. at 750°C /quench in water
Hardening	20 min. at 380°C / air
Pre-heating temperature	750°C (30-60°C at end temperature, depending on the size and number of rings)
Casting temperature	1200°C (Graphite crucible resp. at open flame with ceramic crucible)
Heating after melting	electric: 15-20s inductive: 5-10s flame: 15-20s
Density	11,2 g/cm <sup>3</sup>
Investment material	Intercast LTS or Intervest K+B Speed or Interfine K+B Speed
Solder	Universal solder 770

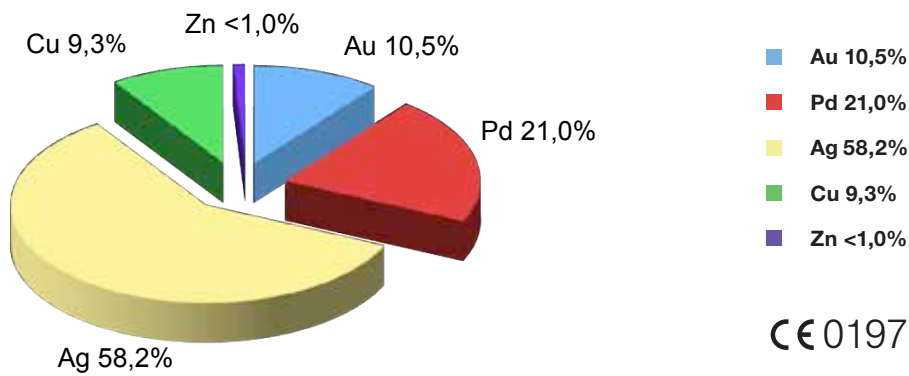



# ACRYLICS

## LOWER LINGUAL BARS

Anatomic shape, arched, in three sizes, with fabricated retention.  
Made of stainless steel.

REF 0324	7 cm
REF 0325	8 cm
REF 0326	9 cm
Contents:	10 pcs



CE 0197

## CLASP WIRE

Round in diameter, made of stainless, spring hardened steel for orthodontic and prosthetic purposes. Retains its shape and does not break.

REF 0306	Ø 0,6 mm	3 m	REF 0306-40	Ø 0,6 mm	40 m
REF 0307	Ø 0,7 mm	3 m	REF 0307-30	Ø 0,7 mm	30 m
REF 0308	Ø 0,8 mm	3 m	REF 0308-20	Ø 0,8 mm	20 m
REF 0309	Ø 0,9 mm	3 m	REF 0309-10	Ø 0,9 mm	10 m
REF 0310	Ø 1,0 mm	3 m	REF 0310-10	Ø 1,0 mm	10 m
REF 0311	Ø 1,1 mm	3 m	REF 0311-10	Ø 1,1 mm	10 m
REF 0312	Ø 1,2 mm	3 m	REF 0312-10	Ø 1,2 mm	10 m



CE 0197

## REINFORCING NET

Gold plated net, 0.4 mm thick, improves adhesion of acrylics and reinforces dental base.

REF 0352 reinforcing net



CE

## DENTURE FLASK

Four piece set, made of brass. Convenient shape for easy disassembling and removal of stone. To be used in hydraulic press. Interior space can accommodate larger models.

REF 0337 denture flask



## FLASK CARRIER

Made of stainless steel. Used for simple handling of flasks in and out of the water and for rinsing of wax from flasks.



REF 3372 flask carrier stainless steel

## ISOACRYL

Insulation liquid on alginate base, used for separating of stone from acrylics and stone from stone. Dries rapidly, drip-proof, leaves very fine coat on the stone.

REF 0409	Isoacryl blue	200 ml
REF 0391	Isoacryl red	200 ml
REF 0390	Isoacryl blue	500 ml
REF 0392	Isoacryl red	500 ml



## INTERACRYL HOT

Acrylic resin for rapid heat-curing procedure, type 1, class 1.

Interacryl Hot is a heat-curing, cadmium-free, methyl methacrylate-based artificial material, supplied in form of polymer (powder) and monomer (liquid). In compliance with the international standard EN ISO 20795-1.

Indications:

- full dentures
- partial dentures

- Colour 3 = pink transparent
- Colour 5 = heavy opaque pink
- Colour 10 = pink transparent with veins
- Colour 15 = opaque pink with veins
- Colour 16 = opaque pink without veins



CE 0197



REF 1505	Interacryl Hot - powder, colour 3,	1000 g
REF 1564	Interacryl Hot - powder, colour 5,	1000 g
REF 1504	Interacryl Hot - powder, colour 10,	1000 g
REF 1580	Interacryl Hot - powder, colour 15,	1000 g
REF 1593	Interacryl Hot - powder, colour 16,	1000 g
REF 1561	Interacryl Hot - powder, colour transparent,	1000 g
REF 1506	Interacryl Hot - liquid	500 ml
REF 0391	Isoacryl red	200 ml
REF 1540	measuring beaker	
REF 1539	measuring vessel for powder	
REF 1543	flat brush	
REF 1544	silicone vessel	
REF HWN 260-15	mixing spoon	

REF 1503	Interacryl Hot - powder-liquid set, colour 3	Contents of the set: powder 1000 g and liquid 500 ml
REF 1570	Interacryl Hot - powder-liquid set, colour 5	Contents of the set: powder 1000 g and liquid 500 ml
REF 1502	Interacryl Hot - powder-liquid set, colour 10	Contents of the set: powder 1000 g and liquid 500 ml
REF 1581	Interacryl Hot - powder-liquid set, colour 15	Contents of the set: powder 1000 g and liquid 500 ml
REF 1592	Interacryl Hot - powder-liquid set, colour 16	Contents of the set: powder 1000 g and liquid 500 ml
REF 1560	Interacryl Hot - powder-liquid set, transparent	Contents of the set: powder 1000 g and liquid 500 ml





## INTERACRYL CAST

Acrylic for pouring technique, type 2, class 2.

Interacryl Cast is self-curing cadmium-free methyl methacrylate based artificial material, supplied as polymer (powder) and monomer (liquid).  
In compliance with the international standard EN ISO 20795-1.

Indications:

- completion of casted partial removable dentures
- relining of dentures
- extension of dentures
- pouring technique in prosthetics (f.e. Gelcast system)



CE0197

Contents of the set:

Interacryl Cast - powder 350 g and Interacryl Cast - liquid 250 ml

REF 1572	Interacryl Cast - set, colour 5	
REF 1516	Interacryl Cast - set, colour 3	
REF 1515	Interacryl Cast - set, colour 10	
REF 1584	Interacryl Cast - set, colour 15	
REF 1594	Interacryl Cast - set, colour 16	
REF 1518	Interacryl Cast - powder, colour 3	350 g
REF 1569	Interacryl Cast - powder, colour 5	350 g
REF 1517	Interacryl Cast - powder, colour 10	350 g
REF 1582	Interacryl Cast - powder, colour 15	350 g
REF 1595	Interacryl Cast - powder, colour 16	350 g
REF 1519	Interacryl Cast - liquid	250 ml
REF 1549	Interacryl Cast - powder, colour 3	1000 g
REF 1568	Interacryl Cast - powder, colour 5	1000 g
REF 1548	Interacryl Cast - powder, colour 10	1000 g
REF 1583	Interacryl Cast - powder, colour 15	1000 g
REF 1596	Interacryl Cast - powder, colour 16	1000 g
REF 1550	Interacryl Cast - liquid	500 ml

- Colour 3 = pink transparent
- Colour 5 = heavy opaque pink
- Colour 10 = pink transparent with veins
- Colour 15 = opaque pink with veins
- Colour 16 = opaque pink without veins

## GELCAST SISTEM

Used for making upper and lower total prosthesis with acrylic pouring technique.

REF 0946	Gelcast set (Interacryl Cast, colour 3)
REF 0948	Gelcast set (Interacryl Cast, colour 5)
REF 0945	Gelcast set (Interacryl Cast, colour 10)
REF 0949	Gelcast set (Interacryl Cast, colour 15)
REF 0979	Gelcast set (Interacryl Cast, colour 16)

Set contents:

REF 0929	Gelcast flask	
REF 0923	canal cutter	
REF 0922	teeth holder	
REF 0920	Gelodouble 6 kg	
REF 1516	Interacryl Cast set colour 3 (350 g + 250 ml)	or
REF 1572	Interacryl Cast set colour 5 (350 g + 250 ml)	or
REF 1515	Interacryl Cast set colour 10 (350 g + 250 ml)	or
REF 1584	Interacryl Cast set colour 15 (350 g + 250 ml)	or
REF 1594	Interacryl Cast set colour 16 (350 g + 250 ml)	



## POLYMERISATION UNIT

Equipped with pressure gauge, air valve, safety valve and relief valve. Used for polymerisation of self-curing acrylics – Interacryl Cold, Interacryl Ortho, Interacryl Cast and Interacryl Plast.

Specifications:

Contents	5 l
Max. pressure	2.5 bar/55°C

REF 0603



## INTERACRYL COLD



Acrylic for denture repairs, type 2, class 1.

Interacryl Cold is a self-curing, cadmium-free, methyl methacrylated based artificial material, supplied as polymer (powder) and monomer (liquid).  
Interacryl Cold complies with the international standard EN ISO 20795-1.

Indications:

- repair of full and partial dentures
- relining of dentures
- extension of dentures

- Colour 3 = pink transparent  
 Colour 5 = heavy opaque pink  
 Colour 10 = pink transparent with veins  
 Colour 15 = opaque pink with veins  
 Colour 16 = opaque pink without veins

Contents of the set:

Interacryl Cold - powder 100 g and Interacryl Cold - liquid 100 ml

REF 1508	Interacryl Cold - set, colour 3	
REF 1571	Interacryl Cold - set, colour 5	
REF 1507	Interacryl Cold - set, colour 10	
REF 1588	Interacryl Cold - set, colour 15	
REF 1512	Interacryl Cold - powder, colour 3	100 g
REF 1567	Interacryl Cold - powder, colour 5	100 g
REF 1511	Interacryl Cold - powder, colour 10	100 g
REF 1585	Interacryl Cold - powder, colour 15	100 g
REF 1590	Interacryl Cold - powder, colour 16	100 g
REF 1514	Interacryl Cold - liquid	100 ml
REF 1510	Interacryl Cold - powder, colour 3	350 g
REF 1566	Interacryl Cold - powder, colour 5	350 g
REF 1509	Interacryl Cold - powder, colour 10	350 g
REF 1586	Interacryl Cold - powder, colour 15	350 g
REF 1597	Interacryl Cold - powder, colour 16	350 g
REF 1562	Interacryl Cold - powder, transparent	350 g
REF 1513	Interacryl Cold - liquid	250 ml
REF 1546	Interacryl Cold - powder, colour 3	1000 g
REF 1565	Interacryl Cold - powder, colour 5	1000 g
REF 1545	Interacryl Cold - powder, colour 10	1000 g
REF 1587	Interacryl Cold - powder, colour 15	1000 g
REF 1591	Interacryl Cold - powder, colour 16	1000 g
REF 1547	Interacryl Cold - liquid	500 ml

## INTERACRYL ORTHO



Acrylic material for orthodontics, type 1.

Interacryl Ortho is a cold-curing, cadmium-free, methyl methacrylated polymer (powder) and monomer (liquid).  
Interacryl Ortho complies with the international standard EN ISO 20795-2.

Indications:

- orthodontic appliances

Powder is transparent.

Colours of liquid: transparent, pink, red, blue, green, yellow.

REF 1525 INTERACRYL ORTHO - set

Contents of the set:

REF 1526	Interacryl Ortho - powder	1000 g
REF 1533	Interacryl Ortho - liquid, transparent	100 ml
REF 1534	Interacryl Ortho - liquid, pink	100 ml
REF 1535	Interacryl Ortho - liquid, red	100 ml
REF 1536	Interacryl Ortho - liquid, blue	100 ml
REF 1537	Interacryl Ortho - liquid, green	100 ml
REF 1538	Interacryl Ortho - liquid, yellow	100 ml
REF 1541	sprayer	
REF 1542	pipette	
REF 1527	Interacryl Ortho - liquid, transparent	500 ml
REF 1528	Interacryl Ortho - liquid, pink	500 ml
REF 1529	Interacryl Ortho - liquid, red	500 ml
REF 1530	Interacryl Ortho - liquid, blue	500 ml
REF 1531	Interacryl Ortho - liquid, green	500 ml
REF 1532	Interacryl Ortho - liquid, yellow	500 ml



## INTERACRYL PLAST

Acrylic material for individual impression trays.

Interacryl Plast is a cold-curing artificial cadmium-free methyl methacrylate based artificial material, supplied as polymer (powder) and monomer (liquid). Interacryl Plast is easy to model and stick-free. Yellow colour provides fair contrast to the impression materials.

Indications:

- fabrication of individual impression trays.

REF 1520	Interacryl Plast - set	
Contents of the set:		
REF 1522	Interacryl Plast - powder	1000 g
REF 1524	Interacryl Plast - liquid	250 ml
REF 1523	Interacryl Plast - liquid	500 ml



CE

## INTERLUX

Interlux is suitable for polymerization of light-polymerized materials which polymerize in wavelength of 350 - 400 nm.

Technical data:	Dimension (height /width/length):	100/219/255 mm
	Voltage:	230 V / 50 Hz
	Power:	36 W

REF 0715 Interlux



## LC INTERTRAY

Light polymerized tray polymerizes under UV light in wavelength of 350 - 400 nm and halogen light in wavelength of 420 - 480 nm.

REF 0714 upper large 50 pcs



CE

## FLASK CLAMP - INOX

Simple use, for one or two flasks. Flasks with clamps are inserted into the press.

REF 0338 clamp for one flask, stainless steel  
REF 3382 clamp for two flasks, stainless steel



## INTERLABOSIL

Interlabosil C-silicon system has been developed specifically for use in dental laboratory. It is recommended for over cast when finishing partial dentures with acrylics, for protection of teeth by heat polymerisation of acrylic dentures, can be used for precise bite registration. No separating liquid is required when the material is in direct contact with acrylic resin.

Colour	light pink
Mixing ratio	100 g putty / 1-1,6 g catalyst
Mixing time	30 sek
Working time	1.3 min
Setting time	5 min
Shore hardness(24 hours)	95 sh.A
Linear retraction (24 hours)	0.2 %

REF 0925 Interlabosil 1,5 kg  
REF 0926 Interlabosil 4 kg  
REF 0928 Interlabosil 10 kg  
REF 0927 Interlabosil catalyst in paste 60 g





## SANDBLASTING AND FINISHING

## CUTTING / SEPARATING / GRINDING DISCS AND HEATLESS STONES

### 1 CUTTING/SEPARATING DISCS

REF 0357	22x0,2 mm	20 pcs
REF 0357-100	22x0,2 mm	100 pcs
REF 0362	25x0,7 mm	20 pcs
REF 0362-100	25x0,7 mm	100 pcs
REF 0367	22x0,6 mm	20 pcs
REF 0367-100	22x0,6 mm	100 pcs
REF 0389	22x0,38 mm	20 pcs
REF 0389-100	22x0,38 mm	100 pcs



1

### CUTTING DISCS:

2 REF 0359	35x0,7 mm	20 pcs
REF 0359-100	35x0,7 mm	100 pcs
REF 0361	37x1,0 mm	20 pcs
REF 0361-100	37x1,0 mm	100 pcs
REF 0368	32x1,0 mm	20 pcs
REF 0368-100	32x1,0 mm	100 pcs
REF 0369	35x1,0 mm	20 pcs
REF 0369-100	35x1,0 mm	100 pcs
REF 0374	40x0,6 mm	20 pcs
REF 0374-100	40x0,6 mm	100 pcs
REF 0375	40x1,0 mm	20 pcs
REF 0375-100	40x1,0 mm	100 pcs



2

### CUTTING DISCS REINFORCED:

3 REF 0358	40x1 mm	20 pcs
------------	---------	--------



3

### GRINDING DISCS:

4 REF 0360	22x3,0 mm	20 pcs
REF 0360-100	22x3,0 mm	100 pcs
REF 0376	32x1,6 mm	20 pcs
REF 0376-100	32x1,6 mm	100 pcs
REF 0377	32x2,2 mm	20 pcs
REF 0377-100	32x2,2 mm	100 pcs
REF 0378	35x1,7 mm	20 pcs
REF 0378-100	35x1,7 mm	100 pcs
REF 0379	35x3 mm	20 pcs



4

### HEATLESS-SPECIAL:

5 REF 0463	19 x 2 mm
REF 0464	19 x 3 mm
REF 0465	19 x 4 mm
REF 0466	22 x 2 mm
REF 0467	22 x 3 mm
REF 0468	22 x 4 mm
REF 0469	16 x 2 mm for Dentists
REF 0470	16 x 3 mm for Dentists
REF 0471	16 x 4 mm for Dentists



5

Pack / 50 pcs





## INTERALOX



Snow white, high quality pure corundum (99,96%  $Al_2O_3$ ), for sandblasting of precious and non-precious alloy casts and ceramics.

REF 0404	Interalox	250 $\mu$	REF 04041	Interalox	250 $\mu$
REF 0399	Interalox	150 $\mu$	REF 03991	Interalox	150 $\mu$
REF 0405	Interalox	110 $\mu$	REF 04051	Interalox	110 $\mu$
REF 0406	Interalox	50 $\mu$	REF 04061	Interalox	50 $\mu$
Contents: 7 kg			Contents: 28 kg		

## GLASS PEARLS



Glass pearls are intended to be used for oxide sand-blasting in the inner crown parts after ceramic firing, for fitting secondary telescopes and for sand-blasting fire-resistant material at pressed ceramic works.

REF 0479	glass pearls	50 $\mu$
REF 0480	glass pearls	150 $\mu$

Contents: 7 kg

## PUMICE

Volcanic rock, neatly cleaned, perfect for polishing of acrylics in dental prosthetics.



REF 0407	pail	4 kg
REF 0408	pail	14 kg





## POLISHING PASTE FOR METAL

High quality polishing paste for dry pre-polish and polishing of different dental alloys.

REF 0456	polishing paste for pre-polish of Ag-Pd alloys	160 g
REF 0457	polishing paste for pre-polish of Au-alloys	150 g
REF 0458	polishing paste for high gloss of Ag-Pd alloys	160 g
REF 0459	polishing paste for high gloss of Au-alloys	150 g
REF 0460	polishing paste for CrCoMo alloys	170 g



## DIAMOND POLISHING PASTE

Polishing paste for high - gloss of precious alloys, non-precious alloys, telescopic and conical crowns, attachment work, ceramic and composites.



REF 0461 diamond polishing paste 40 g

## UNIVERSAL POLISHING PASTE



REF 0462 universal polishing paste Unilesk 100 g

## POLISHING FELTS

1	REF 0813	felt cone	50 x 25 mm
2	REF 08121	felt cone	50 x 20 mm
3	REF 0812	felt cone	40 x 20 mm
4	REF 0811	felt cone	30 x 15 mm
5	REF 0815	felt wheel	50 x 10 mm
6	REF 0814	felt lens	50 x 10 mm



## BRUSHES FOR POLISHING MACHINE

Made of natural, environment-friendly materials, with wooden core.

1	REF 0804	deerskin polishing brush - 7 layers
2	REF 0807	felt wheel Ø 70 mm - 4 layers
	REF 0808	felt wheel Ø 70 mm - 6 layers
3	REF 0802	cotton polishing brush
4	REF 0801	horsehair polishing brush Ø 80 mm - triple fold
5	REF 0800	horsehair polishing brush Ø 50 mm - single fold



## POLISHING SET FOR COMPOSITE



REF 0830 Polishing set for composite

HP bristle white Ø 15	1 pcs
HP bristle black Ø 15	1 pcs
HP leather Ø 19 -5	1 pcs
HP goat hair white Ø 17	1 pcs
HP goat hair grey Ø 17	1 pcs
HP goat hair (pencil)	1 pcs
HP polisher wheel	2 pcs
HP polisher cone	2 pcs

## BRUSHES FOR MICROMOTOR

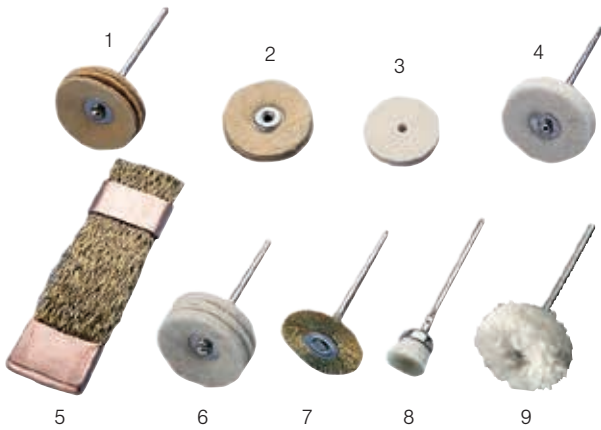

1	REF 0809	deerskin polishing brush, Ø 25 mm, for handpiece - 5 layers
2	REF 0817	deerskin polishing brush, Ø 25 mm - 5 layers, unmounted
3	REF 0816	felt wheel brush, Ø 21 x 3 mm, unmounted
4	REF 8101	felt wheel brush, Ø 21 x 3 mm, for handpiece
5	REF 0803	drill cleaning brass brush thin
	REF 0803D	drill cleaning brass brush thick
6	REF 0810	felt wheel brush, Ø 25 mm, for handpiece - 3 layers
7	REF 0805	brass brush Ø 23 mm, for handpiece
	REF 0818	horsehair brush Ø 23 mm, for handpiece
8	REF 0806	horsehair hard brush, oval, for handpiece
9	REF 0819	cotton, Ø 23 mm, for handpiece
Contents: 6 pcs		

## EMERY CLOTH IN ROLL



REF 0820	emery cloth	120 abrasive
REF 0821	emery cloth	180 abrasive
REF 0822	emery cloth	280 abrasive
REF 0823	emery cloth	400 abrasive

Contents: 50 m











## CERAMICS ACCESSORIES

## MICRO ADJUSTABLE PEGS FOR CERAMICS

Firing trays for ceramic with very thin sleeves which can be individually adjusted. Particularly suitable for short crown.

REF 6044	for molar with 4 pins	6 pcs
REF 6045	for premolar with 2 pins	8 pcs



## ROTATING GLASS PLATE FOR MIXING CERAMICS

Rotating glass plate for mixing different kinds of ceramic powders and stains. Plastic cover protects ceramic powders against drying.

REF 0502	rotating glass plate
----------	----------------------



## INTERCERAMIC

The stone-ceramic insulating agent prevents the ceramics from sticking onto the stone die during the application of ceramics. Since it is not greasy, it does not cause any problems in the burning process.

REF 0397	15 ml
----------	-------



## CERAMIC SET

REF 0690 Ceramic Set

Contents:

- Glass spatula
- Separating file
- Modelling instrument
- Modelling instrument
- Agate spatula
- Separator
- Pean curved
- Brush for smoothing ceramic
- Brush 1 for ceramic, Kolinsky
- Brush 4 for ceramic, Kolinsky
- Brush 8 for ceramic, Kolinsky
- Brush for opaquer



## BRUSHES FOR CERAMIC

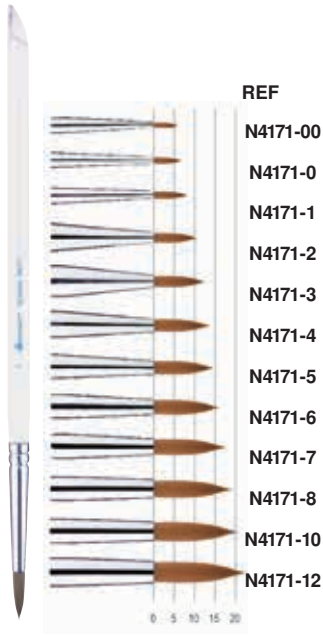

- REF
- N4171-00
  - N4171-0
  - N4171-1
  - N4171-2
  - N4171-3
  - N4171-4
  - N4171-5
  - N4171-6
  - N4171-7
  - N4171-8
  - N4171-10
  - N4171-12

SYNTHETIC

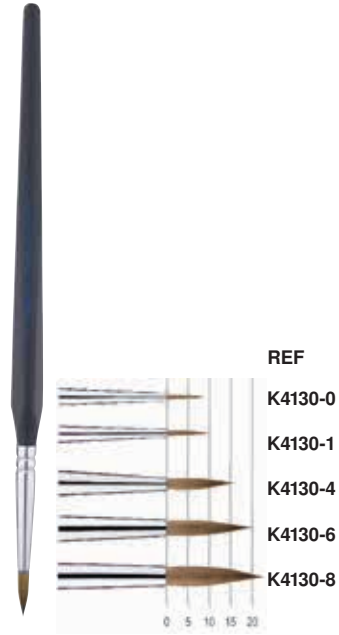

- REF
- K4130-0
  - K4130-1
  - K4130-4
  - K4130-6
  - K4130-8

NATURAL - KOLINSKY

Brush is made of best quality of Sibirien marten hairs which are very elastic. Brush tips are shaped as fine as a needle and have good absorption properties. Handle form assure excellent hold.

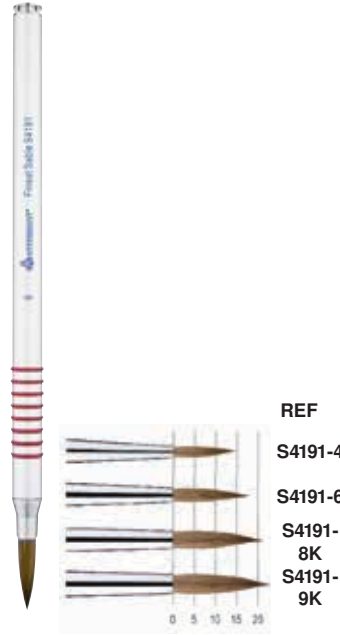

- REF
- S4191-4
  - S4191-6
  - S4191-8K
  - S4191-9K

NATURAL – FINEST SABLE (BRUSHES NO. 8 AND 9 ALSO POSSIBLE WITH BALL)

Brush is made from natural hair - sable. Due to their good water storage the brush hair cater the right water consistency of the ceramic work.

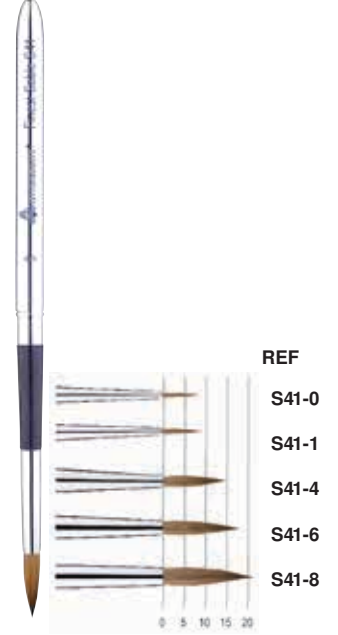

- REF
- S41-0
  - S41-1
  - S41-4
  - S41-6
  - S41-8

NATURAL WITH COVER – FINEST SABLE

### BRUSH FOR SMOOTHING CERAMIC



REF A06-C

### BRUSH FOR ISOLATING LIQUIDS



REF A01

### BRUSH FOR OPAQUER



REF SB32-F0

### BRUSH FOR WAX



REF A06-V





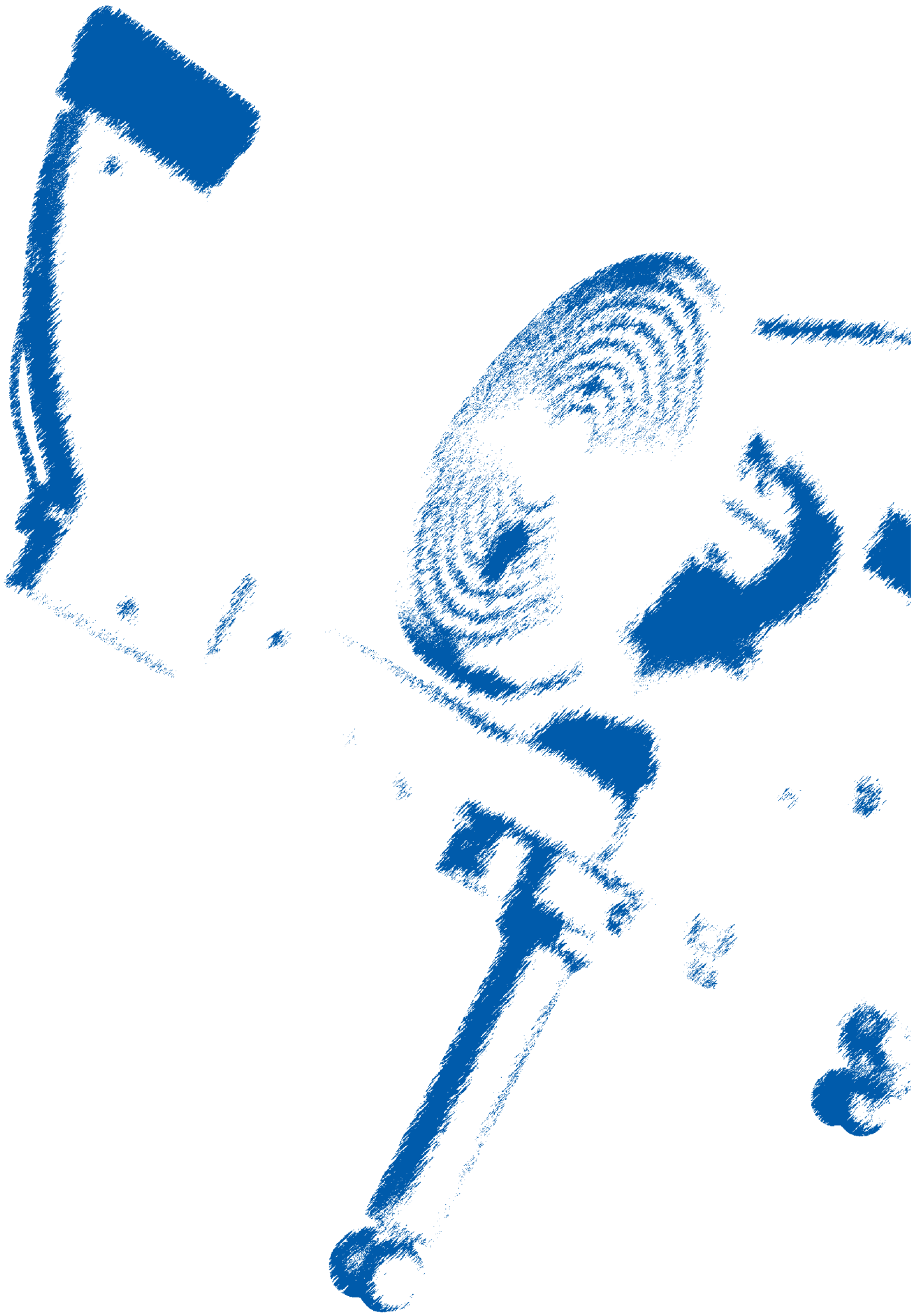



# EQUIPMENT

## V-MIX VACUUM MIX

Highly productive vacuum mixer with microprocessor control, designed for mixing of investments, stone and silicone.

Advantages:

- simple and ergonomic handling,
- only power supply connection is needed for its operation,
- benchtop or wall mounted version,
- Programmable time for the operating cycle:
  - Preliminary vacuum
  - Mixing vacuum
  - Vacuum after mixing



### Technical data

Power supply	220/230 V, 50 Hz
Power consumption	260 rpm
Vacuum pump Capacity	20/ min
Vacuum pump Controlled vacuum	- 0,93 Bar
Preliminary vacuum	0 - 20 s
Mixing vacuum	0 - 250 s
Vacuum after mixing	0 - 10 s
Weight (without bowls)	10,1 kg
Dimensions (L/B/H)	310/210/330 mm
Bowl size	250, 550, 835 or 1200 ml

- REF 0679 V-Mix Vacuummix with mixing bowl 550 ml
- REF 0694 Mixing bowl 250 ml
- REF 0697 Mixing bowl 550 ml
- REF 0698 Mixing bowl 835 ml
- REF 0699 Mixing bowl 1200 ml
- REF 0696 Stand for V-Mix Vacuummix

## INTERDRILL SYSTEM

Compact and ergonomic device for precise mechanical positioning and drill revolution regulation which is adaptive to all kinds of systems for models preparation by drill movement revolution and has automatic switching on system and dust reduction system.

Advantages:

- the laser system provides you with a precise marker on the model and excellent visibility in bright light background,
- deepnes of the hole can be adjusted with drill, optional regulation of drilling speed,
- automatic switching on system of the motor without disturbing your work,
- foldable support of the unit makes it handy for carriage and storage and comfortable even in a sitting position while working,
- dusting system makes your working environment more comfortable,
- dust container is integrated in the working table and it is handy for removal and cleaning.

### Technical data

Power supply	220 V $\pm$ 10% / 50 Hz
Max power	100 W
Max drill revolutions	4000 min <sup>-1</sup>
Collet diameter	$\varnothing$ 3 mm
Drill regulating movement	12 mm
Laser class	3
Dimensions (height, width, depth)	160/157/410 mm
Weight	5 kg



- REF 0680 Interdrill system
- REF 0318 Pin drill 2.0 mm

## INTERSAW

Model saw for parallel sawing of plaster models, equipped with a model table for easier handling, lightened working area and with a sawing area marking laser.

Advantages:

- additional model table with a good grip of the working area for easier sawing of the model from the front or the back side,
- optional connection with a sawdust extraction system,
- working area light and a sawing area marking laser,
- one of the smallest and lightest model saws on the market.

### Technical data

Power supply	220/230 V, 50 Hz
Output power	70 W
Speed	6000 rpm
Diamond saw blade diameter	63 do 80 mm
Blade spacers diameter	13, 16, 18, 20, 22 mm
Cut width	0,2 do 0,3 mm
Cutting depth	17 do 25,5 mm
Dimensions (height, width, depth)	275/160/260 mm
Weight	6,6 kg



- REF 0682 Intersaw, model table and diamond blade (75 mm)



## DEGETHERM PREHEATING FURNACE

Degetherm microprocessor-controlled preheating furnace for dental laboratories. It has microprocessor-controlled temperature regulation with digital display. 9 individual programs can be set. It has a possibility of setting desired time of closing the program.

## DEGETHERM EASY PREHEATING FURNACE

Preheating furnace for dental laboratories. Final temperature, heating rate and linear of heating rate can be set. Saving the programs is not possible.

- Maximum capacity of the heating compartment:
  - Degetherm lab4 (for 4 metal casting rings)
  - Degetherm lab6 (for 6 metal casting rings)
  - Degetherm lab9 (for 9 metal casting rings)
- Program heating rate, linear heating rate: 1 to 10°C in minute.



### Technical data

DEGETHERM		lab4	lab6	lab9
REF		0673	0674	0675
DEGETHERM EASY		Easy4	Easy6	Easy9
REF		0670	0671	0672
Dimensions	Height (mm)	500	520	540
	Width (mm)	380	420	450
	Depth (mm)	340	380	430
Heating chamber	Height (mm)	110	130	150
	Width (mm)	150	200	250
	Depth (mm)	150	200	230
Rated voltage		230 V; 50 Hz		
Power at rated voltage		2,1 kW	2,6 kW	3,0 kW
Max. temperature		1150°C		
Weight		28 kg	32 kg	35 kg



## VACUUMCAST 90

Ergonomics, high tech and quality casts!

Semi-automatic benchtop vacuum pressure-casting unit with high melting frequency for the casting of Co-Cr-Mo, Ni-Cr-Mo, and precious alloys.

Prednosti:

- low floor space consumption in the laboratory,
- integrated water cooling system,
- no need for additional purchase of ceramic casting crucibles, metal casting ring liners, metal casting rings or rubber casting ring socle,
- no alloy contamination,
- economic and optimal consumption of dental alloy,
- dental alloy remains do not contain oxides due to vacuum melting,
- quality, non-porous casts,
- simple removal of the cast from the casting ring,
- exceptionally simple handling of the unit.



Technical data	
Mains voltage	220 V±10%, 50 Hz
Max. supply power	3000 VA
Current protection	16 A
Protective water temperature in the refrigerator	60 °C
Overheating protection	90 °C
Air pressure safety valve	11 bar
Max. number of castings	10
(1 h cooling needed after last casting operation)	
Melting time	approx. 60 sec
Volume of metal in the crucible	2 – 70 g (2 – 90 g)
Distilled water tank	approx. 5 l
Air pressure	3.5 bar
Unit dimensions (height/width/depth)	360/300/370 mm
Weight	20 kg

REF 0860



REF 0858



REF 0861



REF 0851-0854/0857



REF 0855



REF 0856



### REF 0686 Vacuumcast 90 PROFI

Contents: Vacuumcast 90 unit, casting ring 1, casting ring 3, casting ring 6, casting ring 9, standard casting ring stand, graphite insert á 6, silicone paste 15 ml, large casting ring stand, jumbo casting ring, partial dentures casting ring Ø 80, partial dentures casting ring Ø 90, partial dentures casting ring stand, crucible production form

### REF 0687 Vacuumcast 90 STANDARD

Contents: Vacuumcast 90 unit, casting ring 1, casting ring 3, casting ring 6, casting ring 9, standard casting ring stand, graphite insert á 6, silicone paste 15 ml, partial dentures casting ring Ø 80, partial dentures casting ring Ø 90, partial dentures casting ring stand, crucible production form

### REF 0688 Vacuumcast 90 BASIC

Contents: Vacuumcast 90 unit, casting ring 1, casting ring 3, casting ring 6, casting ring 9, standard casting ring stand, silicone paste 15 ml

### REF 0851

Vacuumcast ring 1

### REF 0852

Vacuumcast ring 3

### REF 0853

Vacuumcast ring 6

### REF 0854

Vacuumcast ring 9

### REF 0855

Vacuumcast standard casting ring stand

### REF 0856

Vacuumcast big casting ring stand

### REF 0857

Vacuumcast ring jumbo

### REF 0858

Vacuumcast partial denture ring Ø 80

### REF 0859

Vacuumcast partial denture ring Ø 90

### REF 0860

Vacuumcast partial denture ring stand

### REF 0861

Vacuumcast crucible production form

### REF 0862

Vacuumcast graphite insert, á6

### REF 0863

Vacuumcast silicone paste 15 ml

### REF 0864

Vacuumcast silicone paste 45 ml

### REF 0865

Vacuumcast pressure regulator+filter





## INTERCAST 60A



REF 0660

Casting machine for centrifugal casting with inductive high frequency melting of the alloy. Designed for casting CoCr, NiCr and precious alloys. An integrated water cooling system.

Technical data	
Power supply	220 V±10% / 50Hz
Max. Power consumption	3 kW
Min. alloy quantity in the crucible	7 g
Max. alloy quantity in the crucible	80 g
Crucible material	ceramics
Crucible material when casting precious alloys	ceramics with graphite insertion
Max. Time for full melting of 30g alloy	60s
Cooling	closed system, water, integrated
HF power rating adjustment when melting Ni-Cr-Co alloys or precious alloys	manual
Motor acceleration adjustment	manual
Unit dimensions (height/width/depth)	1060/620/660 mm
Weight	120 kg

## PLASTER TRAP

Technical data	
Height, diameter	320 mm, 340 mm
Drain height	245 mm
Drain diameter	50 mm
Volume	14 l
Supply connection	1½ cole, fi 28 mm
Weight	2,1 kg

Plaster trap with a closed 4-chamber cleaning system, transparent collector inlaid with foil and fast closing. Transparency tank allows you to visually control the amount of sludge. With an foil input the tank can be quickly and easily cleaned.



Lead the supply tube into the highest chamber.



In cleaning release the screw on the drain and unscrew the locking lid. Skim the standing water and pull out the input.



Remove the pipe-fitting from the drain.



Tie the foil collector under the drain opening and remove it.



REF 0620

Plaster trap

## MOBILE DENTAL LABORATORY LAMP



Ergonomic dental laboratory lamp with possibility to regulate the height (distance) and direction of lightness. It can be mounted also on existing working bench. It lightened the working surface of dental technician very equally. Lamp includes two plug boxes for small units, which are positioned on working bench.

REF 0650L mobile dental laboratory lamp – pillar left  
REF 0650 mobile dental laboratory lamp – pillar right

Technical data	
max. height	73 cm
wattage	55 W
luminous flux	4300 lm
Ra (CRI)	93
colour temperature	6500°K
lifetime	15000 h





## DENTAL LABORATORY EQUIPMENT

Design and technical characteristics are following the highest requests of working procedures and ergonomics in dental laboratory. It is made of standard elements, which suits different dimensions and constructions in space.

### There are some advantages:

#### Working tabletop

For different thermal, mechanical, chemical and optical demands.

Material:

- Ultrapas
- Mediapan
- Beech
- Kerrock (Composite)
- OP panel plate protected with ABS tape

#### Front side and outside plates

MDF plate, each side varnished in 3-layers, thickness 16 mm.  
Panel plate 19mm protected with ABS plate (2 mm).

#### Inside plates and the bottom

Panel-plate, 120 g foil, thickness 19 mm.

#### Socle

Could be made of mediapan loaded with rubber or Kerrock or protected natural wood.

#### Back side

MDF plate, each side varnished in 3-layers, thickness 16 mm.  
Panel plate 19 mm protected with ABS plate (2 mm)

#### Drawers

Panel plate, guide drawer Blum tandem, partial haul, soft closing, possibility of plastic inserts.

#### Mountings

Blum hinges with integrated shock absorber for soft closing, 3 D settings.

#### Varnishing

3-layers, 1st layer polyester, 2nd and 3rd layer polyurethane, resistant to cleaning and disinfecting agent and mechanical damages.

#### Colours

Individual upon RAL colour scale

#### Handles

Metal or artificial material (composite)

#### Suction unit

Manual or automatic start. The volume of 64-66 dBA.

#### Ecology

No material contents formaldehydes.



Single workbench TM 1, working bench made of varnished beech.  
Working place for one technician with suction unit, gas and air-installation .

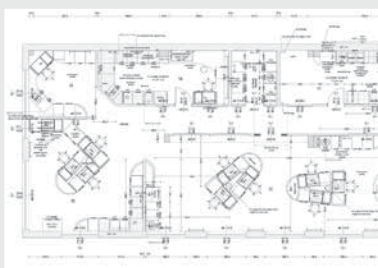

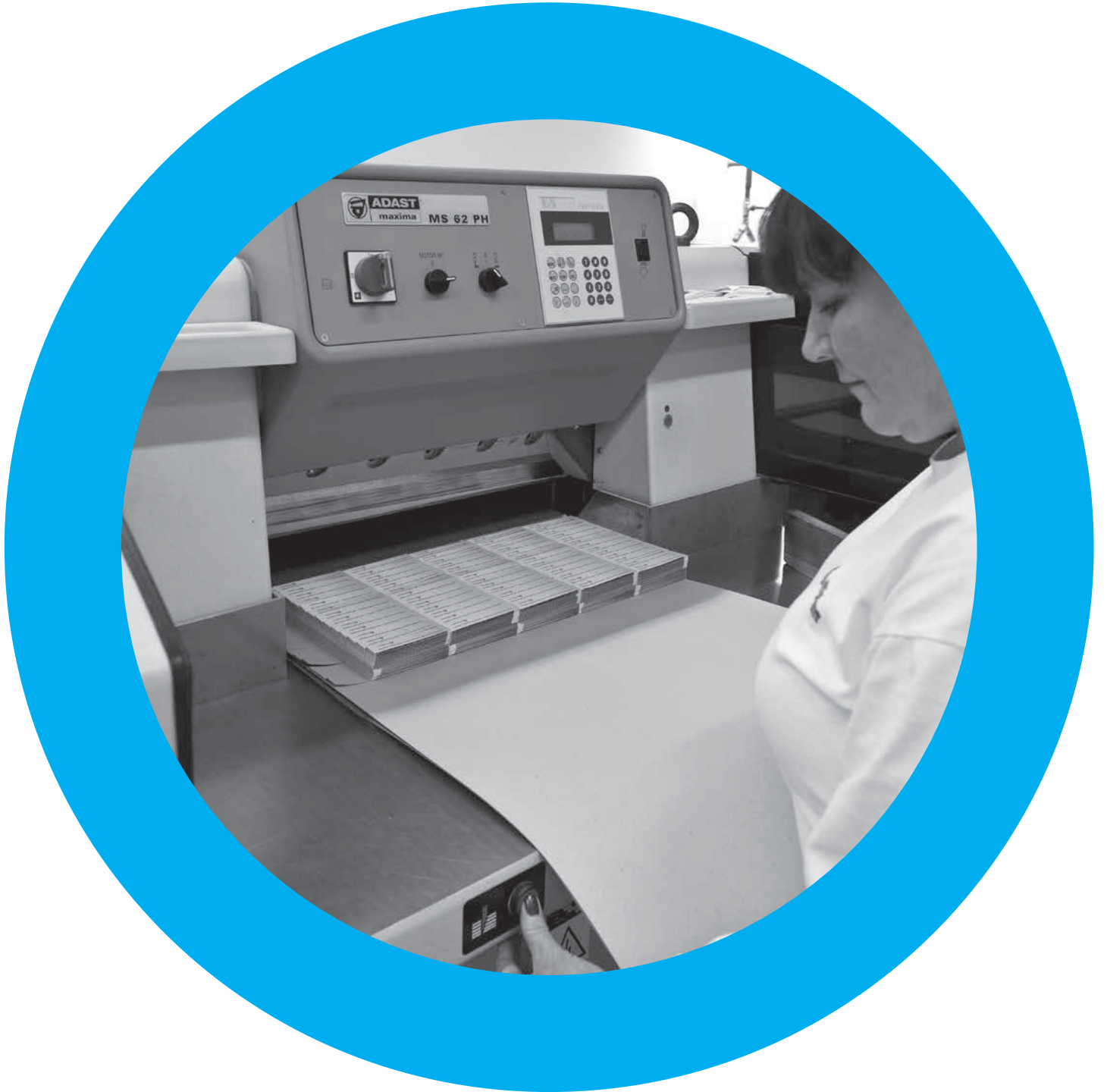

## DENTAL SURGERY ACCESSORIES

## ARTICULATING PAPER

ARTICULATING PAPERS 80 micrones

Used for determining occlusion and articulation disturbances of natural teeth or prosthetic appliances in dental surgeries and laboratories.

REF 0100	articulating paper, blue, 12 pads of 10 sheets
REF 0101	articulating paper horseshoe, blue, 6 pads of 10 sheets
REF 0102	articulating paper, blue-red, 12 pads of 10 sheets
REF 0103	articulating paper horseshoe, blue-red, 6 pads of 10 sheets
REF 1001	articulating paper, red, 12 pads of 10 sheets
REF 1002	articulating paper horseshoe, red, 6 pads of 10 sheets



CE

## OCCUSION SPRAY

For marking the contact points on prosthetic items on the master model in dental laboratory and finished prosthetic works in dental surgery.

REF 092	red	75 ml
REF 093	green	75 ml



CE

## MODELING WAX - EXTRA HARD

The wax is hard and breakable at room temperature but soft and adapted at the temperature above 40°C. It is suitable for taking bite registration and also for waxing - up in removable prosthetic, especially in warm places.



CE

REF 0187    thickness 1,5 cm    500g

## WAX HORSESHOE FOR BITE REGISTRATION

Reinforced with gauze from entirely natural wax.

REF 0243    wax horseshoe for bite registration

Contents: 20 horseshoes



CE



## ABRASIVE AND POLISHING STRIPS

Used for polishing and smoothing approximal fillings.

CE



REF 4193	green	30 μ	10 m roll
REF 4194	blue	40 μ	10 m roll
REF 4195	white	60 μ	10 m roll

## GLASS PLATE

For cement mixing.  
Dimensions: 11 x 7.5 cm



REF 0500	thickness 0,8 cm
REF 0501	thickness 0,4 cm

## MATRIX

CE



- 1 REF 03201 ivory matrix, small
  - 2 REF 03211 ivory matrix, molar
  - 3 REF 0321 ivory matrix, premolar
  - 4 REF 0320 ivory matrix, molar
- Thickness: 0.035 mm, Contents: 12 pcs

- 5 REF 03154 ribbon matrix 4 mm, 25 pcs
  - 6 REF 0315 ribbon matrix roll 5 mm, 10 m length
  - 7 REF 03146 ribbon matrix roll 6 mm, 10 m length
  - 8 REF 0314 ribbon matrix 7 mm, 25 pcs
- Thickness: 0.035 mm

Polyester matrix used for the formation of superior dental arch fillings.

- 9 REF 0451 polyester matrix 6 x 80 mm
- 10 REF 0420 polyester matrix 8 x 80 mm
- REF 0452 polyester matrix 10 x 80 mm

Contents: 100 pcs

## INTERDENTAL WEDGES

Perfect as a protective buffer for wedging of interdental papilla and alignment of matrix towards the point of contact. Made of hard wood and painted with permanent and harmless colours.

CE



- REF 0115 Interdental wooden wedges, set
- REF 0116 Interdental wooden wedges, orange 1
- REF 0117 Interdental wooden wedges, yellow 2
- REF 0118 Interdental wooden wedges, red 3
- REF 0119 Interdental wooden wedges, blue 4
- REF 0120 Interdental wooden wedges, green 5
- REF 0121 Interdental wooden wedges, white 6

Contents: 100 pcs



## ALGINATE REMOVER

Efficiently removes the remains of alginate from impression trays, containers and mixing spatulas.

REF 0418     alginate remover

Contents: 700 g



## WAX PINS

Extremely adaptable, cone-shaped, in three sizes, with metal needle for easy registration of root canal impression.



REF 0246     30 various wax pins and 10 metal needles

## ROOT POSTS

Made of stainless steel, cone-shaped. Used as a temporary post for temporary crowns and bridges.



REF 0323     5 pcs of small + 5 pcs of large root posts

## INLAY WAX

Natural wax for making impression of roots. Elastic, middle hard wax with dropping point 57°C contains no inorganic material and burns out without residues.

REF 02392     Inlay wax     24 pcs





## SALIVA EJECTORS

Saliva ejectors can be adapted to any type of aspirator. The special characteristics of the metallic centre ensure a safe and stable form. The special finish on the filter part give it a complete rounded shape, without any sharp surfaces, while it also decreases the sucking up of the mucous membrane, thus making sure that the patient will suffer no irritation or pain.



CE

REF 0709 saliva ejectors transparent 15 cm lenght

Contents: 100 pcs

## DENTAL ROLLS

They are made of very good absorb material, white colour, 35 mm length and 11 mm diameter. They can be sterilized.



CE

REF 0721 dental rolls cellulose 250 g

## SURGICAL WIRE FOR CAMBA BLOCK

Soft surgical wire made of stainless steel for fixation of broken jaw.



CE 0197

REF 0313	0,4 mm	3 m
REF 0313-30	0,4 mm	30 m
REF 0316	0,5 mm	3 m
REF 0316-30	0,5 mm	30 m

## THERMO PLATE

Mechanically regulated temperature in range 30°C - 60°C with accuracy  $\pm 0.5$  °C. Heating plate is made of PTFE material, that prevent adhering wax to plate. It is suitable for use in dental praxis for heating wax horseshoes for bite registration and for dental laboratories, for heating foils, modeling wax, biting edges.



REF 0616 Thermo plate





## PREPARATION OF WORKING MODELS

**7**

INTERROCK New Type IV	8	ARTICULATOR ARTI-LITE II	10	DOWEL PINS, DOWEL PINS FIXATOR, POINTED DOWEL PINS	12
INTERSTONE New Type IV	8	OCCLUDATORS	10	TWIN PINS	13
INTERDUR Tip III	8	FACEBOW	10	RAPID ADHESIVE	13
BLUE STONE Type III / YELLOW STONE Type III	9	THE HARDNESS OF INTERDENT STONES AND PLASTERS AFTER 24 HOURS IN MPa	11	PACKAGE FOR PLASTER MODELS	13
ORTHOPLASTER	9	SMALL PATTERN SAW WITH SPARE BLADES	12	EASY Form System	14
ARTIPLASTER	9	RETAINING RINGS	12	EASY-Form System - instructions for use:	15
ALABASTER	10				

## MODELLING

**17**

THERMOTOP	18	OCCLUSAL WAX	20	UTILITY WAX	22
INTERFILM	18	MILLING WAX	20	PREPARATION WAX	23
SPACING VARNISH, THINNER	18	MODELLING AND PRESS WAX	20	CASTING WAX - STIPPLED AND SMOOTH	23
INTERFOIL SYSTEM	18	GNATHOLOGICAL SET OF WAXES	20	CASTING WAX STICKS AND PROFILES	23
THERMOTOP SET	18	UNIVERSAL WAX	20	WAX PATTERNS	24
DIPPING WAX	18	WAX SEMI-PRODUCTS	21	WAX GRID RETENTIONS	24
THERMO KNIFE	19	WAX SEMI-PRODUCTS	21	WAX RETENTION	24
WAX CENTER	19	WAX SEMI-PRODUCTS	22	MODELLING WAX	24
CORRECTIVE WAX	19	WAX WIRE IN ROLL	22	BASE PLATES	25
CERVICAL WAX	19	»BLOCK OUT« WAX	22	WAX BITING EDGES	25
MODELLING WAX	20	RETENTION PEARLS	22	STICKY WAX	25

## DUPLICATING, INVESTING AND CASTING

**27**

INTERDUPLICAST	28	EXPASOL	30	I-MG	33
EKOHART	28	INTERCAST LTS	30	I-MG HE	33
MODELHART SPRAY	28	INTERWAXIT	30	I-MG FH	34
GELODOUBLE	28	METAL CASTING RINGS,		I-MG EKO	34
GELODOUBLE S	28	RUBBER CASTING RING SOCLE, FURNACE TONGS	31	INTERSOLDER	34
MODELHART	28	METAL CASTING RING LINERS	31	I-WELD	34
INTERFINE K+B SPEED	29	MARKER NOVY	31	INTERFLUX	35
INTERVEST K+B SPEED	29	I-BOND 02	32	GRAPHITE RETORTS AND INSERTS	35
INTERPRESS K+B SPEED	29	I-BOND LO	32	MELTING CRUCIBLES	35
MODELCAST S	30	I-BOND NF	32	SCOOP FOR DENTAL ALLOY	35
MODELCAST	30	I-GW	33	ELEKTROLYT MG	35

## PRECIOUS METAL ALLOYS

**37**

INTERPAL	38	INTERPAL SE	39	INTERPAL S	40
----------	----	-------------	----	------------	----

## ACRYLICS

**41**

LOWER LINGUAL BARS	42	INTERACRYL HOT	43	INTERACRYL PLAST	46
CLASP WIRE	42	INTERACRYL CAST	44	INTERLUX	46
REINFORCING NET	42	GELCAST SISTEM	44	FLASK CLAMP - INOX	46
DENTURE FLASK	42	POLYMERISATION UNIT	44	LC INTERTRAY	46
FLASK CARRIER	43	INTERACRYL COLD	45	INTERLABOSIL	46
ISOACRYL	43	INTERACRYL ORTHO	45		

## SANDBLASTING AND FINISHING

**47**

CUTTING / SEPARATING / GRINDING DISCS AND HEATLESS STONES	48	POLISHING PASTE FOR METAL	50	POLISHING SET FOR COMPOSITE	51
INTERALOX	49	DIAMOND POLISHING PASTE	50	BRUSHES FOR MICROMOTOR	51
GLASS PEARLS	49	POLISHING FELTS	50	EMERY CLOTH IN ROLL	51
PUMICE	49	BRUSHES FOR POLISHING MACHINE	50		
		UNIVERSAL POLISHING PASTE	50		

## CERAMICS ACCESSORIES

**53**

MICRO ADJUSTABLE PEGS FOR CERAMICS	54	CERAMIC SET	54	BRUSHES FOR CERAMIC	55
ROTATING GLASS PLATE FOR MIXING CERAMICS	54	BRUSH FOR SMOOTHING CERAMIC	55	BRUSH FOR ISOLATING LIQUIDS	55
INTERCERAMIC	54	BRUSH FOR OPAQUER	55	BRUSH FOR WAX	55

## EQUIPMENT

**57**

V-MIX VACUUM MIX	58	DEGETHERM EASY PREHEATING FURNACE	59	MOBILE DENTAL LABORATORY LAMP	61
INTERDRILL SYSTEM	58	VACUUMCAST 90	60	DENTAL LABORATORY EQUIPMENT	62
INTERSAW	58	INTERCAST 60A	61		
DEGETHERM PREHEATING FURNACE	59	PLASTER TRAP	61		

## DENTAL SURGERY ACCESSORIES

**63**

ARTICULATING PAPER	64	MATRIX	65	SALIVA EJECTORS	67
OCCLUSION SPRAY	64	INTERDENTAL WEDGES	65	DENTAL ROLLS	67
WAX HORSESHOE FOR BITE REGISTRATION	64	ALGINATE REMOVER	66	SURGICAL WIRE FOR CAMBA BLOCK	67
MODELING WAX - EXTRA HARD	64	WAX PINS	66	THERMO PLATE	67
ABRASIVE AND POLISHING STRIPS	65	INLAY WAX	66		
GLASS PLATE	65	ROOT POSTS	66		



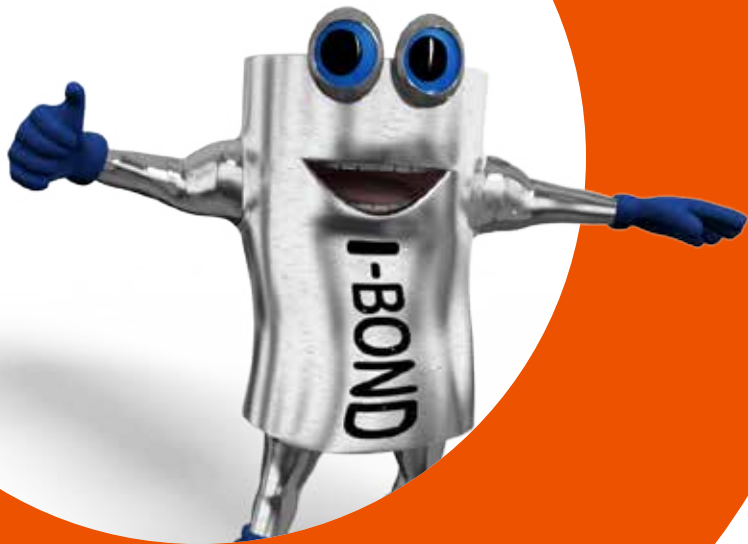

INTERDENT d.o.o.  
Opekarniška cesta 26 · 3000 CELJE · SLOVENIJA  
T: +386 (0)3 425-62-00 · F: +386 (0)3 425-62-02  
E: [info@interdent.cc](mailto:info@interdent.cc) · [www.interdent.cc](http://www.interdent.cc)