

2019 | 2020

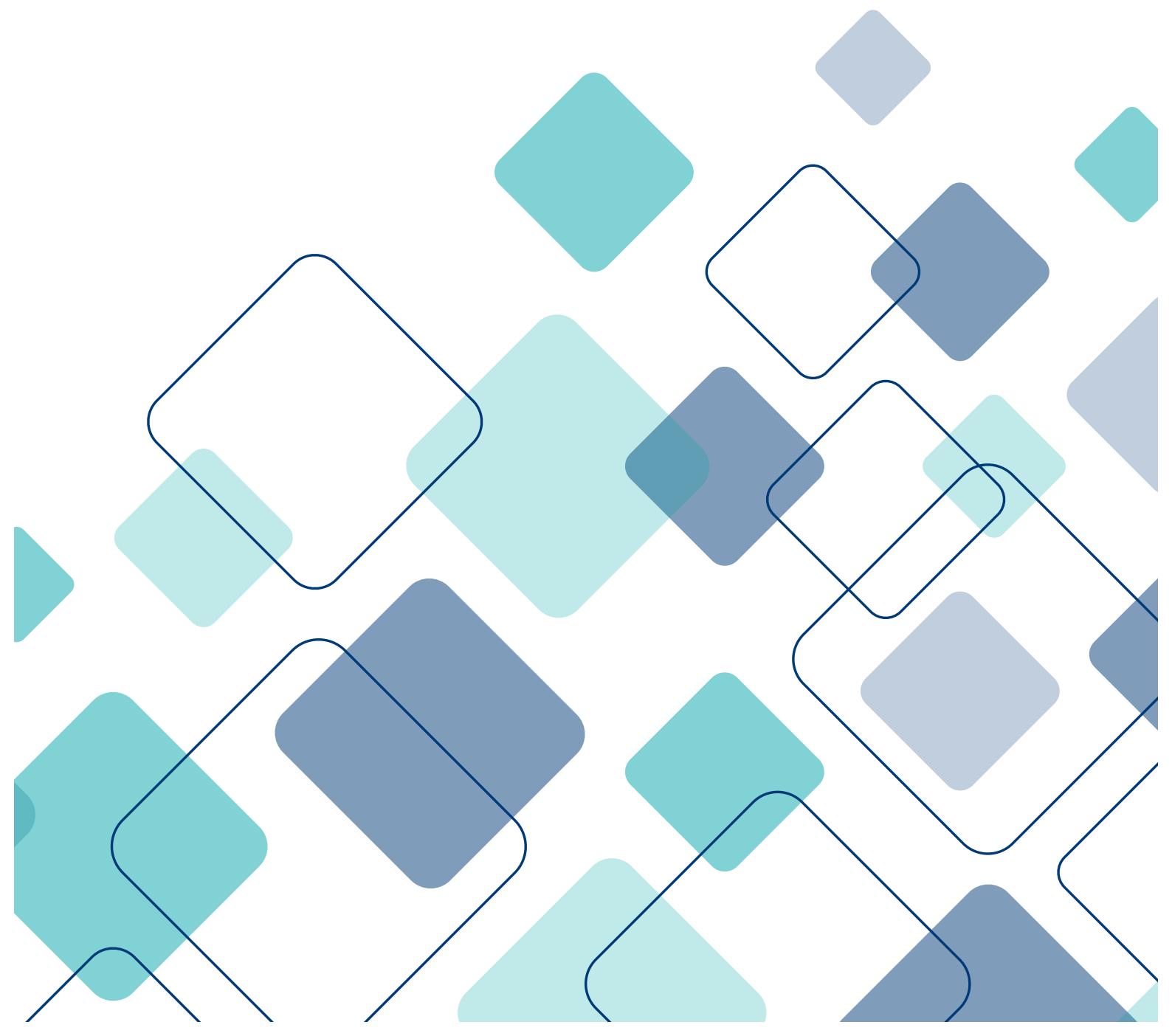

Dental Products

for Dentists & Laboratories





Impression Materials

| | |
|------------------------------------|-------|
| Addition-curing silicones..... | 6–12 |
| Tissue Management..... | 13 |
| Bite registration materials | 14 |
| Condensation-curing silicones..... | 15–16 |
| Alginates..... | 17 |

Disinfectant Materials

| | |
|---|-------|
| Surface disinfection | 20–23 |
| Instruments disinfection..... | 24–25 |
| Hand disinfection..... | 26 |
| Hands cleansing..... | 27 |
| Disinfection of dental suction systems / Cleaner..... | 28 |
| Impression disinfection..... | 29 |
| Spittoon bowl disinfection / Orange cleaner..... | 30 |
| Accessories | 30 |

Laboratory Materials

| | |
|--|-------|
| Technical silicones for esthetic dentistry | 32 |
| Duplicating silicones..... | 33 |
| High-tech Lab-silicones..... | 34–35 |
| Light curing resin for 3D-print..... | 36 |
| Light curing modelling resin / | 37 |
| Light curing trays / plates | |
| Technical aids | 38 |

With the publication of this catalogue (1st of March 2019), all previous catalogues are invalidated. Errors and misprints excepted. Subject to modifications of form, technology, equipment and illustrations as a result of continuous development. Copyright Müller-Omicron GmbH & Co. KG, Lindlar. Reprinting, copying or duplication of any kind, even of excerpts, is prohibited without the permission of Müller-Omicron.

Top quality at fair prices – Made in Lindlar, Germany

Since its founding in 1961, Müller-Omicron, a medium-sized, family-run business, has specialized in the development, production and distribution of dental and prosthetic materials. The company has three main product groups with a large depth of product range – precision impression materials / Technical silicones, disinfectants and light curing materials. All of the products are developed and produced in Germany under the strictest of quality standards as defined in EN ISO 13485:2016.

Users from round the world in nearly 70 countries are already benefiting from the outstanding convenience of use, high safety standards and the cost effectiveness of our products. By constructing a new company building housing the latest logistical technologies and expanded R&D and production capacity Müller-Omicron is establishing a foundation for its next steps into the future: Increased innovation power, shorter development cycles, faster availability of both newer and still existing products for the domestic and international markets.





The needs of our customers remain our focus no matter what we are working on, so that we can deliver products that have a maximum benefit. That is what moves us and drives us – to search for, find and implement new solutions.



Your partner with highest competence in:

- ▶ Impression
- ▶ Disinfection
- ▶ Lab-silicones
- ▶ Light curing materials
(3D-Print, gel, plates)

Member of the Association of German Dental Manufacturers (VDDI)



Aqium[®] 3D

Perfected
the Impression.



Ideally matched characteristics for perfect impressions

The individual components are optimally co-ordinated with the others regarding the important hydrophilic properties, ultimate tensile strength, elongation of break, thixotropy and fluidity and thus render an incomparably high performance of the overall system.

► Hydrophilic – Tear strength – Ultimate elongation

With Aqium® 3D, a high level of hydrophilicity, with simultaneously high tensile strength and ultimate elongation, has been successfully achieved. In particular Aqium® 3D LIGHT, MEDIUM, and MONO provide an increased level of hydrophilicity. Usually these important mechanic specific values will be reduced more the higher the hydrophilic property is adjusted. Lower values cause a tear of the material during the removal out of the patient's mouth and the impression must be repeated. Aqium® 3D offers safety herein and takes, in this combination, a leading position in the dental market.

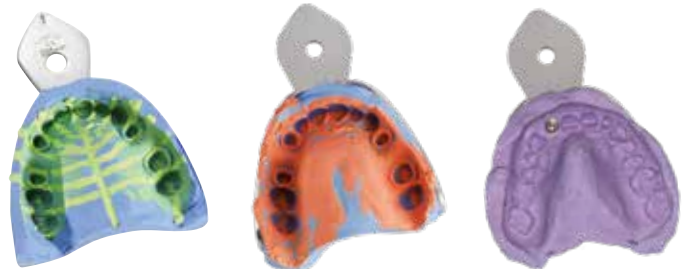

Aqium® 3D LIGHT +
Aqium® 3D PUTTY STANDARD
(2-step technique)

Aqium® 3D MEDIUM +
Aqium® 3D HEAVY
(1-step technique)

Aqium® 3D MONO

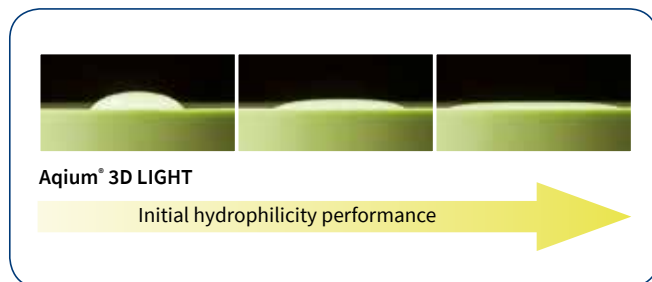

► Pronounced Thixotropy / Excellent Flowability

Aqium® 3D LIGHT displaces existing humidity and flows bubble free onto the preparation and stays in that position. Under the dynamic pressure of the tray material, e.g. Aqium® 3D HEAVY, the perfect fluidity unfolds.

► Scannability

During the development of the Aqium® 3D the requirements of the progressive digital dentistry were taken in account. The impressions, which were taken in the conventional way with Aqium® 3D, are scannable without the addition of a powder or spray. In this way a computer-assisted production of tooth restorations, based on digital data, will be enabled, even if a scan directly in the mouth turns out to be problematic caused through difficult situation in the mouth. It is not a mandatory to have a scanner in the dental practice. The impression is dimensionally stable and can be sent to a milling center or dental laboratory, who will carry out all further digital workflow for the production of the dental prosthesis.





► Recommendations Material Combination/ Impression technique

| Tray material | Wash material | Putty wash technique (2-step) | Double mixing technique (1-step) | Monophase technique |
|--------------------------|------------------|-------------------------------|----------------------------------|---------------------|
| Aqium® 3D PUTTY SOFT | Aqium® 3D LIGHT | ★★★★ | ★★ | |
| | Aqium® 3D MEDIUM | ★★ | ★★★★ | |
| Aqium® 3D PUTTY STANDARD | Aqium® 3D LIGHT | ★★★★ | ★ | |
| | Aqium® 3D MEDIUM | ★★★★ | ★ | |
| Aqium® 3D HEAVY | Aqium® 3D LIGHT | ★ | ★★★★ | |
| | Aqium® 3D MEDIUM | ★ | ★★★★ | |
| Aqium® 3D MONO | | | | ★★★★ |

★★★★ = Highly recommended ★★ = Recommended ★ = less recommended

► Viscosities

With its extensive range of material types, the Aqium® 3D impression system meets all requirements of current impression techniques in terms of viscosity, consistency and Shore hardness. The combinations listed as possibilities in the table on the left are recommendations from a specification perspective; further combinations are possible, of course. The high material quality of the Aqium® 3D products supports perfect impression taking in any case.

Aqium® 3D PUTTY SOFT /STANDARD

Kneadable, sticky free tray material

- Working time: 2 min. 15 sec.
- Time in mouth: 2 min. 15 sec.
- Colour: lilac-blue

Aqium® 3D PUTTY SOFT

- REF 88631 2x 300 ml boxes (catalyst + base)
- REF 85191 1x 380 ml cartridge 5:1 + 10 Mixing tips + 1 Fix cap
- REF 85131 2x 380 ml cartridges 5:1

Aqium® 3D PUTTY STANDARD

- REF 88632 2x 300 ml boxes (catalyst + base)

Aqium® 3D HEAVY

Heavy body tray material

- Working time: 2 min. 15 sec.
- Time in mouth: 2 min. 15 sec.
- Colour: lilac-blue



- REF 82533 2x 50 ml cartridges + 6 Mixing tips NT, green
- REF 85133 2x 380 ml cartridges 5:1



Aqium® 3D BITE, further details see on p. 14

Aqium® 3D LIGHT

Light body wash material

- Working time: 2 min. 15 sec.
- Time in mouth: 2 min. 15 sec.
- Colour: neon-yellow



REF 82530 2x 50 ml cartridges + 12 Mixing tips NT, yellow

Aqium® 3D MEDIUM

Medium body wash material

- Working time: 2 min. 15 sec.
- Time in mouth: 2 min. 15 sec.
- Colour: orange



REF 82531 2x 50 ml cartridges + 12 Mixing tips NT, yellow

Aqium® 3D MONO

Monophase, medium body tray material

- Working time: 2 min.
- Time in mouth: 2 min.
- Colour: violet



REF 85139 2x 380 ml cartridges 5:1

REF 85199 1x 380 ml cartridge + 10 Mixing tips 5:1, 1 Fix cap

New Mixing Technology

- Visible homogeneous mixing results
- 28 % material savings
- Less waste protect the environment



Accessories



REF 51291 Fix cap 5:1, yellow, 2 pieces

REF 51401 Mixing tips 5:1, yellow, 40 pieces

REF 811511 Mixing tips NT, yellow, 50 pieces

REF 811513 Mixing tips NT, green, 50 pieces

REF 474196 Intra-Oral-Tips, yellow, 96 pieces

REF 811010 Mixing Gun NT (1:1/2:1)

REF 82005 Mixing Gun (1:1/2:2)



► Recommendation for Material combination/ Impression techniques

| Tray material | Wash material | Putty wash technique (2-step) | Double mixing technique (1-step) | Monophase technique |
|---------------------------|------------------------|-------------------------------|----------------------------------|---------------------|
| betasil® VARIO PUTTY | betasil® VARIO LIGHT | ★★★ | ★ | |
| | betasil® VARIO MEDIUM | ★★★ | ★ | |
| betasil® VARIO PUTTY SOFT | betasil® VARIO LIGHT | ★★★ | ★★ | |
| | betasil® VARIO MEDIUM | ★★ | ★★★ | |
| betasil® VARIO HEAVY | betasil® VARIO LIGHT | ★ | ★★★ | |
| | betasil® VARIO MEDIUM | ★ | ★★★ | |
| betasil® VARIO IMPLANT | betasil® VARIO IMPLANT | | | ★★★ |

★★★ = Highly recommended ★★ = Recommended ★ = less recommended

The standard A silicone line betasil® VARIO offers everything users need for taking precise impressions. In addition to providing high precision, good tensile strength and temporally unlimited dimensional stability, with its wide range of viscosities and consistencies the system covers all indications and impression techniques (1-step and 2-step and monophase). All tray materials are additionally available in the handy 5:1 cartridge and can thus be used in all common mixing devices. The indwelling time of only 2 minutes in the mouth and the subtle mint aroma are patient-friendly. The flexible processing times and the very high colour contrast of the materials, which provides excellent legibility of the impressions, are user-friendly. All around a well-designed impression system with an excellent price-performance ratio.

► Indication

- Crown and Bridges
- Inlays
- Onlays
- Partial denture
- Total denture
- Implant prosthetic works

betasil® VARIO PUTTY / PUTTY SOFT

Kneadable, sticky free tray material in different consistencies and Shore hardness.

- Working time: up to 2 min.
- Time in mouth: 2 min.
- Colour: green (PUTTY), blue (PUTTY SOFT)
- Final hardness: betasil® VARIO PUTTY: Shore A 70 / betasil® VARIO PUTTY SOFT: Shore A 60
- Aroma: mint

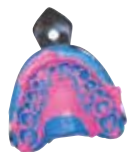

betasil® VARIO PUTTY

REF 88002 2x 300 ml boxes base + catalyst

betasil® VARIO PUTTY SOFT

REF 88601 2x 300 ml boxes base + catalyst

REF 85101 1x 380 ml cartridge 5:1 + 10 Mixing tips + 1 Fix cap

REF 85121 2x 380 ml cartridges 5:1 + 1 Fix cap



betasil® VARIO HEAVY

- Heavy body tray material
- Working time: up to 2 min.
 - Time in mouth: 2 min.
 - Colour: blue-violet
 - Aroma: neutral



REF 85103 2x 380 ml cartridges 5:1

REF 82503 2x 50 ml cartridges + 6 Mixing tips, green

betasil® VARIO IMPLANT

Monophase material, matched to meet the requirements of implant- and / or transfer impressions. Its viscosity offers the necessary stableness in the spoon, on the one hand, and high fluidity under pressure, on the other hand. betasil® VARIO IMPLANT products can be used as a tray- and syringe-material and is also suitable for other applications of precision impressions beyond the field of implantology.

- Working time: up to 2 min.
- Time in mouth: 2 min.
- Colour: blue
- Aroma: mint

REF 85109 1x 380 ml cartridge + 10 Mixing tips + 1 Fix cap

REF 85129 2x 380 ml cartridges + 1 Fix cap

REF 82509 2x 50 ml cartridges + 6 Mixing tips, green

betasil VARIO LIGHT / LIGHT *fast set*

Light body wash material with extra thin flowing properties, available with a variable setting time and as a fast set type.

- Working time: VARIO LIGHT: up to 2 min. / LIGHT fast set: 1 min.
- Time in mouth: VARIO LIGHT: 2 min. / LIGHT fast set: 1 min.
- Colour: pink
- Aroma: mint



betasil® VARIO LIGHT

REF 82500 2x 50 ml cartridges + 12 Mixing tips, yellow

REF 86500 6x 50 ml cartridges + 36 Mixing tips, yellow

betasil® LIGHT *fast set*

REF 82510 2x 50 ml cartridges + 12 Mixing tips, yellow

betasil VARIO MEDIUM

Medium body wash material

- Working time: bis 2 Min.
- Time in mouth: 2 Min.
- Colour: lilac
- Aroma: mint



REF 82501 2x 50 ml cartridges + 12 Mixing tips, pink

REF 86501 6x 50 ml cartridges + 36 Mixing tips, pink

Accessories

REF 82005 Mixing Gun Typ SCS (1:1/2:1)

REF 811501 Mixing tips yellow, 50 pcs.

REF 811502 Mixing tips pink, 50 pcs.

REF 811503 Mixing tips green, 50 pcs.

REF 474196 Intra-Oral-Tips, yellow, 96 pcs.

REF 80096 Intra-Oral-Tips, transparent, 96 pcs.

REF 51401 Mixing tips 5:1, 40 pcs.

REF 51291 Fix cap, 2 pcs.





a-basic® precise fast set, 5:1 a-basic® preprint fast set, 5:1

a-basic® precise and preprint in 5:1 cartridges can be universally used with all popular addition-curing wash materials. a-basic® precise has a rather soft consistency and is suitable for the double mixing technique (1-step), while a-basic® preprint has a high, putty-like consistency and is thus predestined for correction impressions (2-step). Both material types captivate with their very good price-performance ratio and yet deliver precise results. A real economical alternative for the dental practice.

a-basic® preprint fast set, 5:1

- Working time: 1 min. 45 sec.
- Time in mouth: 2 min.
- Final hardness: Shore A 70
- Colour: light-green
- Aroma: mint
- Impression technique: Putty-wash-technique (2-step)

REF 51021 2x 380 ml cartridges 5:1

a-basic® precise fast set, 5:1

- Working time: 1 min. 45 sec.
- Time in mouth: 2 min.
- Final hardness: Shore A 60
- Colour: yellow
- Aroma: Vanilla-cream
- Impression technique: Double mixing-/ Sandwich-technique (1-step)

REF 51028 2x 380 ml cartridges 5:1

Sympress

Automatic mixing device, compatible with all common 5:1 full size cartridges and tubular bag systems.

REF 51557 Sympress, 230 V, 50 Hz (UK)

REF 51599 Wall mounting kit

Features

- Dual speed: **FAST** for high viscosity type material, such as betasil® VARIO PUTTY SOFT 5:1/ HEAVY, Aqium® 3D PUTTY SOFT / HEAVY; **SLOW** for lower viscosity type materials.
- Quick and simple cartridge changes through fast advance/return.
- Electronic recognition of remaining quantity through LED indicator.
- Timer-function for setting time control.

Accessories

REF 51401 Mixing tips 5:1, 40 pcs.

REF 51291 Fix cap, 2 pcs.



EasyCord

Knit retraction cords made of 100 % cotton, non-impregnated. The special cord sample makes it possible to soak up a large amount of liquids, the excellent compression purposefully redelivers the liquid for effect. Very good flexible behaviour provides for a constant pressure and perfect fit; EasyCord can be easily inserted, it does not fray and does not get tangled up in the rotating diamond drill.

Further advantages

- 30 % higher liquid absorption capacity
- High speed absorption with WOW-Effect
- Easy handling thanks to
 - Integrated cutter and
 - linear measurement scale for simple and hygienic dispensing.

REF 20254-000 size 000, green, 330 cm

REF 20254-00 size 00, brown, 330 cm

REF 20254-0 size 0, purple, 330 cm

REF 20254-1 size 1, blue 330 cm

REF 20254-2 size 2, orange, 330 cm

REF 20254-3 size 3, yellow, 330 cm

EasyCord Organizer

REF 20EC-ORG 1 pcs. Organizer, empty, acryl glass



scannable



A wide range of bite registration materials are available to users, in order to meet all indications as well as the individual needs of dentists and dental technicians. All materials are high-precision A-silicones, type 1 (= heavy body), with excellent thixotropy, which prevents the material from flowing off unintentionally, are permanently dimensionally stable, and can be used several times. The products differ mainly in Shore hardness, setting time in the mouth and within a defined range of consistency. Thus, granit PERFECT D45 and Aquium® 3D BITE offer the fastest setting time in the mouth, namely 30 seconds. Aquium® 3D BITE is the only material that can be scanned, of course without additional use of powder, and topas PERFECT A85 with its slightly fluffy consistency is the best-selling product within the range.

Aqium® 3D BITE

- Working time: 30 sec.
- Time in mouth: 30 sec.
- Final hardness: Shore D 45
- Special feature: extra high hardness; excellent milling and cutting features
- Colour: yellow
- Aroma: neutral
- Indications:** Specifically created for the use in CAD/CAM systems.
 - Digitization of occlusion surfaces, antagonists and preparations (no powder needed)
 - Long-lasting bite registration material



REF 82538 2x 50 ml cartridges + 12 Mixing tips NT, green

granit PERFECT D45

- Working time: 30 Sek.
- Time in mouth: 30 sec.
- Final hardness: Shore D 45
- Special feature: extra high hardness; excellent milling and cutting features
- Colour: green
- Aroma: Mint
- Indications:**
 - Long-lasting bite registration material
 - Fixing of support registration and bite conditions with the help of a facebow.



REF 82505 2x 50 ml cartridges + 12 Mixing tips, green

REF 86505 6x 50 ml cartridges + 36 Mixing tips, green

topas PERFECT A85

- Working time: 30 sec.
- Time in mouth: 60 sec.
- Final hardness: Shore A85
- Special feature: good milling and cutting features
- Colour: yellow
- Aroma: Mint
- Indications:**
 - Long-lasting bite registration material
 - Fixing of support registration and bite conditions with the help of a facebow.



REF 82507 2x 50 ml cartridges + 12 Mixing tips, green

REF 86507 6x 50 ml cartridges + 36 Mixing tips, green

kristall PERFECT A70 / A50

- Working time: 30 sec.
- Time in mouth: 60 sec.
- Final hardness: Shore A 50 oder A70,
- Colour: clear transparent
- Aroma: Mint
- Indications:**
 - Long-lasting bite registration material
 - Occlusal stamp for light curing composite restorations
 - transfer matrix for fixing of brackets.



kristall PERFECT A70

REF 82576 2x 50 ml cartridges + 12 Mixing tips, green

REF 86576 6x 50 ml cartridges + 36 Mixing tips, green

kristall PERFECT A50

REF 82506 2x 50 ml cartridges + 12 Mixing tips, green

REF 86506 6x 50 ml cartridges + 36 Mixing tips, green

Accessories

REF 811503 Mixing Tips, green, 50 pieces

REF 811511 Mixing Tips NT, green, 50 pieces

REF 81125 Conturing tips, 25 pieces



SILECT® The Best – The NEW Gold Standard!

Our best C-silicone – SILECT® – was developed using our many years of experience and chemical expertise and employing state-of-the-art production technologies. This premium impression material offers excellent technical properties such as very low shrinkage and a very high degree of elastic recovery. User-friendliness was also a key consideration, so the consistency of the materials and their high-contrast colours are ideally coordinated. The materials are easy to dose precisely and mix with the new SILECT® catalyst gel. The working times are user-friendly, while the short time in mouth will be welcomed by patients.

Following specifications apply to all materials:

- Working time applies to all materials:
 - Colours:
 - 1 min. 30 sec.
 - Silect® putty: mint-green
 - Time in mouth: 3 min. 30 sec.
 - Silect® light: blue-violet
 - Arome putty: peppermint
 - Silect® catalyst: red
 - Arome light: neutral



2-step-technique



1-step-technique

Silect® putty

REF 000480160 910 ml jar

Silect® light

REF 000480010 140 ml tube



Silect® catalyst

REF 000480099 60 ml tube

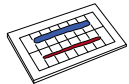
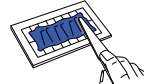
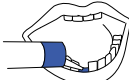

Silect®-Set

REF 000480001 910 ml putty + 140 ml light + 60 ml catalyst

SILECT® light

| | | |
|--|--|---|
|  | 30 sec. |  |
| 1 min. |  | 3 min. 30 sec. |
| | |  |

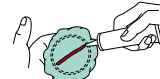
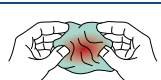
SILECT® putty

| | | |
|--|--|---|
|  | 4 cm |  |
| 30 sec. |  | 1 min. |
| | |  |
| 3 min. 30 sec. |  | |

Accessories

REF 000470210 1 Mixing block with 10 sheets



alphasil® PERFECT

For 30 years alphasil® PERFECT, a condensation-curing polysiloxane, has offered the user precision, security and reliability in use and the end result. The range covers all viscosities and is suitable for all impression techniques. The DBTL free activators, whether liquid or paste hardeners, are easy to dose and can be mixed in sparingly, easily and controllably. The light mint aroma with all alphasil® silicones rounds off the range. alphasil® PERFECT has proven to be of best value in crown and bridge dentistry, inlays, onlays, mucous membrane /function and situation impressions.

Following specifications apply to all materials:

- Working time 1 min. 45 sec.
- Time in mouth: 4 min.
- Aroma: mint
- Colours:
PUTTY: white
HEAVY: turquoise
MEDIUM: blue
LIGHT: dark blue

alphasil® PERFECT Putty soft

- REF 470025 900 ml jar
- REF 470525 5 kg bucket
- REF 471025 10 kg bucket

alphasil® PERFECT LIGHT

- REF 470010 150 ml tube

alphasil® PERFECT MEDIUM

- REF 470020 150 ml tube

alphasil® PERFECT HEAVY

- REF 470033 150 ml tube





alphasil® PERFECT ACTIVATOR PASTE

- REF 470256D 60 ml tube, DBTL-free



alphasil® PERFECT ACTIVATOR LIQUID

- REF 470252D 50 ml bottle, DBTL-free

alphasil® PERFECT PUTTY SOFT

| | |
|---|---|
|  2.5 cm | 30 sec.  |
| 1 min. 15 sec.  | 4 min.  |

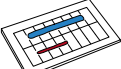
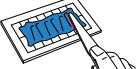
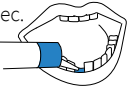
alphasil® PERFECT LIGHT / MEDIUM / HEAVY

| | |
|---|---|
|  | 30 sec.  |
| 1 min. 15 sec.  | 4 min.  |

Accessories

- REF 000470210 1 Mixing block with 10 sheets





algistar

algistar-alginate meet and exceed all standards; they are dust-free, cadmium- and lead-free and offer excellent biocompatibility. The improved dimensional stability and appropriate storage of the impressions enable pouring even after 5 days – without crucial loss of quality. All algistar product variants possess excellent compatibility with dental plasters. algistar chromatic offers the additional benefit of changing colour to identify the respective work steps, while the classic version is a traditional precision alginate without colour change. The unopened bags have a shelf-life of 6 years thanks to special packaging technology.

algistar classic

- Time in mouth: 40 sec.
- Total setting time: 2 min.
- Colour: orange
- Aroma: Tutti Frutti
- Indication: Situation impressions, full and partial denture prosthetics, orthodontic purposes



REF 244530 Packaging unit (24 bags of 453 g each) incl. measuring instruments

algistar chromatic FAST SET

- Time in mouth: 40 sec.
- Total setting time: 2 min.
- Colour: light-blue
- Aroma: Vanilla-Mint
- Indication: Situation impressions, full and partial denture prosthetics, orthodontic purposes



REF 244538 Packaging unit (24 bags of 453 g each) incl. measuring instruments

algistar chromatic REGULAR SET

- Time in mouth: 1 min 20 sec.
- Total setting time: 3 min. 20 sec.
- Colour: yellow
- Aroma: Tropical fruits
- Indication: Situation impressions, full and partial denture prosthetics, orthodontic purposes



REF 244539 Packaging unit (24 bags of 453 g each) incl. measuring instruments

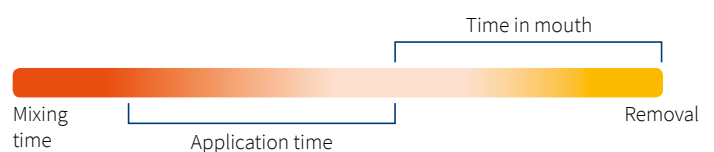
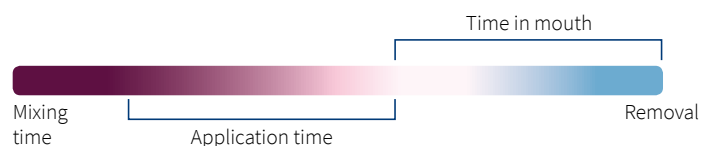

The all-round carefree package

Müller-Omicron has developed a completely new product range allowing it to offer a disinfection program perfectly coordinated to the dental sector and its special requirements. In the process, **all factors were put to the test**. In addition to shorter acting times and extended spectra of effectiveness, the focus was on absolute user-friendliness, minimization/eradication of allergy potential and hazard risks, and optimal material compatibility.

The result is DISINFECTION 360. A range specially coordinated to the requirements and needs of the dental practice. It enables efficient and high-performance disinfection with all indications covered. The products are tested in accordance with the latest standards and **EN regulations**, assessed and will be **VAH-listed** according to their field of application. The consistent introduction of metered-dose squeeze bottles for all concentrates offers ultimate user safety thanks to exact dosage and safe refilling using the corresponding, practical accessories. In addition, the Lift & Stick label system greatly simplifies the handling of mandatory marking and documentation of medical devices in use – making it **simply easy**.

As the area of wipe-down disinfection is developing ever more rapidly, the new range – **DISINFECTION 360** – now includes a larger selection of different cloth-wipe systems: There are wipes of different sizes and qualities, ready-to-

SUCTION SYSTEMS • SP

SURFACE

DISINFECTION
360
MADE
MÜLLER-O
TATING INSTRUMENTS



360 USER-FRIENDLY

360 SAFE

360 QUALITY

360 ECONOMICAL

use wipes soaked in alcoholic and alcohol-free solutions, and dry wipes for individual soaking. All ready soaked cloth-wiping systems fulfill the requirements of the **4-Field Test (EN 16615)** and are VAH-listed as an separate product.

The disinfectant solution, Dentalrapid® SD liquid, now not only offers faster exposure times, but also an extended spectrum of effectiveness with the distinction of **Limited Virucidal PLUS**. The modified non-alcoholic variant Dentalrapid® soft SD liquid could also be decisively improved in the exposure times and the spectrum of activity.

Other groups of indications have been practically expanded with further products, such as Dentosuc weekly AC pur for weekly cleaning of the suction system and Dentotol® MD liquid for professional disinfection of the mouth rinsing basin.

In order to meet the increased requirements in daily practice now and in the future, there are now **full virucidal** disinfectants available to users – Dentalrapid® Ultra SD liquid for surfaces of all kinds, Dentasept® Ultra ID pur for surgical instruments and endoscopes, and Dentoderm® HD liquid for hygienic and surgical hand disinfection. All products provide short contact times and consequently fastest and comprehensive protection and safety for dentists, patients and staff.

With its new modified range DISINFECTION 360, Müller-Omicron offers everything that modern dental practices require for reliable, efficient and cost-effective disinfection.

Limited Virucidal PLUS

Confirmed
4-Field-Test
Performance

NEW

Improved
Formular

VAH
Verband für Angewandte
Hygiene e.V.
listed

Dentalrapid® SD liquid + Dentalrapid® SD wipes S M L XL

Alcoholic rapid surface disinfectant ready-to-use

Type of application: As per the Medical Devices Law (MPL): ready-to-use alcohol based solution and alcoholic wet wipes for the prophylactic surface disinfection of alcohol-resistant medical products. Not suitable for the terminal disinfection of invasive medical products. **VAH gelistet.**

Spectrum of effectiveness + application times: Application times (related to the impregnating liquid): Bacteria as per EN 13727 and EN 13697 (high contamination): conc. 1 min.; Candida albicans as per EN 13624 and EN 13697 (high contamination): conc. 1 min.; TbB (tuberculosis) inactivation (M. terrae) as per EN 14348 (high contamination): conc. 1 min.; Enveloped viruses (e.g. HBV, HCV and HIV) as per DVV/2012 in a surface test, (high contamination): conc. 1 min.; Adeno-/ noro-/ rotaviruses as per EN 14476 (high contamination): conc. 1 min.

Application times in use with other dry tissues or Dentalrapid® SD wipes S, M, L, XL: Bacteria and candida albicans (as per VAH, version: 02.04.15 and EN 16615, high contamination): conc. 2 min.

Ingredients: (100 g of solution contain): 43.0 g ethanol, 8.0 g 1-propanol, 0.055 g didecylmethylammonium chloride.

New Advantages

- Safer through broader spectrum of effectiveness – Limited Virucidal PLUS
- All the cloth impregnating systems available with 4-Field-Test (EN 16615)
- Easy documentation due to Lift & Stick label-system

Dentalrapid® SD liquid



| Packing Unit | Neutral REF | Lemon REF | Fruit REF | Flower REF |
|---------------------|-------------|-----------|-----------|------------|
| 100 ml spray bottle | 71000100 | 71010100 | 71020100 | 71030100 |
| 500 ml bottle | 71000500 | 71010500 | 71020500 | 71030500 |
| 1 Liter bottle | 71001000 | 71011000 | 71021000 | 71031000 |
| 5 Liter canister | 71005000 | 71015000 | 71025000 | 71035000 |

Limited Virucidal PLUS



Full Virucidal



Cloth Quality and Sizes

New special lint-free fleece qualities with solidified fibres in different sizes.

| Product Type | Size | Quality |
|---------------------------------|------------|---------------------|
| Dentalrapid® SD wipes S | 12 x 20 cm | 23 g/m ² |
| Dentalrapid® SD wipes M | 23 x 15 cm | 50 g/m ² |
| Dentalrapid® SD wipes L | 20 x 30 cm | 50 g/m ² |
| Dentalrapid® SD wipes XL | 28 x 30 cm | 50 g/m ² |

Dentalrapid® SD wipes

| REF | Packing Unit | Size |
|-----------|--|------------------------|
| 71510100 | Dentalrapid® SD wipes, refill bag, 100 tissues (lemon) | S |
| 71510101 | Dentalrapid® SD wipes, Box, 100 tissues (lemon) | S |
| 71500100 | Dentalrapid® SD wipes, refill bag, 100 tissues (neutral) | S |
| 71500101 | Dentalrapid® SD wipes, Box, 100 tissues (neutral) | S |
| 71510240 | Dentalrapid® SD wipes, 2 rolls with 240 tissues (lemon) | M |
| 71510080 | Dentalrapid® SD wipes, flowpack, 80 tissues (lemon) | L |
| 71510090 | Dentalrapid® SD wipes, 2 rolls with 90 tissues (lemon) | XL |
| 701005012 | Dispenser cube, Dispenser for type | M and XL |

Dentalrapid® Ultra SD liquid

Full virucidal surface disinfectant ready-to-use

Type of application: As per the Medical Devices Law (MPL): For rapid disinfection of alcohol-resistant, non-invasive medical devices. **VAH-listed.**

Spectrum of effectiveness + application times:

- Surface disinfection (wiping disinfection) according to VAH (bactericidal, yeasticidal, high contamination): conc. 1 min.
- tuberculocidal (*M. terrae*) (EN 14348): conc. 30 sec.
- virucidal (EN 14476) including HBV/HIV/HCV: conc. 1 min.
- poliovirus: conc. 1 min.
- adenovirus: conc. 30 sec.
- norovirus (MNV): conc. 1 min.
- rotavirus: conc. 30 sec.

Ingredients: (100 g of solution contain): 60 g of ethanol. Contains anionic surfactants > 5 %.

| REF | Packing Unit |
|----------|------------------|
| 71300500 | 500 ml bottle |
| 71305000 | 5 Liter canister |



DISINF
36
MAD
MÜLLER-

Confirmed
4-Field-Test
Performance

VAH
Verband für Angewandte
Hygiene e.V.
listed

Dry wipes

DryWipes classic

High-quality, lint-free fleece, particularly tear-resistant, very economical. Quality: 40 g/m²; Format: 160 mm x 280 mm; Contents: 1 roll with 250 sheets

DryWipes soft

Extremely soft, quality fleece with excellent tear resistance and absorbency. Quality: 50 g/m²; Format: 280 mm x 300 mm; Contents: 1 roll with 90 sheets

Dispenser cube

The practical dispenser system for perfect hygienic storage of DryWipes classic and soft/ and the ready-to-use varieties Dentalrapid® SD wipes M and XL.

DryWipes Soft compact:

Finest micro-fleece made from a lint-free soft viscose/polyester mixture with high tear strength and high absorbtion. Quality: 50 g / m²; Size: 285 mm x 300 mm; Contents: one layer with 50 wipes

DryWipes Box compact:

Flat dispenser system for hygienic storage of DryWipes Soft compact tissues, suitable for any drawers 9 cm height or more for more space available on the bench top. Dimensions: 25 cm (wide) x 34.5 cm (long) x 8.5 cm (height)

| Packing Unit | DryWipes classic REF | DryWipes soft REF |
|---|----------------------|-------------------|
| 2 rolls | 701005225 | 701005280 |
| 10 rolls | 701005025 | - |
| System-Set :1x Dispenser cube with 1 roll | 701005125 | 701005180 |

| Packing Unit | REF |
|--|-----------|
| 1x Dispenser cube, empty | 701005012 |
| 1x DryWipes Box compact, empty | 701005011 |
| DryWipes Soft compact 3 packs of 50 wipes each | 701005350 |

Dentalrapid® soft SD pur

Alcohol-free rapid surface disinfectant Concentrate

Aldehyde-free and alcohol-free surface disinfection concentrate for professional use, particularly for alcohol-sensitive surfaces of medical devices, like leather, artificial leather, varnished surfaces, acrylic glass. VAH-listed.

Type of application: As per the Medical Devices Law (MPL): Surface disinfection for the prophylactic surface disinfection of medical devices. Not suitable for the final disinfection of invasive medical devices.

Spectrum of Effectiveness and application times:

Bacteria (incl. MRSA) and Candida albicans according to EN 13727, EN 13624, EN 13697 (high contamination): 0.5 % - 15 min.
Bacteria (incl. MRSA) and Candida albicans according to VAH, EN 16615 (high contamination): 3.0 % - 15 min. / 1.0 % - 60 min.
Enveloped viruses (e.g. HBV, HIV, HCV) according to RKI/DV (high contamination): 2.0 % - 5 min. / 1.0 % - 60 min.
Tuberculocidal (M. terra) according to EN 14348 (low contamination): 1.0 % - 60 min.

Ingredients: (100 g of solution contain): 5.6 g Didecylmethyl ammonium-chloride, 3.1 g N-(3-Aminopropyl)-N-dodecyl-propan-1.3-diamine.

| REF | Packing Unit |
|----------|-------------------------------------|
| 71221000 | 1 litre metered-dose squeeze bottle |
| 71225000 | 5 litre canister |

alcoholfree



alcoholfree

NEW



Dentalrapid® soft SD liquid + Dentalrapid® soft SD wipes L

Alcohol-free rapid surface disinfectant ready-to-use

Aldehyde-free and alcohol-free disinfectant solution and wet wipes for professional use in practices, hospitals and nursing homes, with very good cleaning effect, pleasant odour, broad spectrum of activity, short contact times and residual effect. Gentle on materials, particularly suitable for alcohol-sensitive surfaces, like acrylic glass. **VAH-listed.**

Type of application: As per the Medical Devices Law (MPL): Alcohol-free surface disinfectant for the prophylactic surface disinfection of non-invasive medical devices such as small appliances, medical/dental furniture, leather, artificial leather, varnished surfaces, acrylic glass.

Spectrum of effectiveness + application times (related to the impregnating liquid): Bacteria as per EN 13727, EN 1276 and EN 13697 (high contamination): conc. 1 min.; Candida albicans as per EN 13624, EN 1650 and EN 13697 (high contamination): conc. 1 min.; Enveloped viruses (e.g. HBV, HCV and HIV) as per RKI/DVV (high contamination): conc. 1 min.; Rotaviruses as per DVV (with contamination): conc. 1 min.; Noroviruses as per EN 14476, (low contamination): conc. 30 min.

Application times in use with other dry tissues: Bacteria and candida albicans (as per VAH, version: 02.04.2015 and EN 16615, high contamination): conc. 2 min.

Application times in use with Dentalrapid® soft SD wipes L: Bacteria and candida albicans (as per VAH, version: 02.04.2015 and EN 16615, high contamination): conc. 1 min.

Ingredients: (100 g of solution contain): 0.24 g Benzyl-C12-16-alkyldimethylammonium chloride, 0.24 g N,N-didecyl-N,N-dimethyl ammonium chloride, 0.24 g C12-14-alkyl[(ethylphenyl)methyl]dimethyl ammonium chloride

Advantages

- Alcohol-free and pH-level neutral
- Broad spectrum of effectiveness
- 4-Field-Test (EN 16615) available
- Suitable for acrylic glass
- Aldehyde-free

Dentalrapid® soft SD liquid

| REF | Packing Unit |
|----------|---------------------|
| 71200100 | 100 ml spray bottle |
| 71200500 | 500 ml bottle |
| 71201000 | 1 litre bottle |
| 71205000 | 5 litre canister |

Dentalrapid® soft SD wipes L

| | |
|----------|--|
| 71520080 | Dentalrapid® soft SD wipes, flowpack, 80 wipes (lemon) L |
|----------|--|



Advantages

- High material compatibility
- Good corrosion protection
- Protection of the instruments
- Broad spectrum of effectiveness
- Short application times
- Suitable for ultrasonic bath
- Aldehyde- / peracetic- and chlorineoxide-free

The new instrument-disinfection line impresses with its excellent material compatibility and good corrosion protection. The instruments/ dental utensils are protected and the longevity improved considerably. For example, Dentodril® ID liquid with its neutral pH-value effects a **longer service life-time** for rotating instruments. The blades stay sharp longer. Nevertheless, the products have a broad spectrum of effectiveness and short application times.

Dentasept® ID pur

Instruments disinfectant **Concentrate**

Aldehyde-/ peracetic and chlorine oxide free instrument disinfectant for professional use in practices, hospitals and nursing homes, with excellent cleaning effect, broad spectrum of effectiveness and short contact times. The good material compatibility and high corrosion protection should be specially mentioned. **VAH-listed.**

Type of application: Preparation for manual disinfection and simultaneous cleaning of dental and surgical instruments, rotary instruments, laboratory equipment, as well as thermolabile and thermostable instruments in immersion bath procedures. Not suitable for the terminal disinfection of semi-critical and critical medical devices.

Spectrum of effectiveness + application times:

- Bacteria as per EN 13727, EN 14561 and VAH with high contamination: 1.5 % - 15 min. / 1.0 % - 60 min.
- *Candida albicans* as per EN 13624, EN 14562 and VAH with high contamination: 1.5 % - 15 min. / 1.0 % - 60 min.
- Enveloped viruses (e.g. HBV, HCV and HIV) as per DVV/RK with high contamination: 1.5 % - 15 min. / 1.0 % - 60 min.
- TbB (*M. terrae*) as per EN 14348 and EN 14563, low contamination: 4.0 % - 15 min. / 2.0 % - 60 min.

Ingredients: (100 g of solution contain): 4.4 g Didecyltrimethylammonium-chloride, 2.75 g N-(3-Aminopropyl)-N-dodecyl-propan-1.3-diamin.

| REF | Packing Unit |
|----------|-------------------------------------|
| 72001000 | 1 litre metered-dose squeeze bottle |
| 72005000 | 5 litre canister |



Dentasept Ultra ID pur

Full virucidal instruments disinfectant **Concentrate**

Type of application: Disinfection of endoscopes and surgical instruments of all kinds.

Spectrum of effectiveness: Bactericidal including MRSA, yeasticidal acc. DGHM-Standard method (high contamination); tuberculocidal EN 14348, virucidal against enveloped viruses (HIV, HCV, HBV) and none enveloped viruses (Polio-, adeno-, polyoma virus SV 40) acc. RKI/ DVV.

Concentration and application times: 1 % – 60 min. / 1.5 % – 30 min. / 2 % – 15 min.; Fully virucidal acc. to RKI/DVV: 2 % - 30 min.

Ingredients: (100 g of solution contain): 12.0 g glutaraldehyde; contains anionic surfactants 5 % - 15 %

| REF | Packing Unit |
|----------|-------------------------------------|
| 72301000 | 1 litre metered-dose squeeze bottle |
| 72305000 | 5 litre canister |

Dentodril® ID liquid

High performance disinfectant for rotating instruments ready-to-use

Highly effective, cleansing, ready-to-use combined preparation with a broad spectrum of activity against bacteria (including TBC), yeasts and enveloped viruses. The preparation contains an effective corrosion protection. The mild pH-value in combination with special ingredients results in a high material compatibility and thus significantly increases the lifetime of the burs. The rotating instruments stay sharp longer. **VAH-listed.**

Type of application: For cleaning and prophylactic disinfection of rotating instruments, such as carbide drills, diamond cutters, ceramic abrasives, rubber polishers, root canal instruments and other stainless steel instruments in an ultrasonic bath or bur bath.

Spectrum of effectiveness + application times:

- Bactericidal (incl MRSA) (EN 13727, EN 14561 and VAH, high contamination): conc.: 5 min.
- Candida albicans (EN 13624, EN 14562, VAH, high contamination): conc.: 5 min.
- TbB (M. terrae) as per EN 14348 and EN 14563, low contamination: conc.: 5 min.
- Enveloped viruses (e.g. HBV, HCV and HIV) as per RKI/DVV (high contamination): conc.: 5 min.

Ingredients: (100 g of solution contain): 0.396 g Didecylmethylammoniumchloride, 0.2475 g N-(3-Aminopropyl)-N-dodecyl-propan-1.3-diamin.

| REF | Packing Unit |
|----------|------------------|
| 73002000 | 2 litre bottle |
| 73005000 | 5 litre canister |



Dentoderm® HD liquid

Hand disinfectant ready-to-use

Area of application: For hygienic and surgical hand disinfection. **VAH-listed.**

Dosage and method of application:

Hygienic hand disinfection acc. to EN 1500:

Apply 3 ml of Dentoderm® HD liquid undiluted onto the hands and rub in for 30 seconds. The hands must be kept moist during the entire application time by the undiluted product.

Surgical hand disinfection acc. to EN 12791:

Apply at least 2 x 5 ml Dentoderm® HD liquid undiluted onto both hands and forearms, and rub in for 1½ minutes. The hands and forearms must be kept moist during the entire application time by the undiluted product.

Spectrum of activity: Bactericidal incl. MRSA, yeasticidal and virucidal (EN 14476); tuberculocidal (EN14348)

Ingredients: (100 g of solution contain): 80 g ethanol, 0.1 g alkyl (C12-16) dimethylbenzylammonium chloride

| REF | Packing Unit |
|----------|-------------------------------|
| 77000100 | 100 ml bottle |
| 77000500 | 500 ml Euro-dispenser bottle |
| 77001000 | 1 litre Euro-dispenser bottle |
| 77005000 | 5 litre canister |

Dentoderm® sensitive HD gel

Hand disinfectant gel ready-to-use

Area of application: For hygienic and surgical hand disinfection.

Disinfectant in gel form with pleasant fresh fragrance suitable for use in the medical and dental field. A special moisturising active complex make Dentoderm® sensitive HD gel very skin-friendly. The skin is protected from drying out. The gel prevents unnecessary dripping from the dispenser and diffuence on the skin. **VAH-listed.**

Dosage and method of application:

Hygienic hand disinfection acc. to EN 1500:

Apply 3 ml of Dentoderm® sensitive HD gel undiluted onto the hands and rub in for 30 seconds. The hands must be kept moist during the entire application time by the undiluted product.

Surgical hand disinfection acc. to EN 12791:

Apply at least 2 x 5 ml Dentoderm® sensitive HD gel undiluted onto both hands and forearms, and rub in for 3 minutes. The hands and forearms must be kept moist during the entire application time by the undiluted product.

Spectrum of activity: Bactericidal incl. MRSA, yeasticidal and limited virucidal (EN 14476); tuberculocidal (EN14348)

Ingredients: (100 g of gel contain): 63 g ethanol, perfume.

| REF | Packing Unit |
|----------|-------------------------------|
| 77100100 | 100 ml bottle |
| 77100500 | 500 ml Euro-dispenser bottle |
| 77101000 | 1 litre Euro-dispenser bottle |
| 77105000 | 5 litre canister |



Dermapon sensitive HC lotion

Medical hand washing lotion

- Without fragrances, colourants and abrasives
- Natural lipid replenishment with skin protection
- Dermatologically tested

Skin-caring washing lotion for daily use in medical and dental practices and hospitals, where the skin is particularly stressed by frequent hand washing and frequent hand disinfection. The natural skin environment is preserved and protected by high-quality ingredients and a skin-friendly pH, dermatologically tested.

Application and dosage: Pour approximately 1 ml undiluted onto the moistened hands, froth and rinse. The product contains no abrasives. Thanks to its flowability, the lotion is also ideal for metering from soap dispensers.

Ingredients (INCI): AQUA, SODIUM LAURETH SULFATE, COCAMIDOPROPYL BETAINE, SODIUM CHLORIDE, ALLANTOIN, SORBITAN SESQUICAPRYLATE, PEG-75 LANOLIN, CITRIC ACID, STYRENE/ACRYLATES COPOLYMER, SODIUM BENZOATE, PARFUM

| REF | Packing Unit |
|----------|-------------------------------|
| 77200100 | 100 ml bottle |
| 77201000 | 1 litre Euro-dispenser bottle |
| 77210000 | 10 litre canister |

Dentaclean HC lotion

Skin-caring washing lotion

Skin-care wash lotion for normal skin. The endogenous skin protective film and the natural skin condition are saved through skin-friendly pH-value, and a drying up of the skin is avoided.

Application and dosage: Pour approximately 1 ml undiluted onto the moistened hands, froth and rinse. The product contains no abrasives. Dentaclean HC lotion is suitable for metering from soap dispensers.

Ingredients (INCI): AQUA, SODIUM LAURETH SULFATE, SODIUM CHLORIDE, COCAMIDOPROPYL BETAINE, ALLANTOIN, GLYCERIN, SORBITAN SESQUICAPRYLATE, CITRIC ACID, SODIUM BENZOATE, PARFUM, CI 42090

| REF | Packing Unit |
|----------|-------------------------------|
| 77301000 | 1 litre Euro-dispenser bottle |
| 77310000 | 10 litre canister |



Dentosuc daily AD pur

The Disinfectant **Concentrate**

Aldehyde-free and extremely low-foaming and cleaning disinfectant concentrate based on quaternary ammonium salts. Dentosuc daily AD pur excels by high dirt-dissolving power towards deposits, saliva residues and drilling dusts, as well as by good material compatibility. Even very low concentrations are sufficient to achieve rapid effectiveness.

Fields of application: Combination product for daily cleaning and disinfection of dental aspiration systems of all designs (including saliva aspirator / with and without amalgam separator).

Spectrum of effectiveness + application times:

- Bacteria and Candida albicans in accordance to VAH (high contamination) as instrument disinfection: 2.0 % - 5 min. / 1.0 % - 60 min.
- Bacteria in accordance to EN 13727 and EN 14561 (high contamination): 3.0 % - 2 min.
- Candida albicans in accordance to EN 13624 and EN 14562 (high contamination): 3.0 % - 2 min.
- Enveloped viruses (i.e. HBV, HIV, HCV) in accordance to BGA(RKI)/DVV (contaminated): 2.0 % - 2 min.

Ingredients: (100 g of the solution contain): 7.5 g Dimethyldioctylammoniumchloride, 0.6 g Benzyldimethyldodecylammoniumchloride

| REF | Packing Unit |
|----------|-------------------------------------|
| 75001000 | 1 litre metered-dose squeeze bottle |
| 75005000 | 5 litre canister |

Dentosuc weekly AC pur

The Cleaner **Concentrate**

For weekly hygiene in dental aspiration systems of all types including their drainage pipes. The low-foaming concentrate offers a high cleaning performance and material compatibility and, with regular use, prevents formation of deposits and blockages or dissolves already existing deposits. Ideal for weekly alternating pur cleaning of the aspiration system alternating with Dentosuc daily AD pur.

Fields of application: For weekly cleaning of dental aspiration systems.

Ingredients: (100 g of the solution contain):

- < 5% amphoteric surfactants
- < 5% Phosphonates

| REF | Packing Unit |
|----------|-------------------------------------|
| 75101000 | 1 litre metered-dose squeeze bottle |
| 75102000 | 2 litre bottle |



Tuberculocidal



Dentoprint® MD liquid

Disinfectant for Impressions ready-to-use

Aldehyde-free solution for the disinfection of dental impression materials of all kinds by using immersion method. Dentoprint MD liquid offers a large spectrum of effectiveness and rapid contact times. To emphasize is the excellent material compatibility with the different impression materials and no negative effect on the dimension of the impression. **VAH-listed.**

Spectrum of effectiveness + application times:

- Bacteria (incl. MRSA) as per VAH, EN 13727 and EN 14561 (high contamination): conc. 1 min.
- Candida albicans as per VAH, EN 13624 and EN 14562 (high contamination): conc. 1 min.
- Enveloped viruses (e.g. HBV, HCV and HIV) as per RKI/DVV (with contamination): conc. 1 min.
- TbB (M. terrae in a suspension test, low contamination): conc. 15 min.

Ingredients: (100 g of the solution contain): 0.24 g Benzyl-C12-16-alkyldimethylammonium chloride; 0.24 g N,N-didecyl-N,N-dimethyl ammonium chloride; 0.24 g C12-14-alkyl[(ethylphenyl)methyl]dimethyl ammonium chloride; 0.35 g chlorhexidine gluconate; < 5 % cationic surfactants, fragrance.

| REF | Packing Unit |
|----------|------------------|
| 74005000 | 5 litre canister |

Dentoprint® MD pur

Disinfectant for Impressions **Concentrate**

Type of application: Aldehyde-free disinfectant (concentrate) with a broad spectrum of activity including TB for the disinfection of impressions without dimensionally altering effect. **VAH-listed.**

Spectrum of effectiveness: bactericidal (incl. MRSA) acc. EN 13724, EN 14561, VAH; yeasticidal (Candida albicans) acc. EN 13624, EN 14562, VAH; tuberculocidal (M.terrae) acc. EN 14348, EN 14563, partially virucidal (membrane covered viruses e.g. HBV, HIV, HCV) acc. DVV/RKI

Spectrum of effectiveness + application times:

- Bactericidal as per EN 13727, EN 14561 and VAH with high contamination: 2.0 % - 15 min.
- Candida albicans as per EN 13624, EN 14562 and VAH with high contamination: 2.0 % - 15 min.
- Enveloped viruses (e.g. HBV, HCV and HIV) as per DVV/RK with high contamination: 2.0 % - 15 min.
- TbB (M. terrae) as per EN 14348 and EN 14563, low contamination: 4.0 % - 15 min. / 2.0 % - 60 min.

Ingredients: (100 g of the solution contain): 4.40 g Didecyl dimethylammonium chloride, 2.75 g N-(3-Aminopropyl)-N-dodecyl-propan-1.3-diamin.

| REF | Packing Unit |
|----------|-------------------------------------|
| 74101000 | 1 litre metered-dose squeeze bottle |
| 74102000 | 2 litre bottle |



Dentotal® MD liquid

Spittoon bowl disinfectant ready-to-use

Type of application: Dentotal® MD liquid is a special alkaline product for the cleaning, disinfection and care of spittoons in dental chair units. This solution removes deposits of calcium, blood and dye residue from plaque tablets reliably. The application is recommended after each contamination.

Spectrum of effectiveness + application times: Bactericidal and candida albicans as per EN 13697 and DGHM (low contamination): conc. 1 min.; TbB (M. terrae) as per EN 14348 (high contamination): conc. 1 min.

Ingredients: (100 g of the solution contain): 25 g ethanol, 1.0 g bis(3-amino-propyl)dodecylamine

| REF | Packing Unit |
|----------|---------------|
| 75210750 | 750 ml bottle |

Dentosol orange liquid

Ready-to-use solution

For gentle cleaning of surfaces and instruments. For removal of alginate, cement, zinc-eugenol particles, as well as remnants of impression compounds. Made of mixture of natural pressed peel orange.

| REF | Packing Unit |
|----------|---------------|
| 78040500 | 500 ml bottle |



Accessories

| REF | Packing Unit |
|-----------|---|
| 701000902 | Instrument tank with strainer, capacity 4 litre |
| 701000903 | Spray nozzle white for 500 ml and 1,000 ml bottle |
| 701000904 | 1 litre metered-dose squeeze bottle, empty |
| 701000907 | Dosing pump for 500 ml and 1,000 ml Euro-Dispenser bottle |
| 701000909 | Canister wrench |
| 701000911 | Canister cock for 5 + 10 litre canister |
| 701000912 | Dosing pump for 5 + 10 litre canister |



Lab Products

Innovative. Qualitative. Economical.



scannable

The use of gingival masks is indispensable for the creation of aesthetic dental prosthesis of high quality. With gingiva MASK and gingiva MASK 3D, two different materials are available to users: gingiva MASK, the soft version, with low Shore hardness for use with crowns and bridges, and the hard version gingiva MASK 3D, developed specifically for use in implant prosthetics. The 3D variant can not only be grind, but also scanned with-out any additional use of powder. gingiva MASK 3D offers excellent reflection activity for precise data acquisition and digitization in the CAD/CAM/CIM area. Both materials can be processed using direct as well as indirect methods.

gingiva MASK

- Working time: 1 min. 30 sec.
- Total setting time: 7 min.
- Final hardness: approx. Shore A 35
- Colour: gingival colour pink
- Indication: crowns and bridges



REF 32500 2x 50 ml cartridges plus 12 Mixing tips NT, yellow

gingiva MASK 3D

- Working time: 1 min. 30 sec.
- Total setting time: 7 min.
- Final hardness: approx. Shore A 70
- Scannable: yes
- Colour: pink
- Indication: Implant Prosthetic works



REF 32535 2x 50 ml cartridges plus 12 Mixing Tips NT, gelb

kristall PERFECT LAB

Transparent, addition curing silicone for precise detail for the impressions of wax mold models. Thanks to the high transparency the light-hardening materials, such as composite for example, may be polymerized through the use of silicone. Therefore the entire work process is considerably simplified and shortened. kristall PERFECT LAB offers a very high dimension stability, tear strength and a final hardness of Shore A70.

- Working time: 30 sec.
- Total setting time: 1 min. 30 sec.
- Final hardness: approx. Shore A 70
- Colour: clear-transparent
- Aroma: Mint
- Indication: transparent silicone keys

REF 82566 2x 50 ml cartridges plus 12 Mixing tips, green

REF 86566 6x 50 ml cartridges plus 36 Mixing tips, green

gingiva MASK / gingiva MASK 3D Now with new Mixing Technology

- Visible homogeneous mixing results
- 28 % material savings
- Less waste protect the environment



Accessories

REF 82005 Mixing Gun Typ SCS (1:1/2:1)

REF 811511 Mixing tips NT, SCS, Packaging unit with 50 pcs., yellow

REF 811503 Mixing tips Typ SCS, Packaging unit with 50 pcs., green

REF 474196 Intra-Oral-Tips, Packaging unit with 96 pcs., yellow



The high-quality duplicating silicones for cuvette and cuvette-free techniques (double green and double brown) have been further improved in the area of hydrophilicity. This results in better flow and surface contact properties with materials such as plaster and embedding materials, and leads to even smoother model surfaces and thus to better casting results. The increased tensile strength and ultimate elongation offers more reliability in the demoulding of the model and in the reusability. A further crucial advantage of the optimized formulations is the elimination of the waiting time after demoulding. The duplicates can be poured directly after cleaning and drying. All 3 material types are thin-flowing and edge-stable and can be processed with commonly used mixing devices.

double pink

- Final hardness after 60 min.: Shore A 17
- Dosage: 1:1 (suitable for automatic mixing devices)
- Mixing time Vacuum mixer): 40 sec.
- Working time: 3–4 min.
- Curing time: 15 min.
- Demouldable and pourable: directly

REF 70801 2x 1 kg bottle (base + catalyst)

REF 76801 2x 6 kg canister (base + catalyst)

double brown

- Final hardness after 60 min.: Shore A 22
- Dosage: 1:1 (suitable for automatic mixing devices)
- Mixing time Vacuum mixer): 40 sec.
- Working time: 3–4 min.
- Curing time: 10 min.
- Demouldable and pourable: directly

REF 70501 2x 1 kg bottle (base + catalyst)

REF 76501 2x 6 kg canister (base + catalyst)

double green

- Final hardness after 60 min.: Shore A 25
- Dosage: 1:1 (suitable for automatic mixing devices)
- Mixing time Vacuum mixer): 40 sec.
- Working time: approx. 5 min.
- Curing time: 35–45 min.
- Demouldable and pourable: directly

REF 71051 2x 1 kg bottle (base + catalyst)

REF 76051 2x 6 kg canister (base + catalyst)



With gammasil® PERFECT TEC and alphasil® PERFECT TEC, dental technicians have a wide range of technical kneading silicones for a variety of diverse applications at their disposal. The gammasil® PERFECT TEC products are addition-curing silicones with extremely high precision, very high resilience and permanent dimensional stability, even at higher temperatures, e.g. in boiling water. gammasil® PERFECT TEC touch – the all-rounder – is furthermore characterized by particularly soft consistency with concomitantly high final hardness. This makes the material ideal for insulating and protecting teeth in total prosthetics, but also as a silicone key of any kind. If, for example, impressions or registrations are to be digitized, then gammasil® PERFECT TEC 3D is the material of choice. The optical reflective activity allows data capture for digitization in the CAD/CAM/CIM field without any powder. In order to meet the individual needs and indications, the materials are available with various Shore hardnesses and setting times. The 1:1 mixing ratio of cat and base for clean and easy mixing is user-friendly. The condensation-curing silicone alphasil® PERFECT TEC A85/A95 is a cost-effective alternative suitable for almost the same area of application, with high precision, good reproduction fidelity and heat resistance. As catalyst, the separately available activator in paste form for easy dosage and mixing is used.

gammasil® PERFECT TEC 3D

- Working time: 1 min. 20 sec
- Total setting time: 6–7 min.
- Final hardness: Shore A 95
- Scannable: yes
- Colour: yellow ochre, non fading

REF 80035 2x 420 ml jars (base + catalyst)

REF 81035 2x 5 kg bucket (base + catalyst)

gammasil® PERFECT TEC A95

- Working time: 1 min. 20 sec.
- Total setting time: 6–7 min.
- Final hardness: Shore A 95
- Colour: violet-red, non fading
- Aroma: wild berries

REF 80049 2x 420 ml jars (base + catalyst)

REF 81049 2x 5 kg bucket (base + catalyst)

gammasil® PERFECT TEC A85 / A85 rapid

- Working time: 1 min. 20 sec. / 1 min.
- Total setting time: 6–7 min. / 4–5 min.
- Final hardness: Shore A 85
- Colour: violet-red, non fading

gammasil® PERFECT TEC A85

REF 80009 2x 420 ml jars (base + catalyst)

REF 81009 2x 5 kg bucket (base + catalyst)

gammasil® PERFECT TEC A85 rapid

REF 80099 2x 420 ml jars (base + catalyst)

REF 81099 2x 5 kg bucket (base + catalyst)

gammasil® PERFECT TEC touch

- Working time: 1 min. 30 sec.
- Total setting time: 6–7 min.
- Final hardness: Shore A 80
- Colour: violet-blue, non fading

REF 00080380 2x 1.5 kg jars (base + catalyst)

REF 00081080 2x 5 kg bucket (base + catalyst)





► Specification and Indication

| Product type | gammasil® PERFECT TEC 3D | gammasil® PERFECT TEC A95 | gammasil® PERFECT TEC A85 / A85 rapid | gammasil® PERFECT TEC touch | alphasil® PERFECT TEC A95 | alphasil® PERFECT TEC A85 |
|---|--------------------------|---------------------------|---------------------------------------|-----------------------------|---------------------------|---------------------------|
| Specifications | | | | | | |
| Final Hardness | Shore A 95 | Shore A 95 | Shore A 85 | Shore A 80 | Shore A 95 | Shore A 85 |
| Consistency | normal/ solid | normal/ solid | normal/ solid | Extra soft | normal/ solid | normal/ solid |
| Dimension stable | ✓ | ✓ | ✓ | ✓ | up to 7 days | up to 7 days |
| Boil proof | ✓ | ✓ | ✓ | ✓ | heat resistant | heat resistant |
| Scannability | ✓ | - | - | - | - | - |
| Indications | | | | | | |
| Silicone key, Protrusive walls, Fixations | ✓ | ✓ | ✓ | ✓ | ✓ | ✓ |
| Models | ✓ | ✓ | - | - | ✓ | - |
| Insulation/ Protection | - | - | - | ✓ | - | - |
| Digitization | ✓ | - | - | - | - | - |

alphasil® PERFECT TEC A85

- Working time: 1 min. 20 sec.
- Total setting time: 6-7 min.
- Final hardness: Shore A 85
- Colour: blue, non fading

REF 470025T 900 ml jar (approx. 1.6 kg)

REF 471025T 10 kg bucket

alphasil® PERFECT ACTIVATOR TEC

Catalyst for alphasil® PERFECT TEC Lab A85 / A95, gel consistency, for easy and economic dosage.

- Colour: red

REF 470256T 60 ml tube, DBTL-free

alphasil PERFECT TEC A95

- Working time: 1 min. 20 sec.
- Total setting time: 6-7 min.
- Final hardness: Shore A 95
- Colour: violet-red, non fading
- Aroma: wild berries

REF 470064 900 ml jar (approx. 1.6 kg)

REF 471064 10 kg bucket



LC-print tray

Light-curing resin for generative fabrication of individual impression trays and base plates in the 3D printing process using a DLP printer (UV-LED).

- Printer type: DLP printer
- Light wave range/ spectral range: 378 nm to 388 nm
- Layer thickness: 50 µm
- Colour: light blue

REF 0000LC108 bottle, 1.000 g

LC-print cast

Light-curing resin for the generative production of precise cast objects such as crowns, bridges, contouring cast restorations, inlays, onlays, etc. When cured, LC-print cast burns without residue at 480 °C.

- Printer type: DLP printer
- Light wave range: 378 nm to 388 nm
- Layer thickness: 50 µm
- Colour: red



REF 0000LC105 bottle, 1.000 g

LC-print model

Light-curing resin for the generative production of precise models in dental technology, e.g. crown and bridge technique, inlays, onlays, etc. The material has high mechanical properties and enables smooth, scratch-resistant surfaces. Its high opacity provides good visibility of all details.

- Printer type: DLP printer
- Light wave range: 378 nm to 388 nm
- Layer thickness: 50 µm
- Colour: beige

REF 0000LC106 bottle, 1.000 g



LC-print splint

Light-curing resin for the generative production of occlusal splints, drilling templates and X-ray measuring templates. LC-print splint is a clear-transparent material with high bending strength, precision, stability and aesthetics. Especially during orthodontic treatments this is a considerable advantage for dentists and patients. The material is taste-free, colour-stable, biocompatible and will be approved as a Class IIa medical device.

- Printer type: DLP printer
- Light wave range: 378 nm to 388 nm
- Layer thickness: 50 µm
- Colour: transparent

REF 0000LC107 bottle, 1.000 g

Expected to be available from September 2019



LC-model gel

LC-model gel is a completely combustible, light-curing modelling resin based on methacrylate, gel-like in consistency and suitable for a wide variety of dental indications. LC-model gel is characterized by high moulding accuracy, high mechanical strength and **complete combustion**. The material can be polymerized easily up to a layer thickness of 2–3 mm. For polymerisation, any commercially available light curing unit (320 nm–500 nm) is suitable.

- Colour: transparent red

Indications: Modelling of crowns and bridges, inlays, onlays, secondary and primary parts, abutments, individual connections and webs, fixations, splintings, partial dentures etc.

REF 0000LC303 Content: 3x 3 g syringes + 9 application tips



LC-tray

Pre-fabricated light curing tray material for the manufacture of individual impression and function trays as well as bite taking patterns and setup patterns. Stable against torsion, smell and taste neutral, non-sticking.

- Available in pink, blue, natural.

| | | | |
|-----------------|--------|---------|--------|
| Maxilla | pink | natural | blue |
| REF* | LC 011 | LC 021 | LC 031 |
| Mandible | pink | natural | blue |
| REF* | LC 012 | LC 022 | LC 032 |

* each box contains 50 plates

LC-base plate

Light-curing resin preformed in maxillary plates, with excellent shrinkage behaviour, high dimensional stability and low water absorption. The plate thickness is a uniform 1.4 mm, which reduces the work required and saves on material for the prosthesis being produced. The material can be cured using blue light or UVA light.

- Colour: pink
- Indication:** Production of customised bite plates and baseplates for wax-up and for intraoral needle point tracing.

Light-curing tray material / Plate thickness: 1.4 mm / Form: Maxilla / Colour: pink

REF 0000LC018 Box of 50 plates



cold spray

Technical cold spray up to -45°C

- CFC free.

REF 701000060 200 ml aerosol

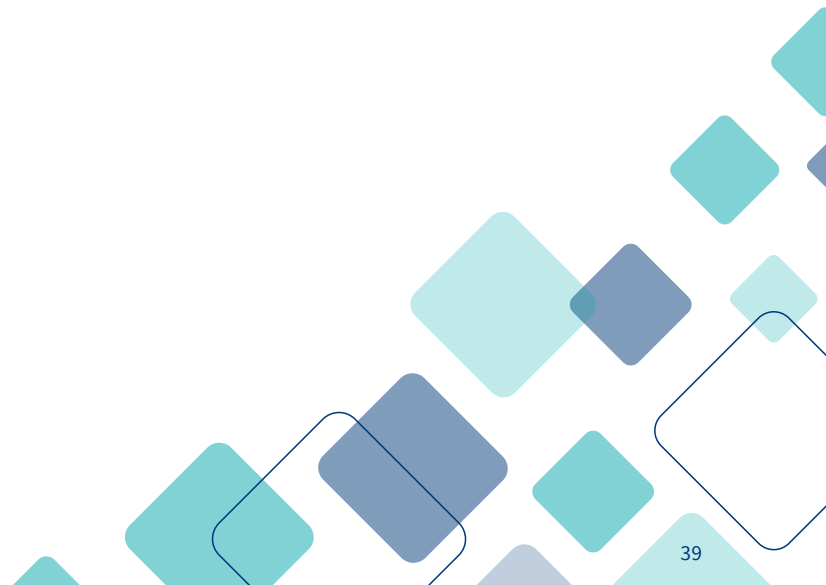

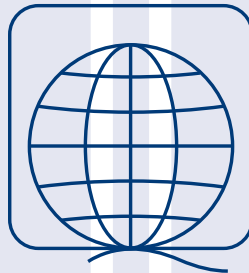

Quality. Made in Lindlar, Germany

For Dentists and Dental Technicians World-Wide.



Müller-Omicron GmbH & Co. KG
Schlosserstraße 1
D-51789 Lindlar / Cologne, Germany

Phone: +49 (0) 2266 47420
Fax: +49 (0) 2266 474223
Mail: info@mueller-omicron.de
www.mueller-omicron.com